

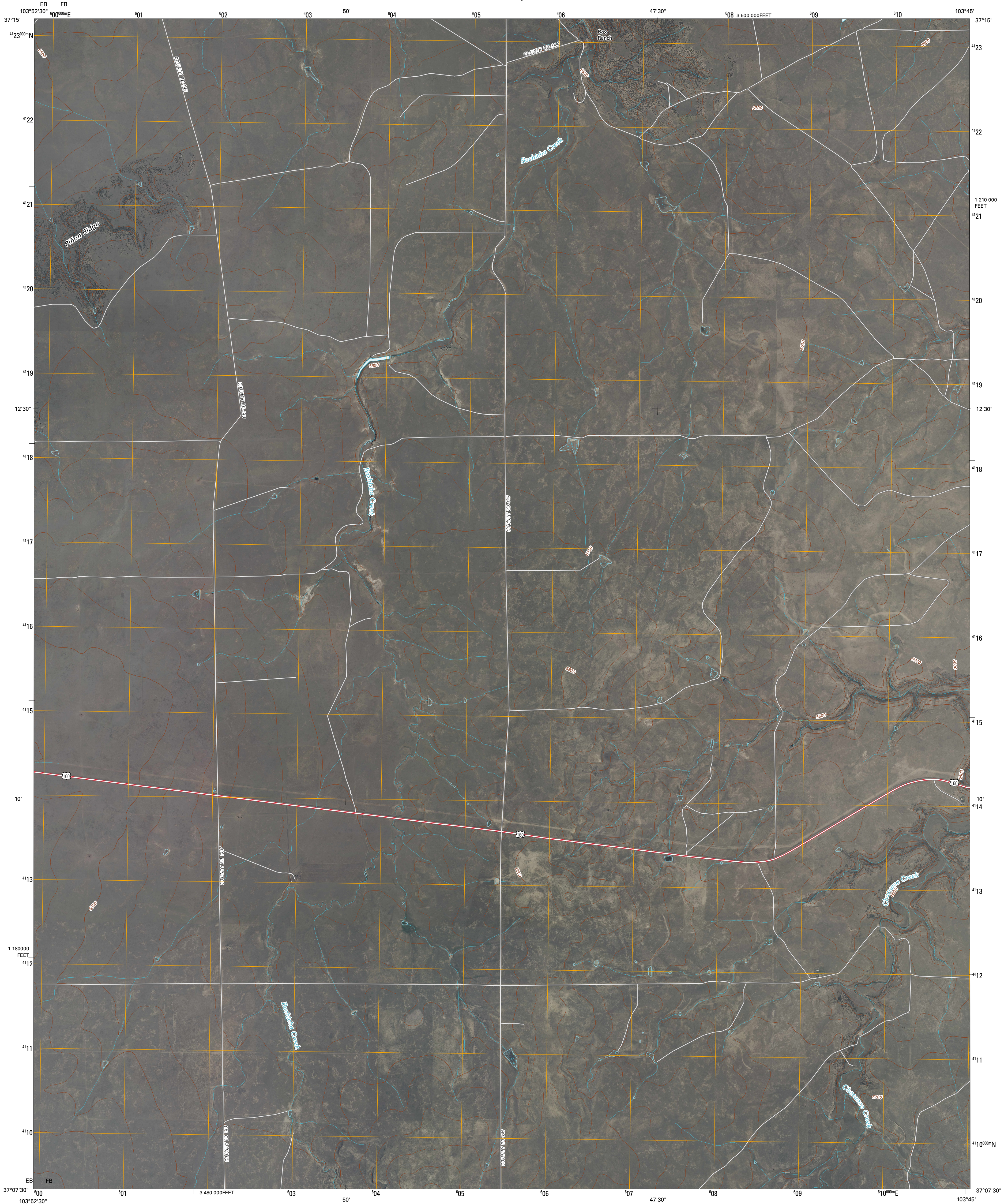

U.S. DEPARTMENT OF THE INTERIOR
U. S. GEOLOGICAL SURVEY



BOX RANCH QUADRANGLE
COLORADO
7.5-MINUTE SERIES



Produced by the United States Geological Survey
North American Datum of 1983 (NAD83)
World Geodetic System of 1984 (WGS84). Projection and
1 000-meter grid: Universal Transverse Mercator, Zone 13S
10 000-foot ticks: Colorado Coordinate System of 1983
(south zone)

Imagery.....NAIP, July 2009 - August 2009
Roads.....©2006-2010 Tele Atlas
Names.....GNIS, 2008
Hydrography.....National Hydrography Dataset, 2009
Contours.....National Elevation Dataset, 2005

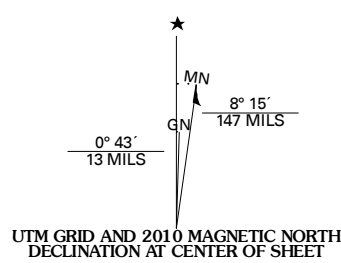

| |
|---|
| U.S. National Grid 70,000m Square ID 1 D EB FB |
| Grid Zone Designation 13S |

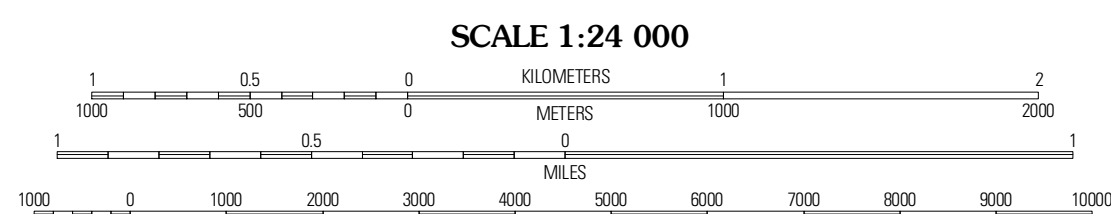

CONTOUR INTERVAL 20 FEET
NORTH AMERICAN VERTICAL DATUM OF 1988

This map was produced to conform with version 0.5.10 of the
draft USGS Standards for 7.5-Minute Quadrangle Maps.
A metadata file associated with this product is draft version 0.5.11

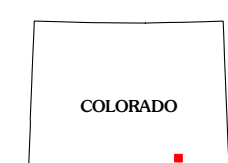

| | | |
|----------------|-------------------|----------------|
| Painted Canyon | Doss Canyon South | Humbler Spring |
| Trueman Canyon | Box Ranch | Miners Peak |
| Branson | Branson SE | Pine Canyon |

ADJOINING 7.5 QUADRANGLES

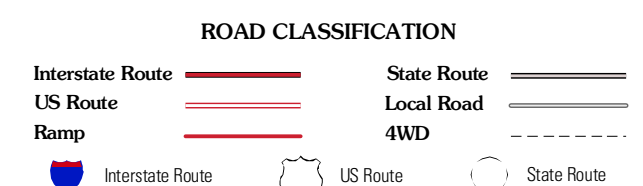

BOX RANCH, CO
2010