

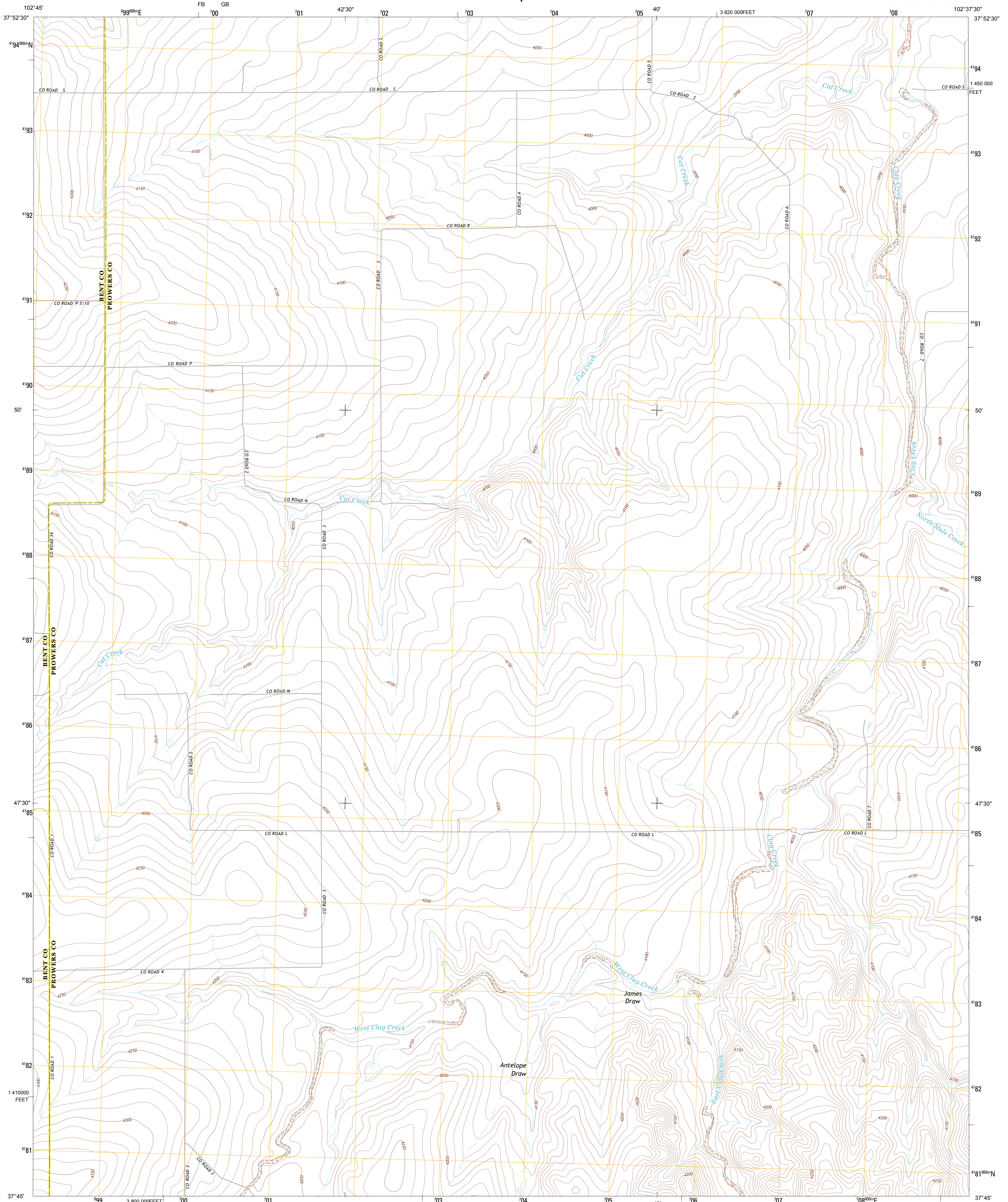

U.S. DEPARTMENT OF THE INTERIOR
U. S. GEOLOGICAL SURVEY



CAT CREEK QUADRANGLE
COLORADO
7.5-MINUTE SERIES



Produced by the United States Geological Survey
North American Datum of 1983 (NAD83)
World Geodetic System of 1984 (WGS84) Projection and
1:000-meter grid: Universal Transverse Mercator, Zone 13S
10 000-foot ticks: Colorado Coordinate System of 1983 (south zone)

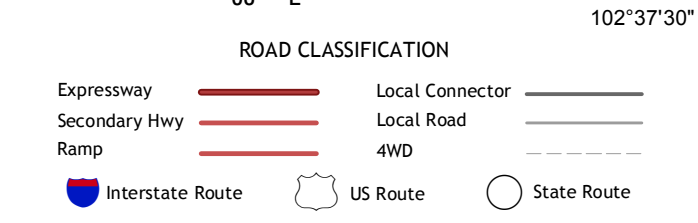
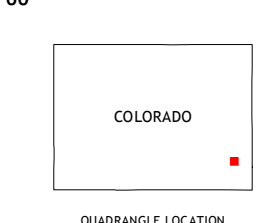
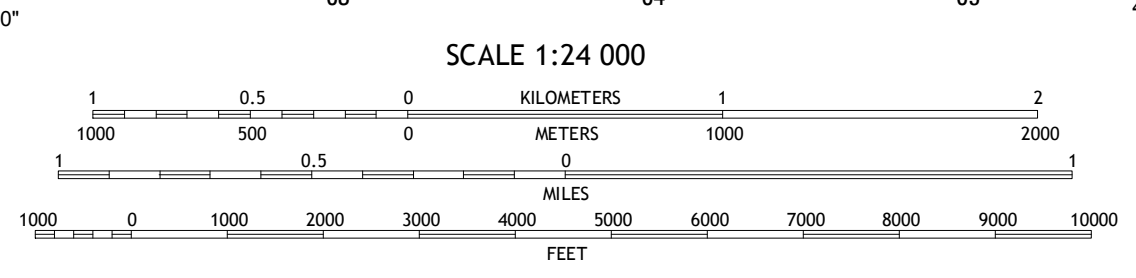
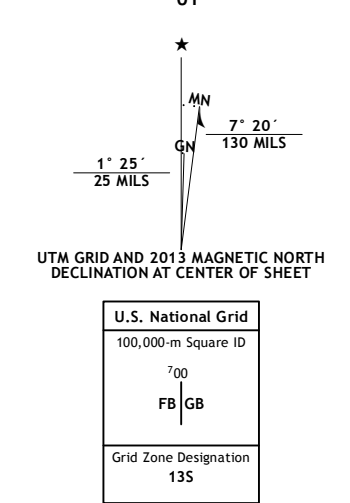

Denny Lake	Cat Creek NW	Cat Creek NE
Dripping Spring	Cat Creek	Gobblers Knob
Floating W Ranch	Hasser Ranch	Two Buttes Reservoir

Imagery.....NAIP, July 2011
Roads.....©2006-2012 TomTom
Names.....©2013 GNS
Hydrography.....National Hydrography Dataset, 2011
Contours.....National Elevation Dataset, 2007
Boundaries, HWM, IBC, USGS, 1972-2012
Public Land Survey System.....BLM, 2011

This map was produced to conform with the
National Geospatial Program US Topo Product Standard, 2011.
A metadata file associated with this product is draft version 0.6.14

CAT CREEK, CO
2013

ADJOINING 7.5 QUADRANGLES