

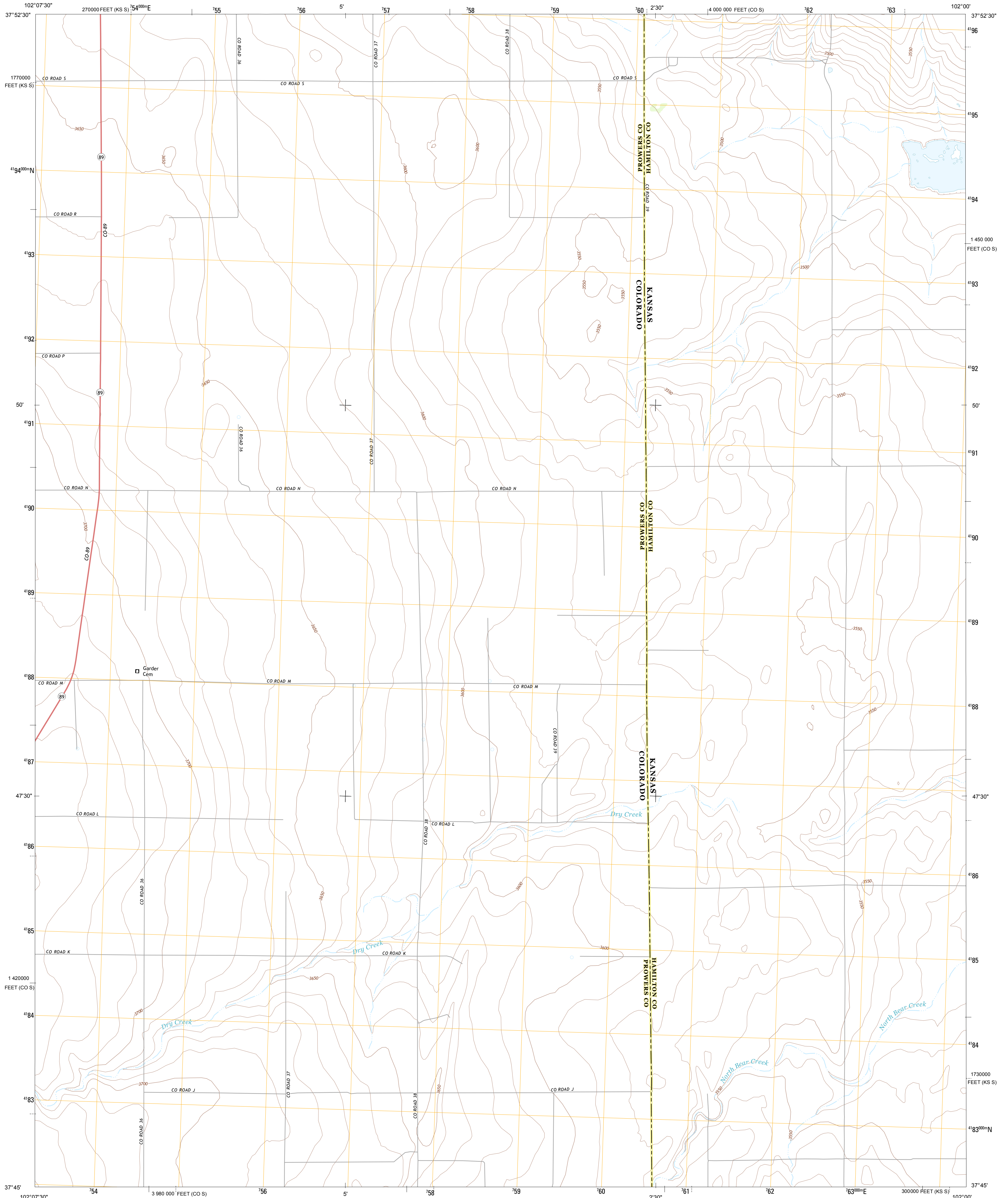

U.S. DEPARTMENT OF THE INTERIOR  
U. S. GEOLOGICAL SURVEY



DURKEE CREEK SE QUADRANGLE  
COLORADO-KANSAS  
7.5-MINUTE SERIES



Produced by the United States Geological Survey  
North American Datum of 1983 (NAD83)  
World Geodetic System of 1984 (WGS84), Projection and  
1 000-meter grid: Universal Transverse Mercator, Zone 13S  
10 000-foot ticks: Colorado Coordinate System of 1983 (south zone), Kansas Coordinate System of 1983 (south zone)

Imagery.....NAIP, July 2011 - June 2012  
Roads.....©2006-2012 TomTom  
Names.....GNIS, 2013  
Hydrography.....National Hydrography Dataset, 2011  
Contours.....National Elevation Dataset, 2003  
Boundaries.....Census, IBW, IBC, USGS, 1972 - 2012  
Public Land Survey System.....BLM, 2011

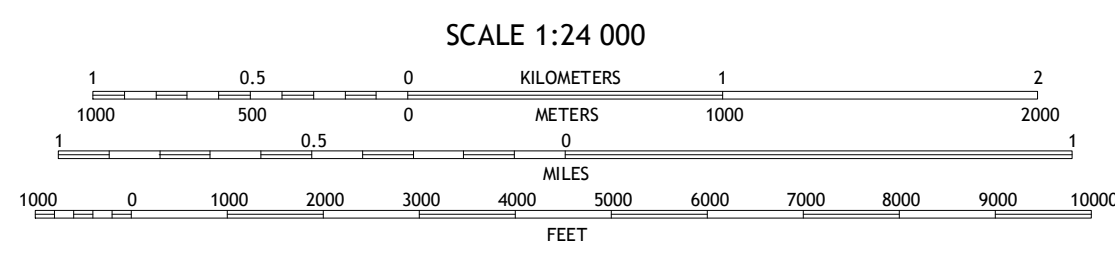
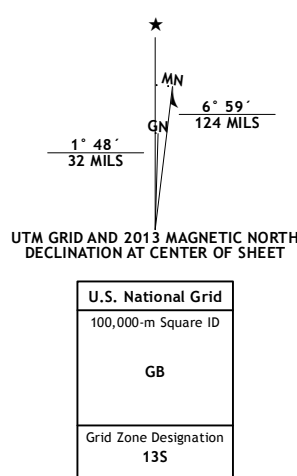

CONTOUR INTERVAL 10 FEET  
NORTH AMERICAN VERTICAL DATUM OF 1988  
This map was produced to conform with the National Geospatial Program US Topo Product Standard, 2011. A metadata file associated with this product is draft version 0.6.14

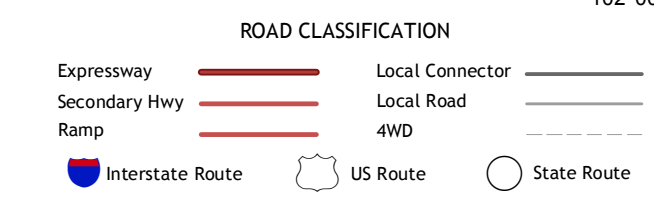
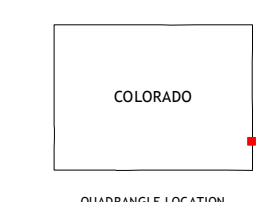

QUADRANGLE LOCATION

Durkee Creek NW	Durkee Creek NE	Syracuse West NW
Two Butte Springs	Durkee Creek SE	Syracuse West SW
Webb	Lycan NE	Johnson NW

DURKEE CREEK SE, CO-KS  
2013

ADJOINING 7.5' QUADRANGLES