

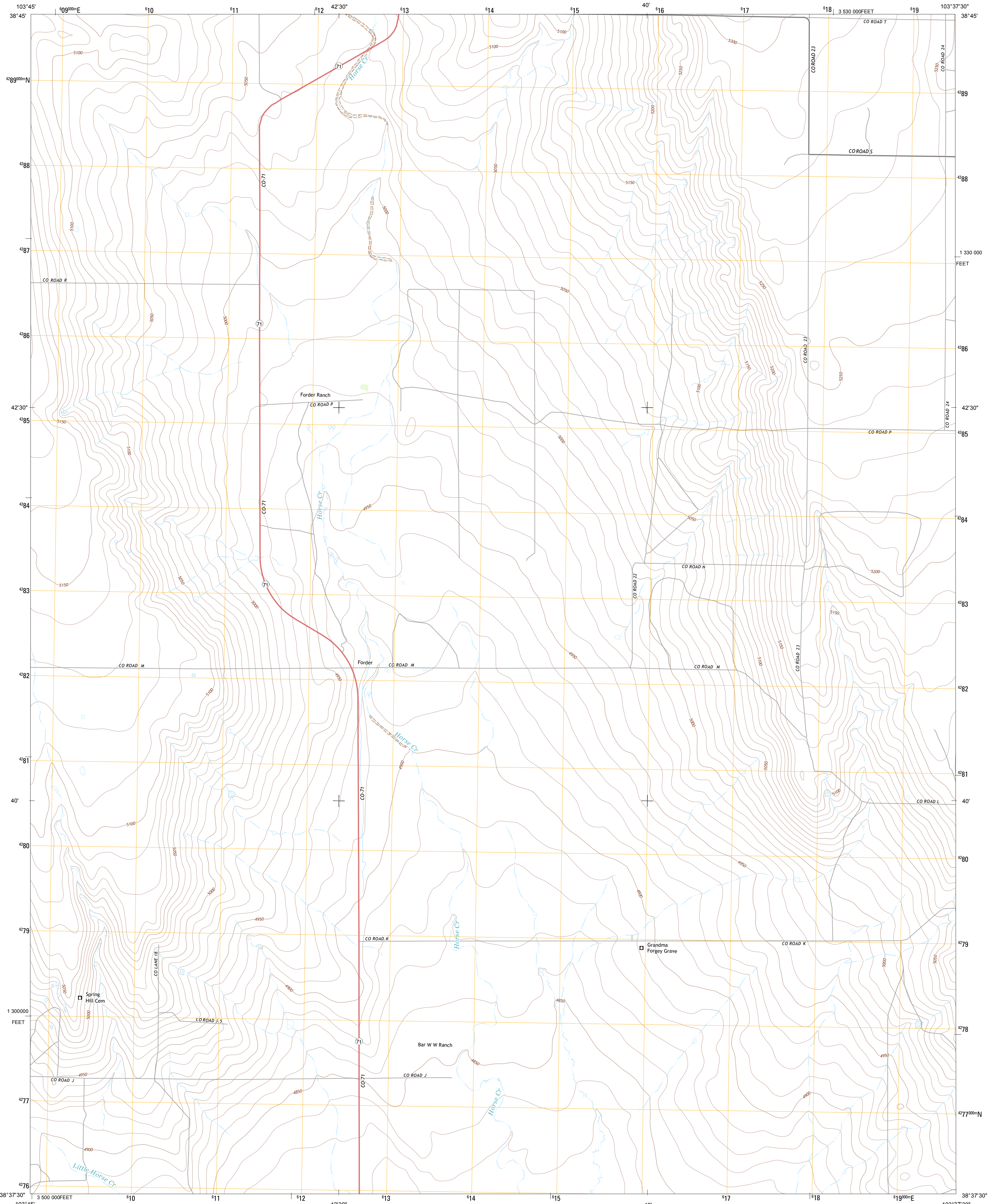

U.S. DEPARTMENT OF THE INTERIOR
U. S. GEOLOGICAL SURVEY



FORDER QUADRANGLE
COLORADO-LINCOLN CO.
7.5-MINUTE SERIES



Produced by the United States Geological Survey
North American Datum of 1983 (NAD83)
World Geodetic System of 1984 (WGS84). Projection and
10 000-foot ticks: Colorado Coordinate System of 1983 (central
zone)

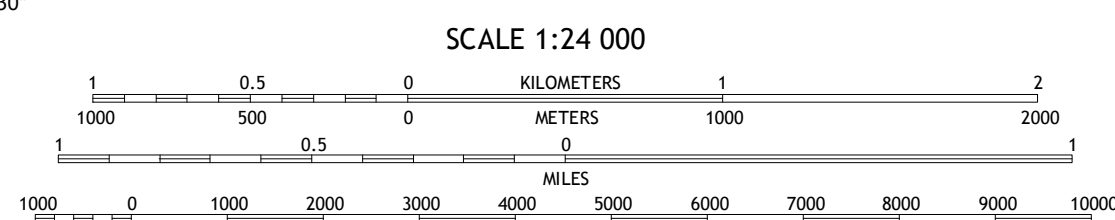
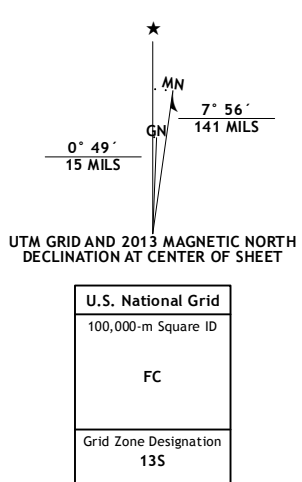

CONTOUR INTERVAL 10 FEET
NORTH AMERICAN VERTICAL DATUM OF 1988
This map was produced to conform with the
National Geospatial Program US Topo Product Standard, 2011.
A metadata file associated with this product is draft version 0.6.14

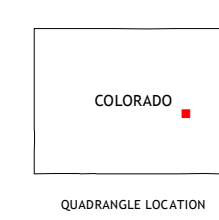

Kutch SE	Punkin Center	Stanley Gulch
Peace Valley	Forder	Karval
Walker Point	Sharp Lake	Netz Springs

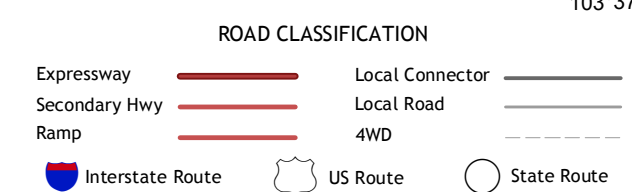

FORDER, CO
2013

ADJOINING 7.5' QUADRANGLES