

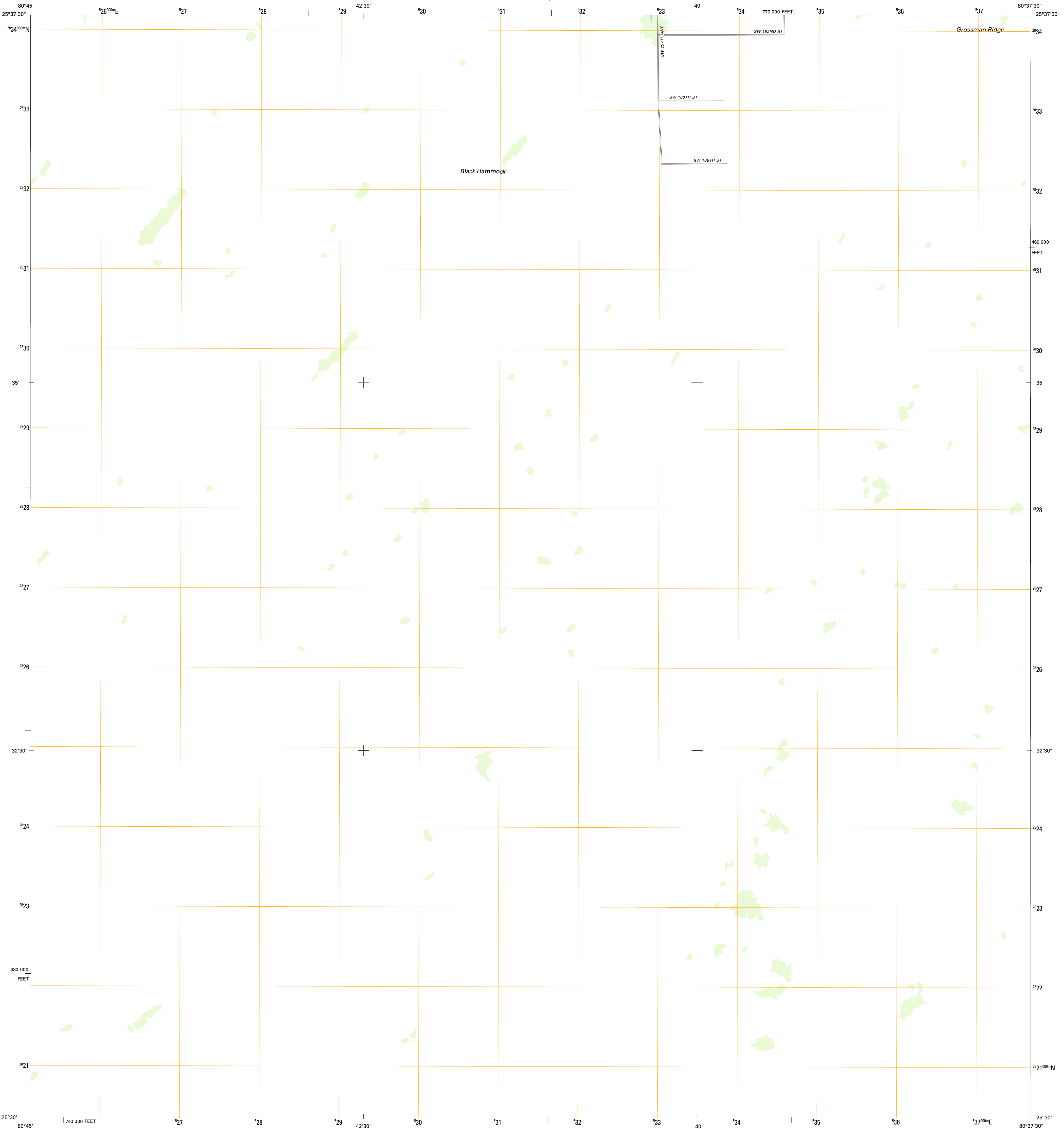

U.S. DEPARTMENT OF THE INTERIOR  
U. S. GEOLOGICAL SURVEY



BLACK HAMMOCK QUADRANGLE  
FLORIDA-MIAMI-DADE CO.  
7.5-MINUTE SERIES



Produced by the United States Geological Survey  
North American Datum of 1983 (NAD83)  
World Geodetic System of 1984 (WGS84). Projection and  
1 000-meter grid: Universal Transverse Mercator, Zone 17R  
10 000-foot ticks: Florida Coordinate System of 1983 (east  
zone)

Imagery:.....NAIP, April 2010  
Roads:.....©2006-2011 TomTom  
Names:.....GNIS, 2011  
Hydrography:.....National Hydrography Dataset, 2010  
Contours:.....Not Available  
Boundaries:.....Census, IBWC, IBC, USGS, 1972 - 2010

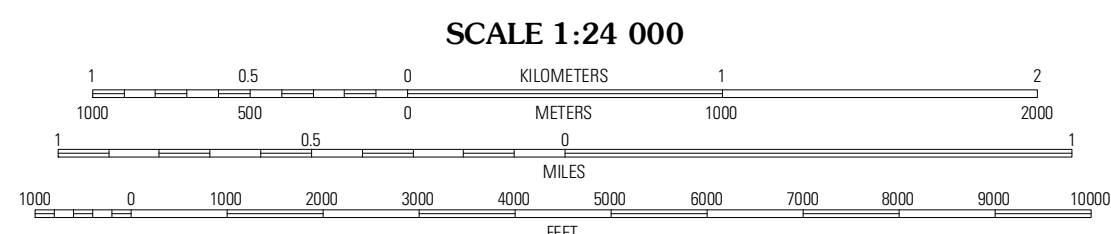
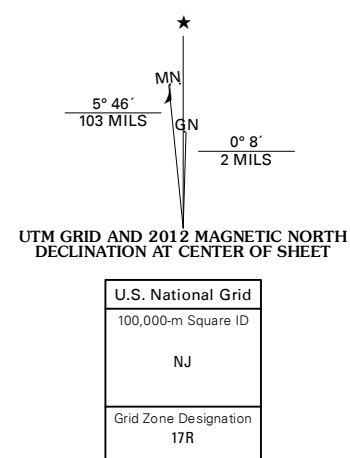

CONTOURS NOT PRESENT BECAUSE AVAILABLE ELEVATION  
DATA DO NOT MEET ACCURACY REQUIREMENTS

This map was produced to conform with the  
National Geospatial Program US Topo Product Standard, 2011.  
A metadata file associated with this product is draft version 0.6.3



QUADRANGLE LOCATION

Shark Valley Lookout Tower	Chelka Island	South of Cooperstown
Panther Mound	Black Hammock	Grossman Hammock
7-11/2 Lookout Tower	Long Pine Key	Royal Palm Ranger Station

ADJOINING 7.5' QUADRANGLES

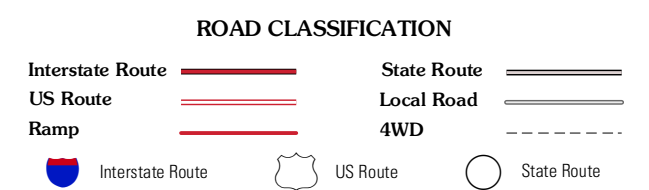

BLACK HAMMOCK, FL  
2012