

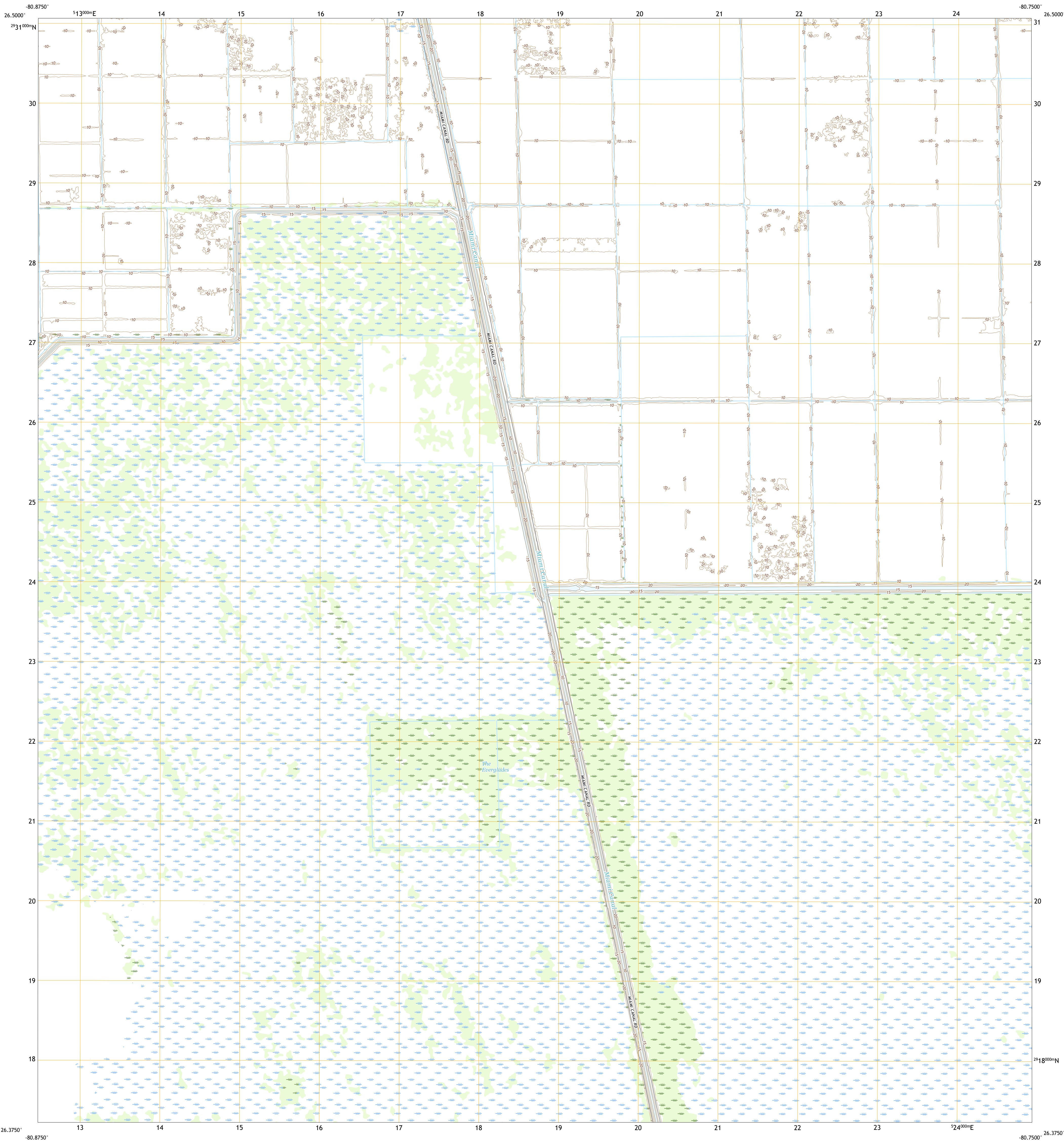

U.S. DEPARTMENT OF THE INTERIOR  
U.S. GEOLOGICAL SURVEY



EAST OF LITTLE CYPRESS SWAMP QUADRANGLE  
FLORIDA - PALM BEACH COUNTY  
7.5-MINUTE SERIES



Produced by the United States Geological Survey

North American Datum of 1983 (NAD83)  
World Geodetic System of 1984 (WGS84) Projection and  
1 000-meter grid/Universal Transverse Mercator, Zone 17R  
This map is not a legal document. Boundaries may be  
generalized for this map scale. Private lands within government  
reservations may not be shown. Obtain permission before  
entering private lands.

Imagery.....	U.S. NAIP, November 2019 - December 2019
Roads.....	U.S. Census Bureau, 2016
Names.....	GNIS, 1990 - 2019
Hydrography.....	National Hydrography Dataset, 2005 - 2019
Contours.....	National Elevation Dataset, 2018
Boundaries.....	Multiple sources: see metadata file 2018 - 2019
Public Land Survey System.....	BLM, 2020
Wetlands.....	National Wetlands Inventory 2010

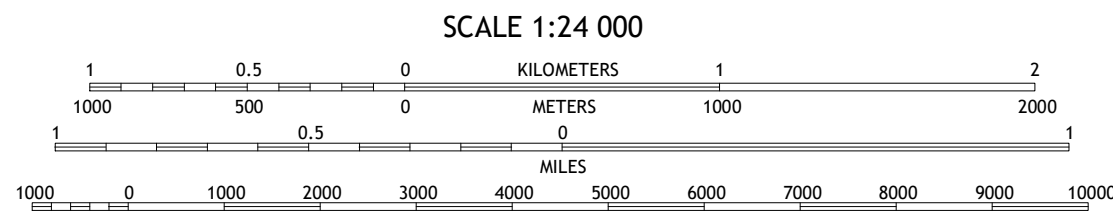
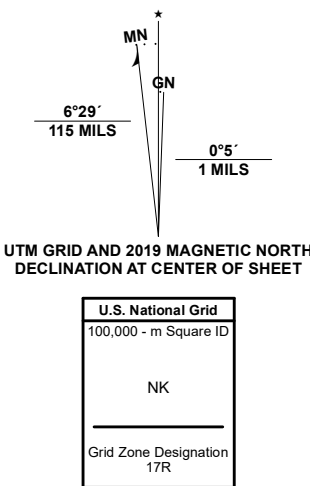

CONTOUR INTERVAL 5 FEET  
NORTH AMERICAN VERTICAL DATUM OF 1988  
This map was produced to conform with the  
National Geospatial Program US Topo Product Standard.



1	2	3
4	5	6
7	8	

ADJOINING QUADRANGLES

- 1 Lake Harbor SW
- 2 Lake Harbor SE
- 3 Okeelanta
- 4 Little Cypress Swamp
- 5 South of Okeelanta
- 6 Goddard Strand
- 7 North of Lone Palm Head
- 8 West of Deem City

ROAD CLASSIFICATION		
Expressway	Local Connector	
Secondary Hwy	Local Road	
Ramp	4WD	
Interstate Route	US Route	State Route

EAST OF LITTLE CYPRESS SWAMP, FL

2021

