

Produced by the United States Geological Survey

North American Datum of 1983 (NAD83) World Geodetic System of 1984 (WGS84). Projection and 1 000-meter grid: Universal Transverse Mercator, Zone 17S. This map is not a legal document. Boundaries may be generalized for this map scale. Private lands within government reservations may not be shown. Obtain permission before entering private lands.

Imagery: N.A.I.P., September 2017 - December 2017
Roads: U.S. Census Bureau, 2016
Roads within US Forest Service Lands: Data with limited Forest Service updates, 2013 - 2016
Names: GNS, 1979 - 2022
Hydrography: National Hydrography Dataset, 2001 - 2022
Contours: National Elevation Dataset, 2022
Boundaries: Multiple sources; see metadata file 2017 - 2022
Wetlands: FWS National Wetlands Inventory Not Available

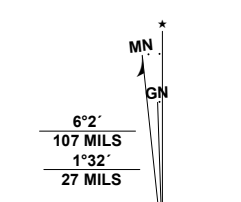

UTM GRID AND 2023 MAGNETIC NORTH DECLINATION AT CENTER OF SHEET

U.S. National Grid
100,000 - m Square ID
KUJ
Grid Zone Designation
17S

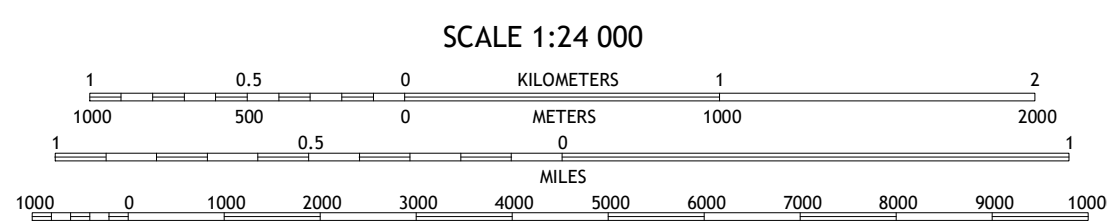

CONTOUR INTERVAL 40 FEET
NORTH AMERICAN VERTICAL DATUM OF 1988
This map was produced to conform with the National Geospatial Program US Topo Product Standard.



ADJOINING QUADRANGLES

1	2	3
4	5	6
7	8	

1 Hawessee
2 Macedonia
3 Hightower Bald
4 Jacks Gap
5 Lake Burton
6 Cowrock
7 Helen
8 Clarksville NE

ROAD CLASSIFICATION

Expressway	Local Connector
Secondary Hwy	Local Road
Ramp	4WD
Interstate Route	State Route
FS Primary Route	FS Passenger Route
	FS High Clearance Route

Check with local Forest Service unit for current travel conditions and restrictions.

TRAY MOUNTAIN, GA
2024

