

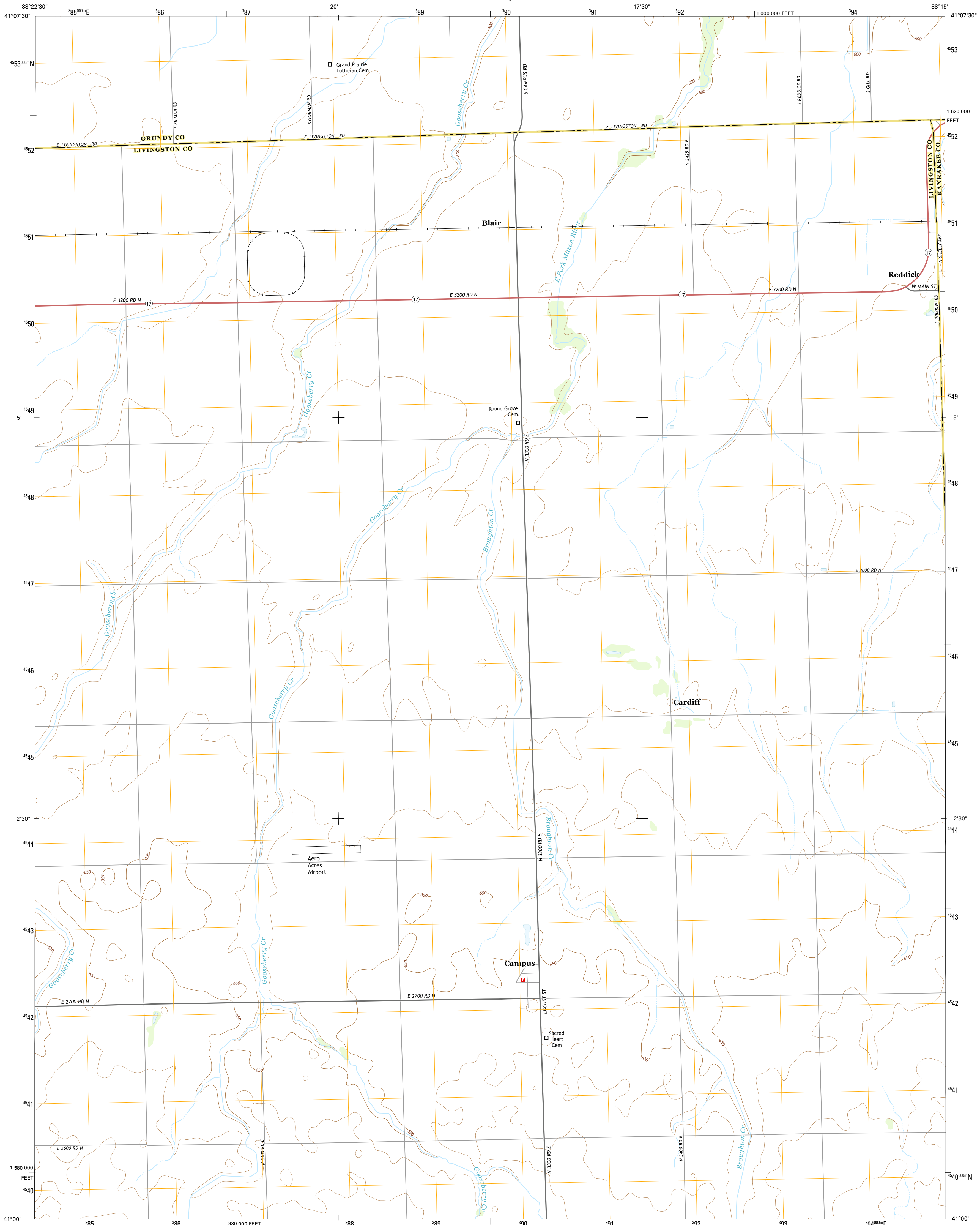

U.S. DEPARTMENT OF THE INTERIOR
U.S. GEOLOGICAL SURVEY



CAMPUS QUADRANGLE
ILLINOIS
7.5-MINUTE SERIES



Produced by the United States Geological Survey
North American Datum of 1983 (NAD83)
World Geodetic System of 1984 (WGS84). Projection and
1 000-meter grid: Universal Transverse Mercator, Zone 16T
10 000-foot ticks: Illinois Coordinate System of 1983 (east zone)
This map is not a legal document. Boundaries may be
generalized for this map scale. Private lands within government
reservations may not be shown. Obtain permission before
entering private lands.

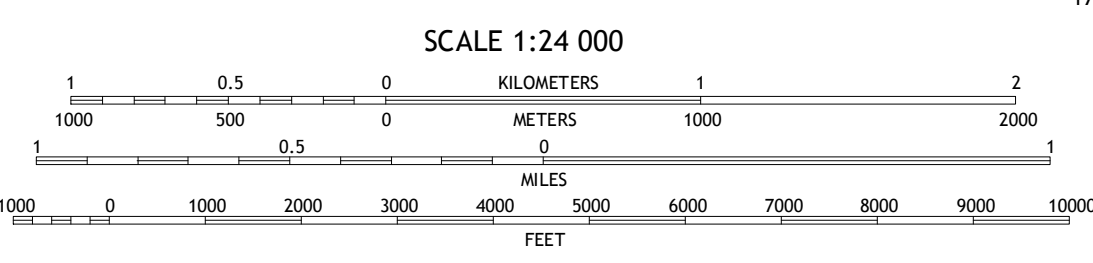
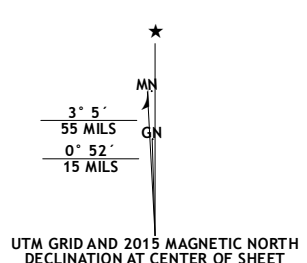

ROAD CLASSIFICATION

Expressway	Local Connector
Secondary Hwy	Local Road
Ramp	4WD
Interstate Route	US Route
	State Route

Imagery	NAIP, June 2014
Roads	HERE, ©2013 - 2014
Names	GNIS, 2015
Hydrography	National Hydrography Dataset, 2014
Contours	National Elevation Dataset, 2008
Boundaries	Multiple sources; see metadata file 1972 - 2015

U.S. National Grid	100,000-m Square ID
CL	
Grid Zone Designation	16T

CONTOUR INTERVAL 10 FEET
NORTH AMERICAN VERTICAL DATUM OF 1988
This map was produced to conform with the
National Geospatial Program US Topo Product Standard, 2011.
A metadata file associated with this product is draft version 0.6.18

1	2	3	1 Mason
2	3	4	2 Gardner
3	4	5	3 Essex
4	5	6	4 Dwight
5	6	7	5 Buckingham
6	7	8	6 Saunemin
7	8		7 Cullum
8			8 Cabery

CAMPUS, IL
2015

