

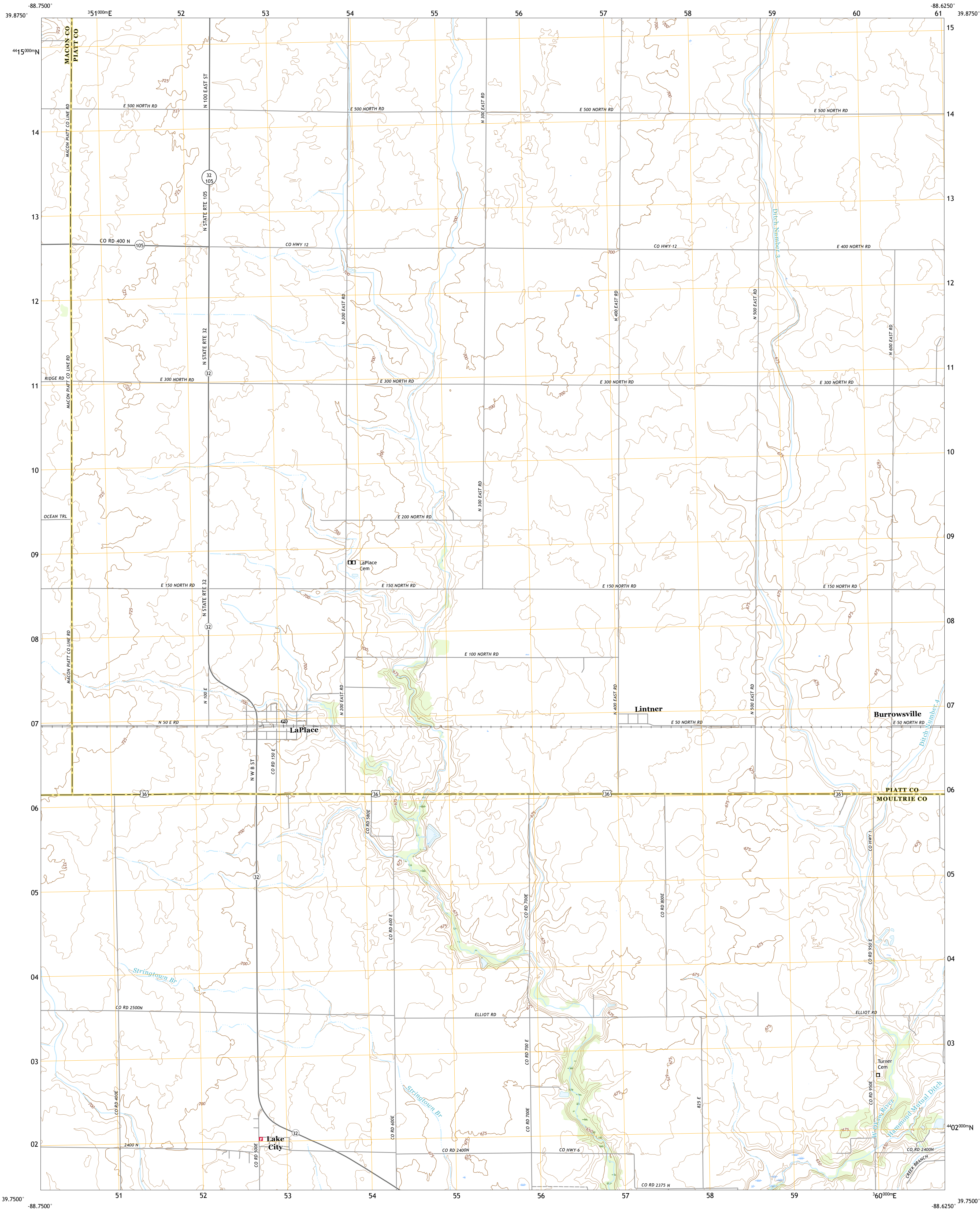

U.S. DEPARTMENT OF THE INTERIOR
U.S. GEOLOGICAL SURVEY



LA PLACE QUADRANGLE
ILLINOIS
7.5-MINUTE SERIES



Produced by the United States Geological Survey

North American Datum of 1983 (NAD83)
World Geodetic System of 1984 (WGS84) - Projection and
1 000-meter grid/Universal Transverse Mercator, Zone 16S
This map is not a legal document. Boundaries may be
generalized for this map scale. Private lands within government
reservations may not be shown. Obtain permission before
entering private lands.

Imagery.....NAIP, August 2015 - October 2015
Roads.....U.S. Census Bureau, 2017
Names.....GNIS, 1980 - 2017
Hydrography.....National Hydrography Dataset, 2004 - 2011
Contours.....National Elevation Dataset, 2017
Boundaries.....Multiple sources: see metadata file, 2014 - 2016
Public Land Survey System.....BLM, 2017
Wetlands.....FWS National Wetlands Inventory 1984 - 1985

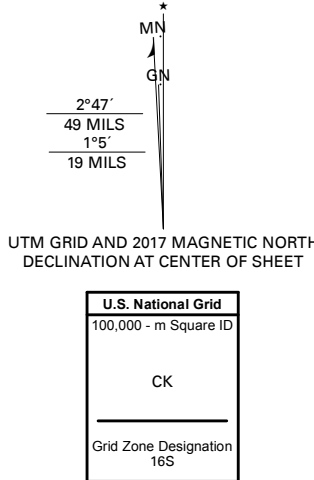

CONTOUR INTERVAL 5 FEET
NORTH AMERICAN VERTICAL DATUM OF 1988
This map was produced to conform with the
National Geospatial Program US Topo Product Standard, 2011.
A metadata file associated with this product is draft version 0.6.18



1	2	3
4	5	6
7	8	9

1 Argenta
2 Cerro Gordo
3 Bemont
4 Long Creek
5 Hammond
6 Dalton City
7 Lovington
8 Cadwell

ROAD CLASSIFICATION		
Expressway	Local Connector	
Secondary Hwy	Local Road	
Ramp	4WD	
Interstate Route	US Route	State Route

LA PLACE, IL
2018

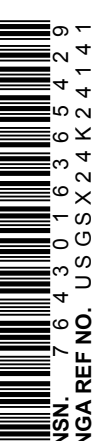

NSN 7540-01-603-0163 65429
NSA REF NO. USGSX24K24141