

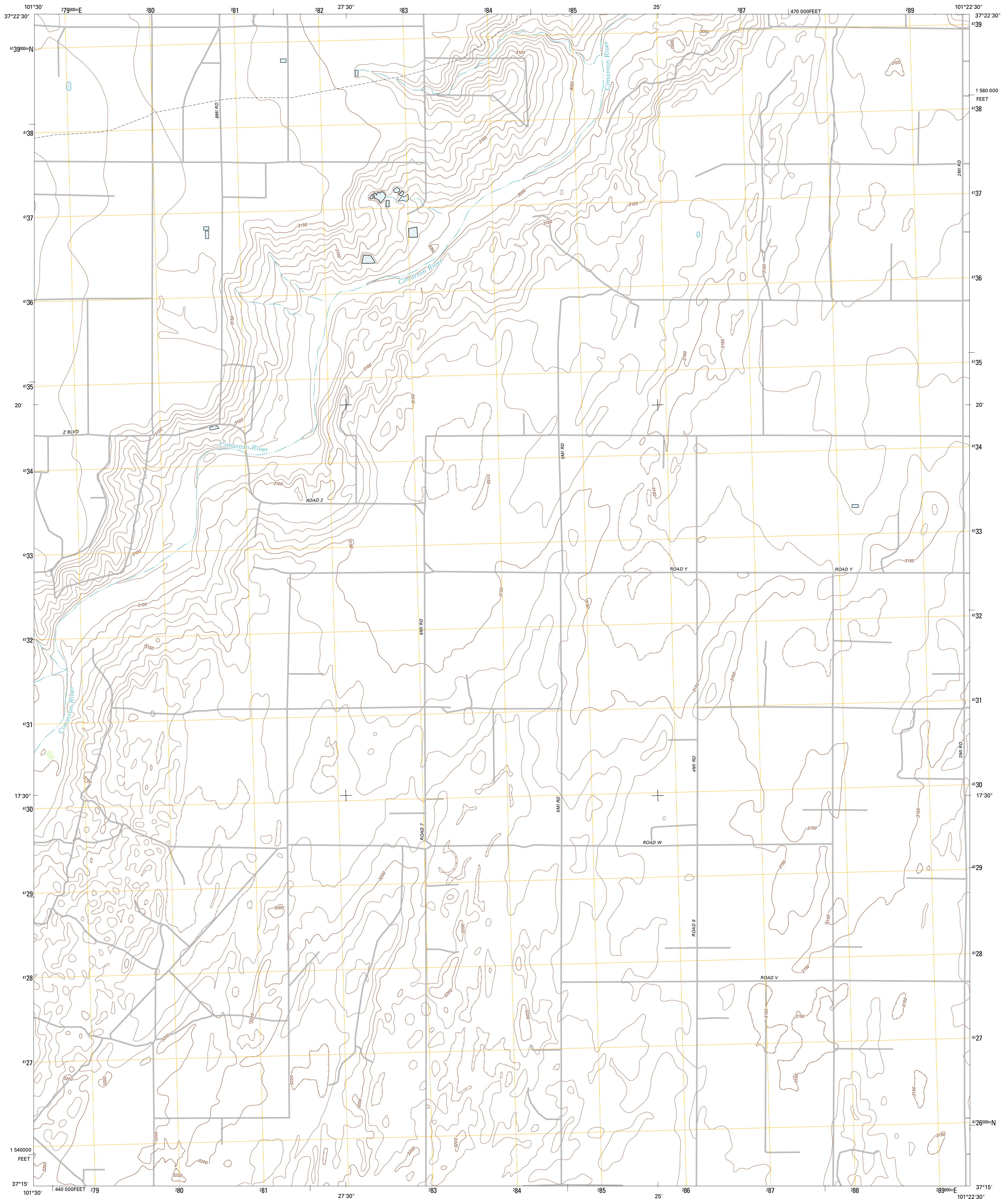

U.S. DEPARTMENT OF THE INTERIOR  
U. S. GEOLOGICAL SURVEY



WAGON BED SPRING SW QUADRANGLE  
KANSAS-STEVENS CO.  
7.5-MINUTE SERIES



Produced by the United States Geological Survey  
North American Datum of 1983 (NAD83)  
Roads: ©2006-2011 TomTom  
Names: ©GNIS, 2012  
Hydrography: National Hydrography Dataset, 2010  
Contours: National Elevation Dataset, 2006  
Boundaries: Census, BWC, IBC, USGS, 1972 - 2012

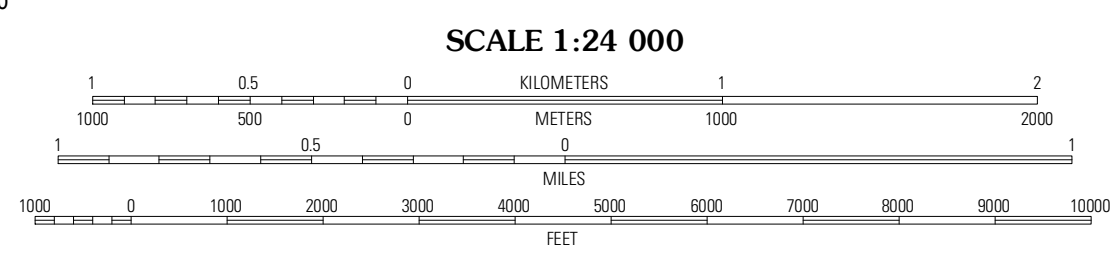
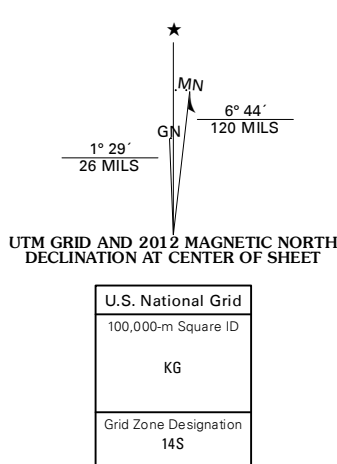

CONTOUR INTERVAL 10 FEET  
NORTH AMERICAN VERTICAL DATUM OF 1988  
This map was produced to conform with the National Geospatial Program US Topo Product Standard, 2011. A metadata file associated with this product is draft version 0.6.4

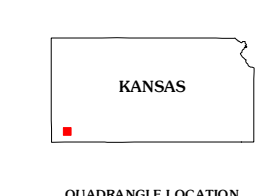

QUADRANGLE LOCATION

Shore Airport NE	Wagon Bed Spring NW	Wagon Bed Spring
Shore Airport SE	Wagon Bed Spring SW	Wagon Bed Spring SE
Rolla NE	Fayette	Hugoton

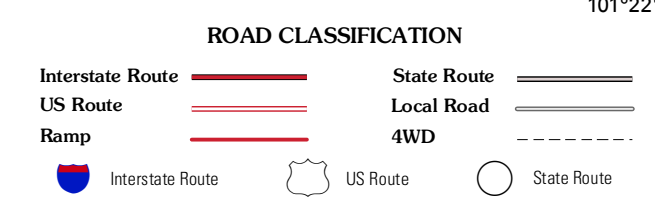

WAGON BED SPRING SW, KS  
2012

ADJOINING 7.5 QUADRANGLES