

Produced by the United States Geological Survey

North American Datum of 1983 (NAD83)
World Geodetic System of 1984 (WGS84), Projection and
1 000-meter grid/Universal Transverse Mercator, Zone 16T
This map is not a legal document. Boundaries may be
generalized for this map scale. Private lands within government
reservations may not be shown. Obtain permission before
entering private lands.

Imagery.....NAIP, August 2016 - October 2016
Roads.....U.S. Census Bureau, 2016
Names.....GNS, 1980 - 2019
Hydrography.....National Hydrography Dataset, 1989 - 2018
Contours.....National Elevation Dataset, 2017
Boundaries.....Multiple sources; see metadata file, 2017 - 2018
Public Land Survey System.....BLM, 2018
Wetlands.....FWS National Wetlands Inventory, 2005

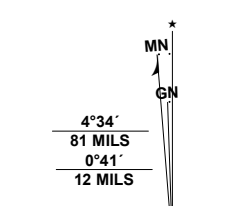

UTM GRID AND 2019 MAGNETIC NORTH
DECLINATION AT CENTER OF SHEET

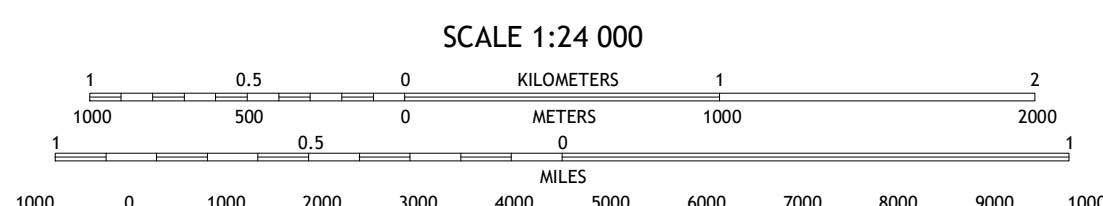
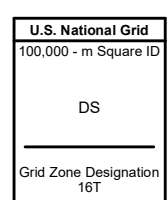

SCALE 1:24 000

CONTOUR INTERVAL 20 FEET
NORTH AMERICAN DATUM OF 1988

This map was produced to conform with the
National Geospatial Program US Topo Product Standard, 2011.
A metadata file associated with this product is draft version 0.6.18



QUADRANGLE LOCATION

1	2	3
4	5	6
7	8	

- 1 Michigamme
- 2 Champion
- 3 Diorite
- 4 Witch Lake NE
- 5 Greenwood
- 6 Witch Lake
- 7 Republic SW
- 8 Chabeneau Lake

ADJOINING QUADRANGLES

ROAD CLASSIFICATION	
	Expressway
	Secondary Hwy
	Ramp
	Interstate Route
	US Route
	State Route
	Local Connector
	Local Road
	4WD

REPUBLIC, MI
2019



USGS REF. NO. U.S.G.S. X.2.4.K.3.7.6.4.0