

**Produced by the United States Geological Survey**  
North American Datum of 1983 (NAD83)  
World Geodetic System of 1984 (WGS84), Projection and  
1 000-meter grid; Universal Transverse Mercator, Zone 14U  
This map is not a legal document. Boundaries may be  
generalized for this map scale. Private lands within government  
reservations may not be shown. Obtain permission before  
entering private lands.

Imagery.....NAIP, July 2017 - November 2017  
Roads.....U.S. Census Bureau, 2016  
Names.....GNIS, 1980 - 2009  
Hydrography.....National Hydrography Dataset, 2004 - 2018  
Contours.....National Elevation Dataset, 2012  
Boundaries.....Multiple sources; see metadata file, 2019 - 2021  
Public Land Survey System.....BLM, 2020  
Wetlands.....FWS National Wetlands Inventory 1982 - 1983

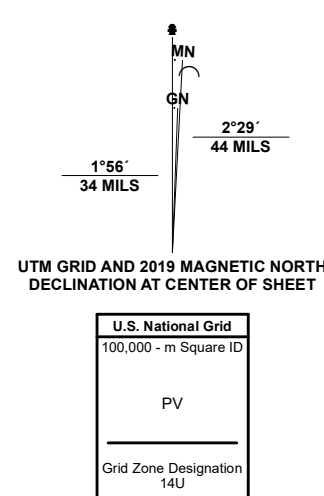

CONTOUR INTERVAL 5 FEET  
NORTH AMERICAN VERTICAL DATUM OF 1988  
This map was produced to conform with the  
National Geospatial Program US Topo Product Standard.



1	2	3
4	5	6
7	8	

ADJOINING QUADRANGLES

- 1 Skull Lake NE OE N
- 2 Caribou OE N
- 3 Caribou NE OE N
- 4 Skull Lake NE
- 5 Caribou NE
- 6 Skull Lake SE
- 7 Junberry Ridge
- 8 Leo

ROAD CLASSIFICATION	
	Expressway
	Secondary Hwy
	Ramp
	Interstate Route
	US Route
	Local Connector
	Local Road
	4WD
	State Route

