

Produced by the United States Geological Survey

North American Datum of 1983 (NAD83)
World Geodetic System of 1984 (WGS84), Projection and
1 000-meter grid; Universal Transverse Mercator, Zone 14U
This map is not a legal document. Boundaries may be
generalized for this map scale. Private lands within government
reservations may not be shown. Obtain permission before
entering private lands.

Imagery.....NAIP, July 2017 - November 2017
Roads.....U.S. Census Bureau, 2016
Names.....GNIS, 1980
Hydrography.....National Hydrography Dataset, 2004 - 2018
Contours.....National Elevation Dataset, 2012
Boundaries.....Multiple sources; see metadata file 2017 - 2018
Public Land Survey System.....BLM, 2017
Wetlands.....FWS National Wetlands Inventory 1982 - 1983

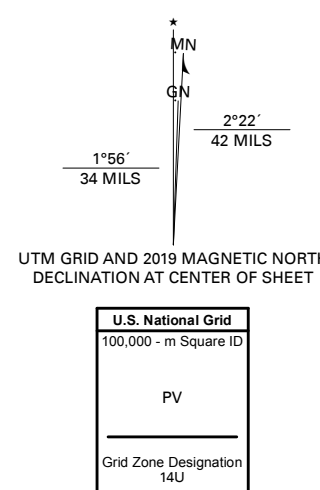

CONTOUR INTERVAL 5 FEET
NORTH AMERICAN VERTICAL DATUM OF 1988
This map was produced to conform with the
National Geospatial Program US Topo Product Standard, 2011.
A metadata file associated with this product is draft version 0.6.18



1	2	3
4	5	6
7	8	

ADJOINING QUADRANGLES

- 1 Skull Lake NE
- 2 Caribou NE
- 3 Caribou NE
- 4 Skull Lake SE
- 5 Leo
- 6 Halma
- 7 Pelan
- 8 Pelan NE

