



U.S. DEPARTMENT OF THE INTERIOR
U. S. GEOLOGICAL SURVEY



ARAPAHOE QUADRANGLE
NORTH CAROLINA
7.5-MINUTE SERIES



Produced by the United States Geological Survey
North American Datum of 1983 (NAD83)
Roads: ©2006-2010 Tele Atlas
Names: National Hydrography Dataset, 2008
Contours: National Elevation Dataset, 2008

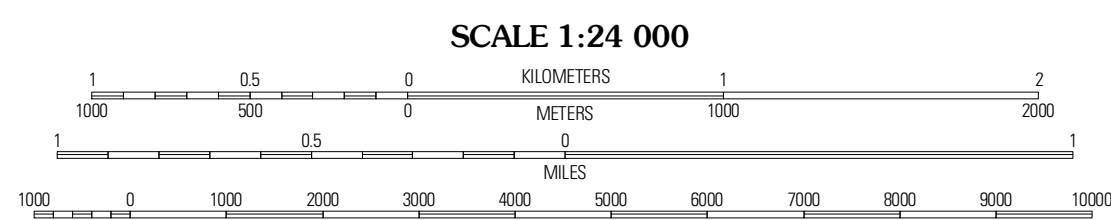
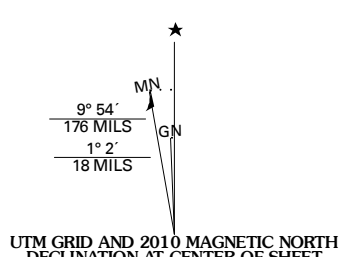

CONTOUR INTERVAL 5 FEET
NORTH AMERICAN VERTICAL DATUM OF 1988

This map was produced to conform with version 0.5.10 of the draft USGS Standards for 7.5-Minute Quadrangle Maps. A metadata file associated with this product is draft version 0.5.11



QUADRANGLE LOCATION		
Reelsboro	Bayboro	Vandemere
Upper Broad Creek	Arapahoe	Oriental
Havelock	Cherry Point	Merrimon

ADJOINING 7.5 QUADRANGLES

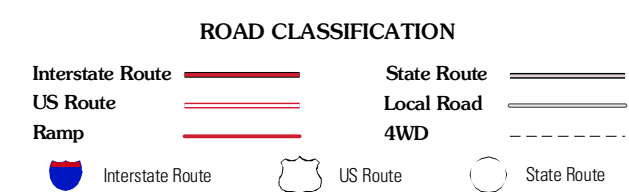

ARAPAHOE, NC
2010