

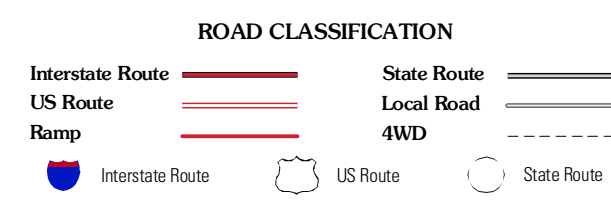

Produced by the United States Geological Survey
North American Datum of 1983 (NAD83)
World Geodetic System of 1984 (WGS84). Projection and
1 000-meter grid: Universal Transverse Mercator, Zone 18S
10 000-foot ticks: North Carolina Coordinate System of 1983

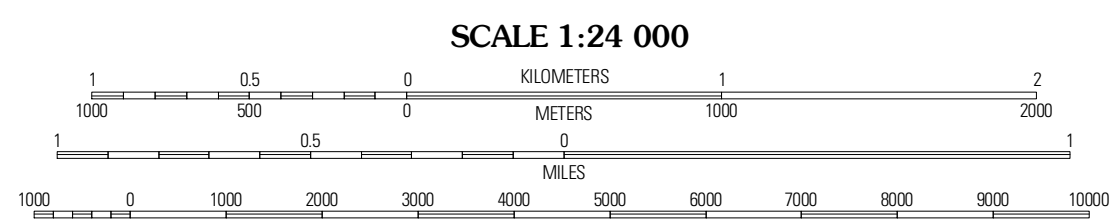
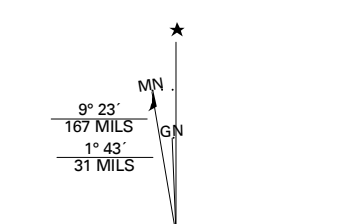

QUADRANGLE LOCATION

Castalia	Red Oak	Drake
Spring Hope	Nashville	Rocky Mount
Bulley	Whitwell Crossroads	Elm City

ADJOINING 7.5' QUADRANGLES

Imagery.....NAIP, June 2008
Roads.....2006-2010 T4e Atlas
Names.....GNIS, 2008
Hydrography.....National Hydrography Dataset, 2008
Contours.....National Elevation Dataset, 2008

U.S. National Grid 100,000m Square ID
TE
Grid Zone Designation 18S

CONTOUR INTERVAL 10 FEET
NORTH AMERICAN VERTICAL DATUM OF 1988
This map was produced to conform with version 0.5.10 of the
draft USGS Standards for 7.5-Minute Quadrangle Maps.
A metadata file associated with this product is draft version 0.5.11

NASHVILLE, NC
2010