

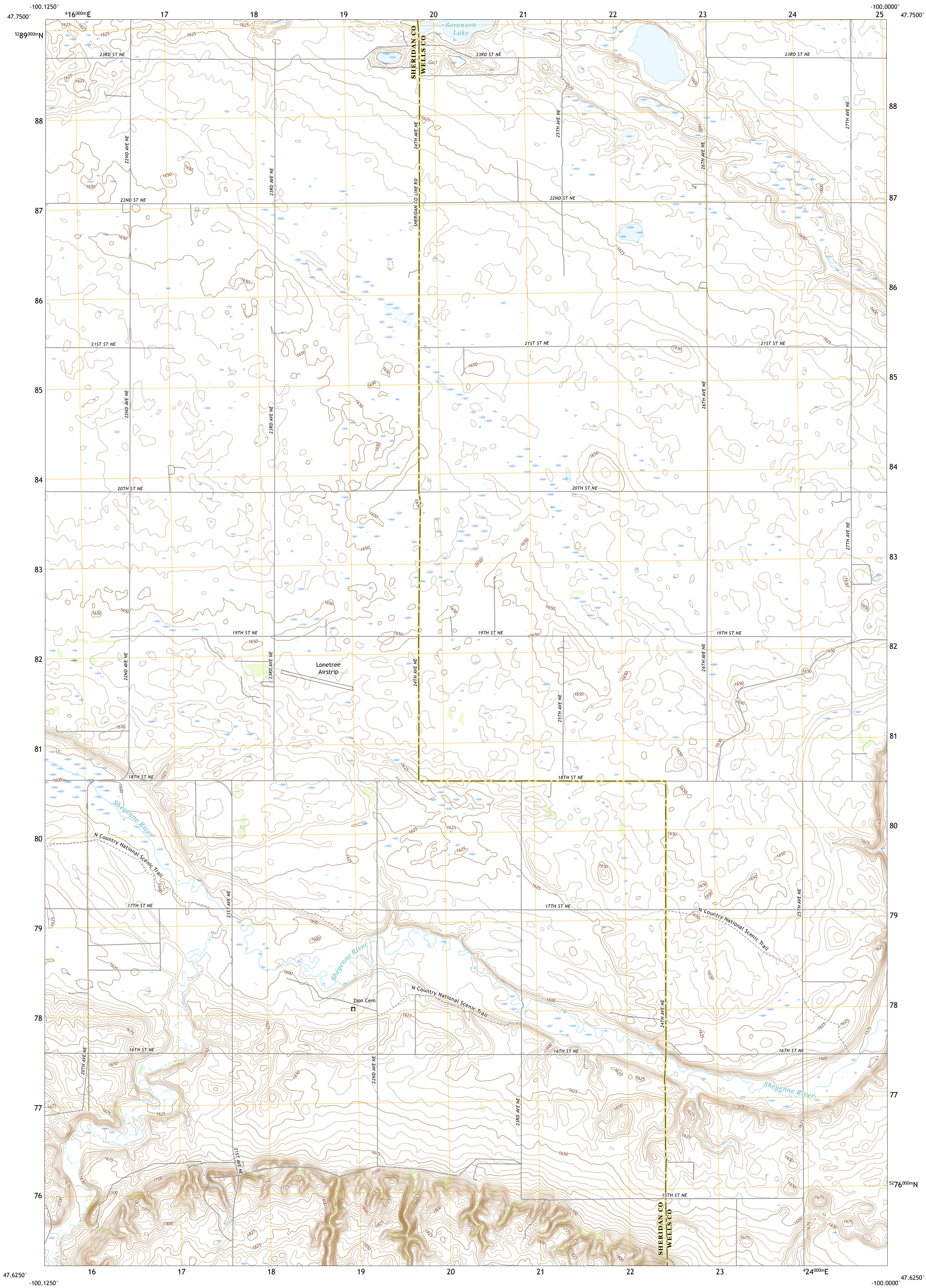

U.S. DEPARTMENT OF THE INTERIOR  
U.S. GEOLOGICAL SURVEY



SHEYENNE LAKE NE QUADRANGLE  
NORTH DAKOTA  
7.5-MINUTE SERIES



**Produced by the United States Geological Survey**

North American Datum of 1983 (NAD83)  
World Geodetic System of 1984 (WGS84), Projection and  
1 000-meter grid; Universal Transverse Mercator, Zone 14T  
This map is not a legal document. Boundaries may be  
generalized for this map scale. Private lands within government  
reservations may not be shown. Obtain permission before  
entering private lands.

Imagery.....NAIP, September 2015 - December 2015  
Roads.....U.S. Census Bureau, 2016  
Names.....GNIS, 1980 - 2017  
Hydrography.....National Hydrography Dataset, 2005 - 2017  
Contours.....National Elevation Dataset, 2012  
Boundaries.....Multiple sources; see metadata file 2014 - 2016  
Public Land Survey System.....BLM, 2016  
Wetlands.....National Wetlands Inventory 1979 - 2009

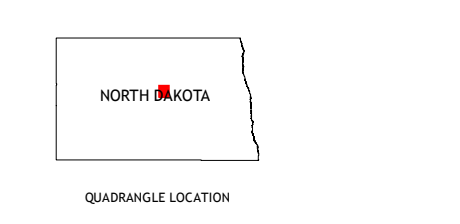
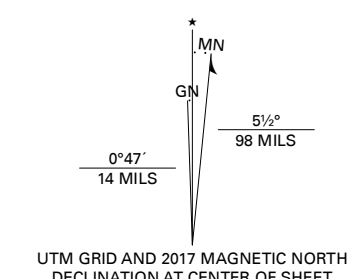

ROAD CLASSIFICATION	
	Expressway
	Secondary Hwy
	Ramp
	Interstate Route
	US Route
	Local Connector
	Local Road
	4WD
	State Route

ADJOINING QUADRANGLES	
1	2
4	5
6	7

1 Anamosse SW  
2 Martin  
3 Harvey  
4 Sheyenne Lake  
5 Manfred NW  
6 Mertz Slough  
7 Pony Gulch  
8 Manfred SW

SHEYENNE LAKE NE, ND  
2018

