

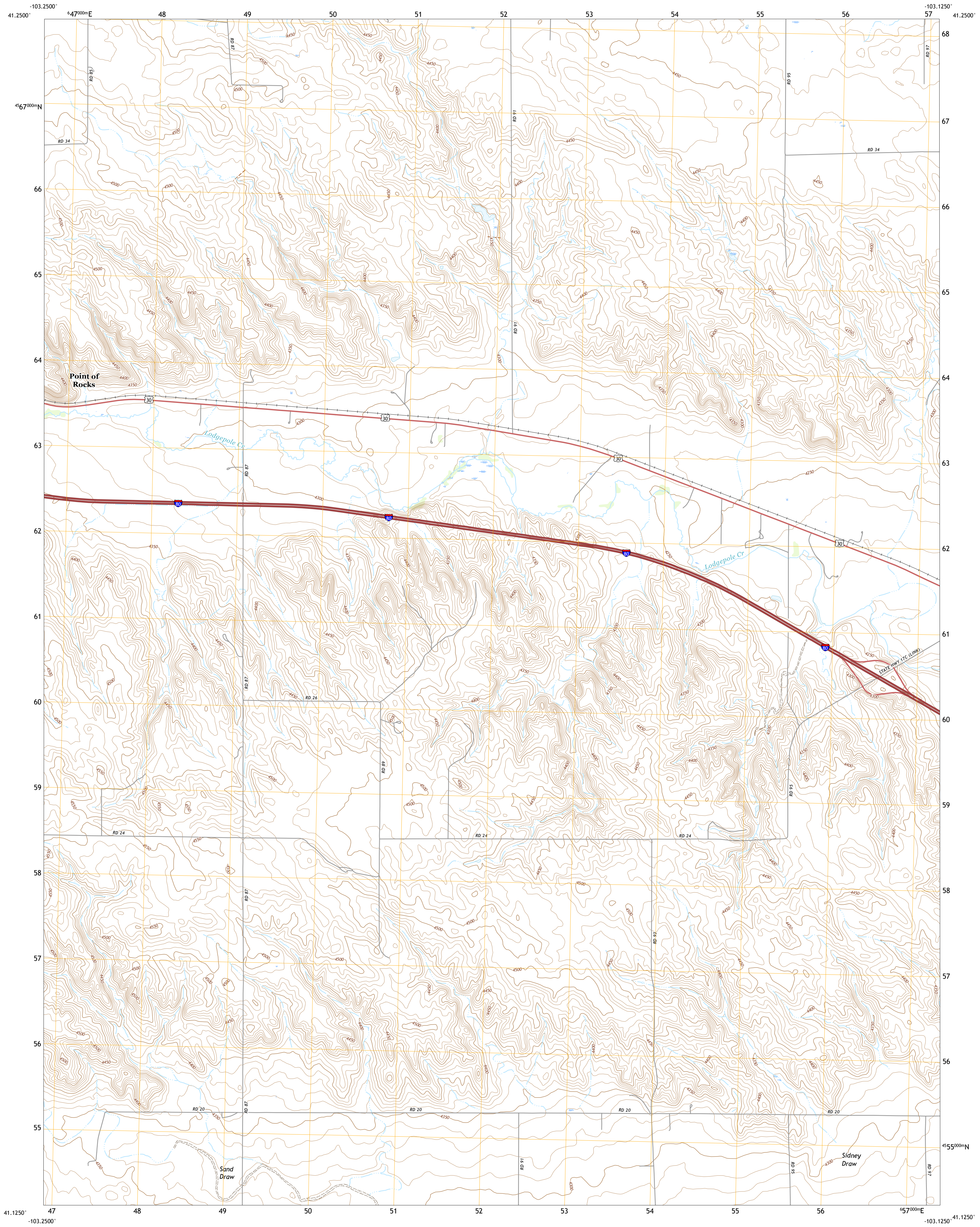

U.S. DEPARTMENT OF THE INTERIOR  
U.S. GEOLOGICAL SURVEY



POINT OF ROCKS QUADRANGLE  
NEBRASKA - CHEYENNE COUNTY  
7.5-MINUTE SERIES



**Produced by the United States Geological Survey**

North American Datum of 1983 (NAD83)  
World Geodetic System of 1984 (WGS84), Projection and  
1 000-meter grid/Universal Transverse Mercator, Zone 13T  
This map is not a legal document. Boundaries may be  
generalized for this map scale. Private lands within government  
reservations may not be shown. Obtain permission before  
entering private lands.

Imagery.....	N.A.I.P., July 2016 - October 2016
Roads.....	U.S. Census Bureau, 2015
Names.....	GNIS, 1979 - 2016
Hydrography.....	National Hydrography Dataset, 2004 - 2016
Contours.....	National Elevation Dataset, 2002
Boundaries.....	Multiple sources; see metadata file 2014 - 2016
Public Land Survey System.....	BLM, 2017
Wetlands.....	FWS National Wetlands Inventory 1984

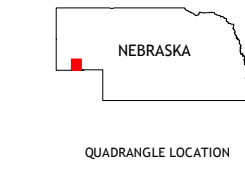
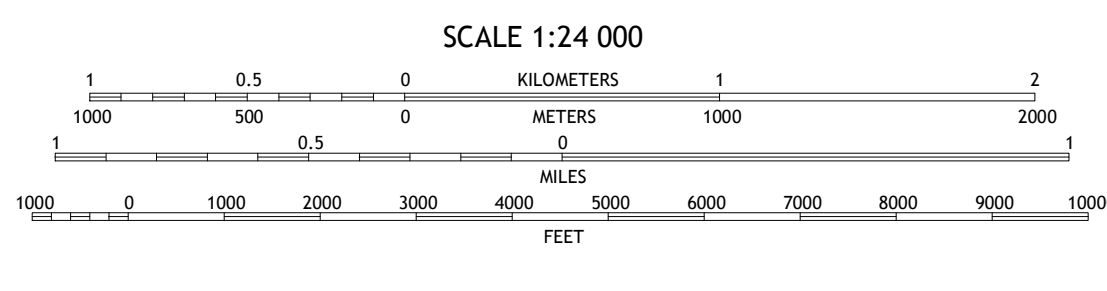
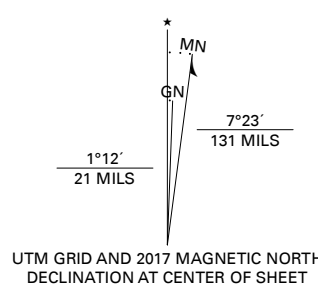

1	2	3
4	5	6
7	8	

ADJOINING QUADRANGLES

- 1 Swedish Cemetery
- 2 Mud Springs SW
- 3 Mud Springs SE
- 4 Potter
- 5 Brownson
- 6 Potter SE
- 7 Easterly Airport
- 8 Lorenzo

ROAD CLASSIFICATION	
	Expressway
	Secondary Hwy
	Ramp
	Interstate Route
	US Route
	State Route
	Local Connector
	Local Road
	4WD

POINT OF ROCKS, NE  
2017

