

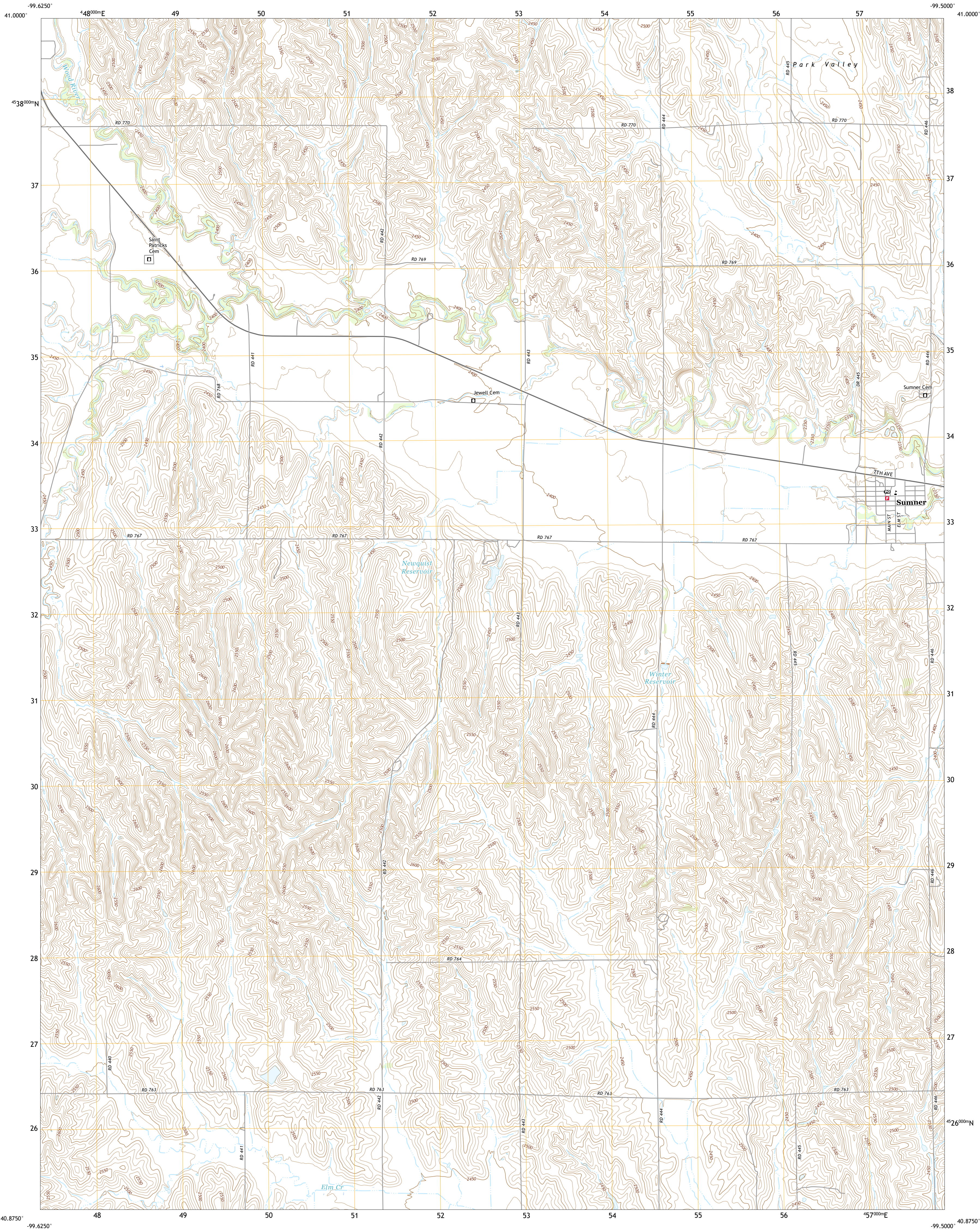

U.S. DEPARTMENT OF THE INTERIOR  
U.S. GEOLOGICAL SURVEY



SUMNER QUADRANGLE  
NEBRASKA - DAWSON COUNTY  
7.5-MINUTE SERIES



Produced by the United States Geological Survey  
North American Datum of 1983 (NAD83)  
World Geodetic System of 1984 (WGS84). Projection and  
1 000-meter grid/Universal Transverse Mercator, Zone 14T  
This map is not a legal document. Boundaries may be  
generalized for this map scale. Private lands within government  
reservations may not be shown. Obtain permission before  
entering private lands.  
Imagery.....NAIP, September 2020 - September 2020  
Roads.....U.S. Census Bureau, 2015  
Names.....GNIS, 1979 - 2020  
Hydrography.....National Hydrography Dataset, 2006 - 2019  
Contours.....National Elevation Dataset, 2021  
Boundaries.....Multiple sources: file 2018 - 2019  
Public Land Survey System.....BLM, 2020  
Wetlands.....FWS National Wetlands Inventory Not Available

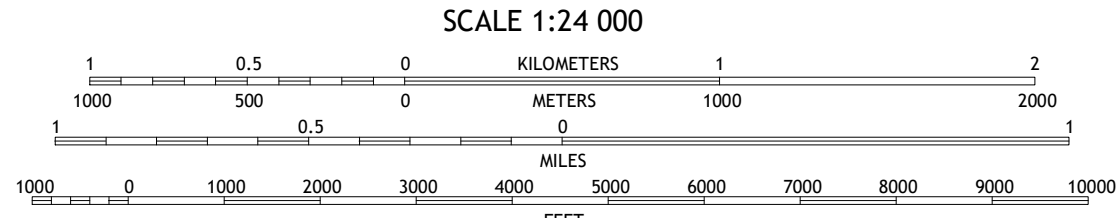
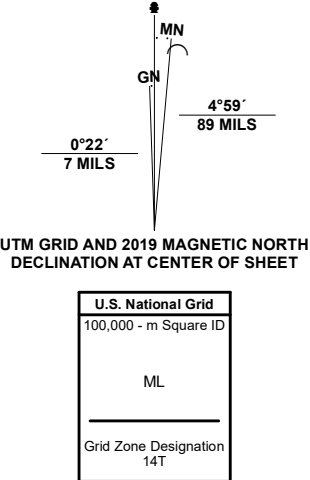

QUADRANGLE LOCATION

1	2	3
4	5	6
7	8	9

1 Eddyville SW  
2 Eddyville  
3 Mason City SW  
4 Lexington NW  
5 Miller  
6 Lexington East  
7 Lexington SE  
8 Miller SW

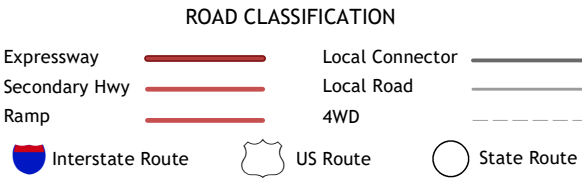

SUMNER, NE  
2021

