

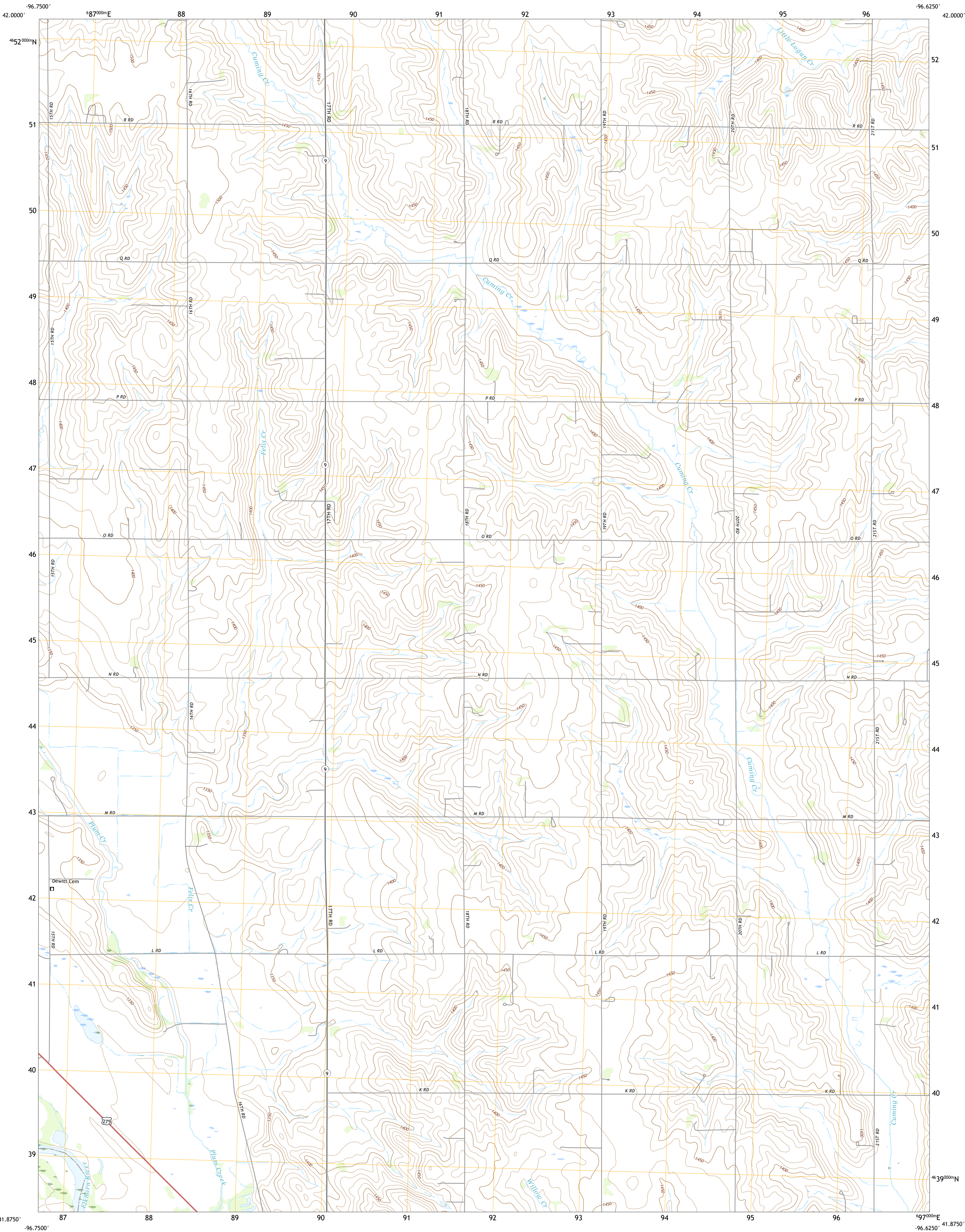

U.S. DEPARTMENT OF THE INTERIOR
U.S. GEOLOGICAL SURVEY



WEST POINT NW QUADRANGLE
NEBRASKA - CUMING COUNTY
7.5-MINUTE SERIES



Produced by the United States Geological Survey

North American Datum of 1983 (NAD83)
World Geodetic System of 1984 (WGS84) - Projection and
1 000-meter grid/Universal Transverse Mercator, Zone 14T
This map is not a legal document. Boundaries may be
generalized for this map scale. Private lands within government
reservations may not be shown. Obtain permission before
entering private lands.

Imagery.....NAIP, July 2020 - August 2020
Roads.....U.S. Census Bureau, 2015
Names.....GNIS, 1979 - 2018
Hydrography.....National Hydrography Dataset, 2001 - 2019
Contours.....National Elevation Dataset, 2002
Boundaries.....Multiple sources: see metadata file, 2018 - 2019
Public Land Survey System.....BLM, 2020
Wetlands.....FWS National Wetlands Inventory Not Available

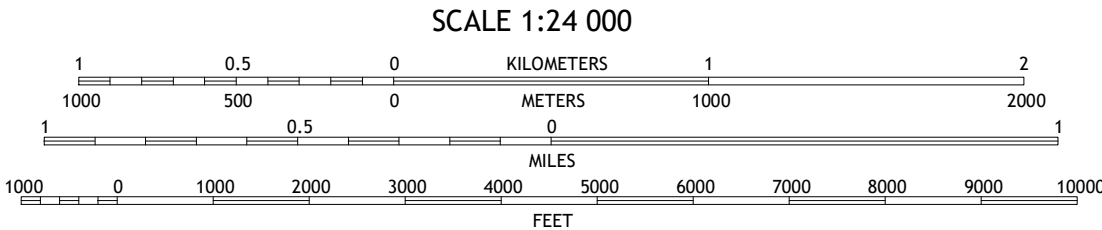
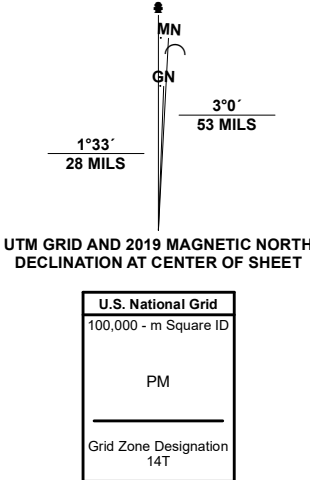

QUADRANGLE LOCATION

1	2	3
4	5	6
7	8	9

ADJOINING QUADRANGLES

1 Altona SE
2 Pender
3 Bancroft
4 Bemmer
5 West Point NE
6 Monterey
7 West Point
8 West Point SE

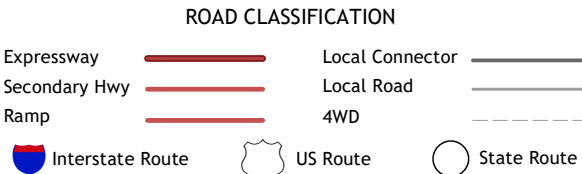

WEST POINT NW, NE
2021

