

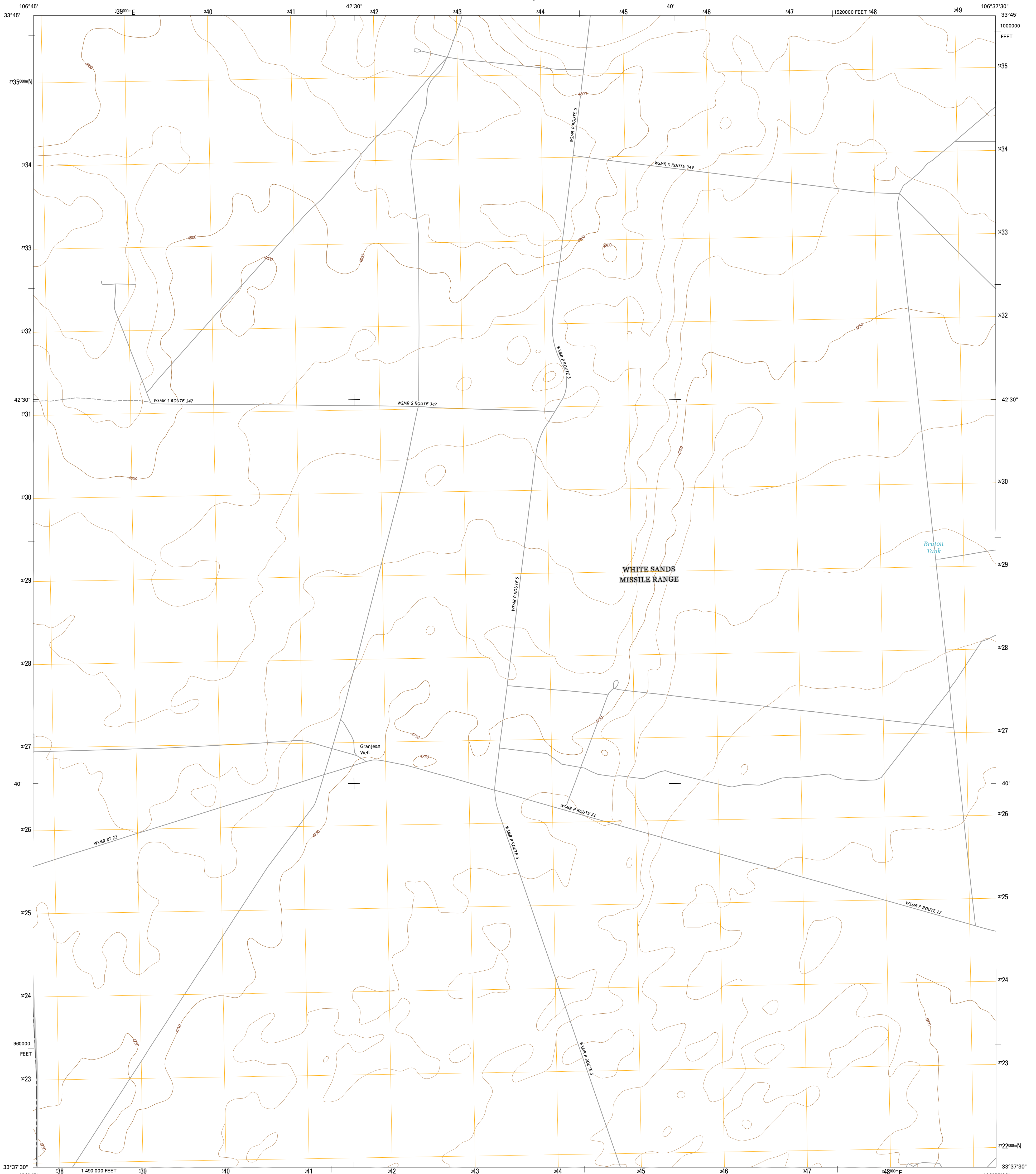

U.S. DEPARTMENT OF THE INTERIOR  
U.S. GEOLOGICAL SURVEY



GRANJEAN WELL QUADRANGLE  
NEW MEXICO-SOCORRO CO.  
7.5-MINUTE SERIES



Produced by the United States Geological Survey  
North American Datum of 1983 (NAD83)  
World Geodetic System of 1984 (WGS84). Projection and  
1 000-meter grid: Universal Transverse Mercator, Zone 13S  
10 000-foot ticks: New Mexico Coordinate System of 1983  
(central zone)  
This map is not a legal document. Boundaries may be  
generalized for this map scale. Private lands within government  
reservations may not be shown. Obtain permission before  
entering private lands.  
ImageT... ..NAP, October 2014  
Roads... ..U.S. Census Bureau, 2015 - 2016  
Names... ..GNIS, 2016  
Hydrography... ..National Hydrography Dataset, 2014  
Contours... ..National Elevation Dataset, 2000  
Boundaries... ..Multiple sources; see metadata file 1972 - 2016  
Public Land Survey System... ..BLM, 2016  
Wetlands... ..FWS National Wetlands Inventory 1977 - 2014

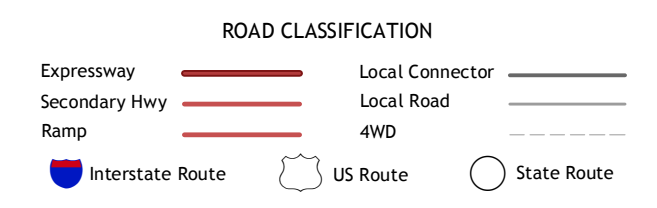
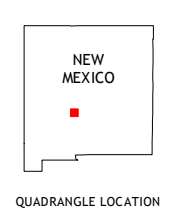
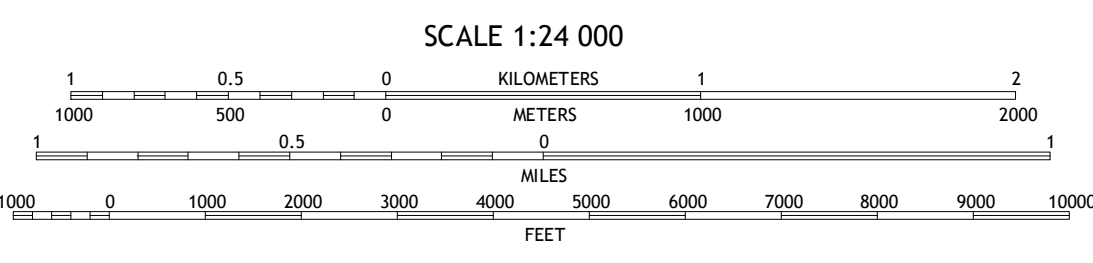
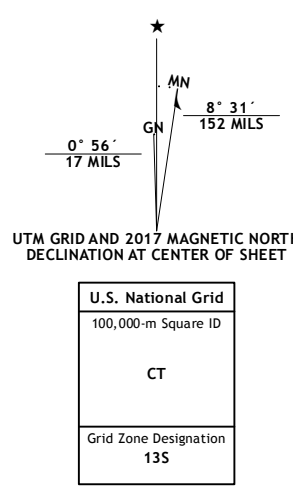

1	2	3
4	5	6
7	8	

ADJOINING QUADRANGLES

1 San Antonio SE  
2 Cerro De La Campana  
3 Cerro De La Campana SE  
4 Little San Pascual Mountain  
5 Greens Barber Well  
6 Harriet Ranch  
7 Blakemore Well  
8 Foster Well

GRANJEAN WELL, NM  
2017

