

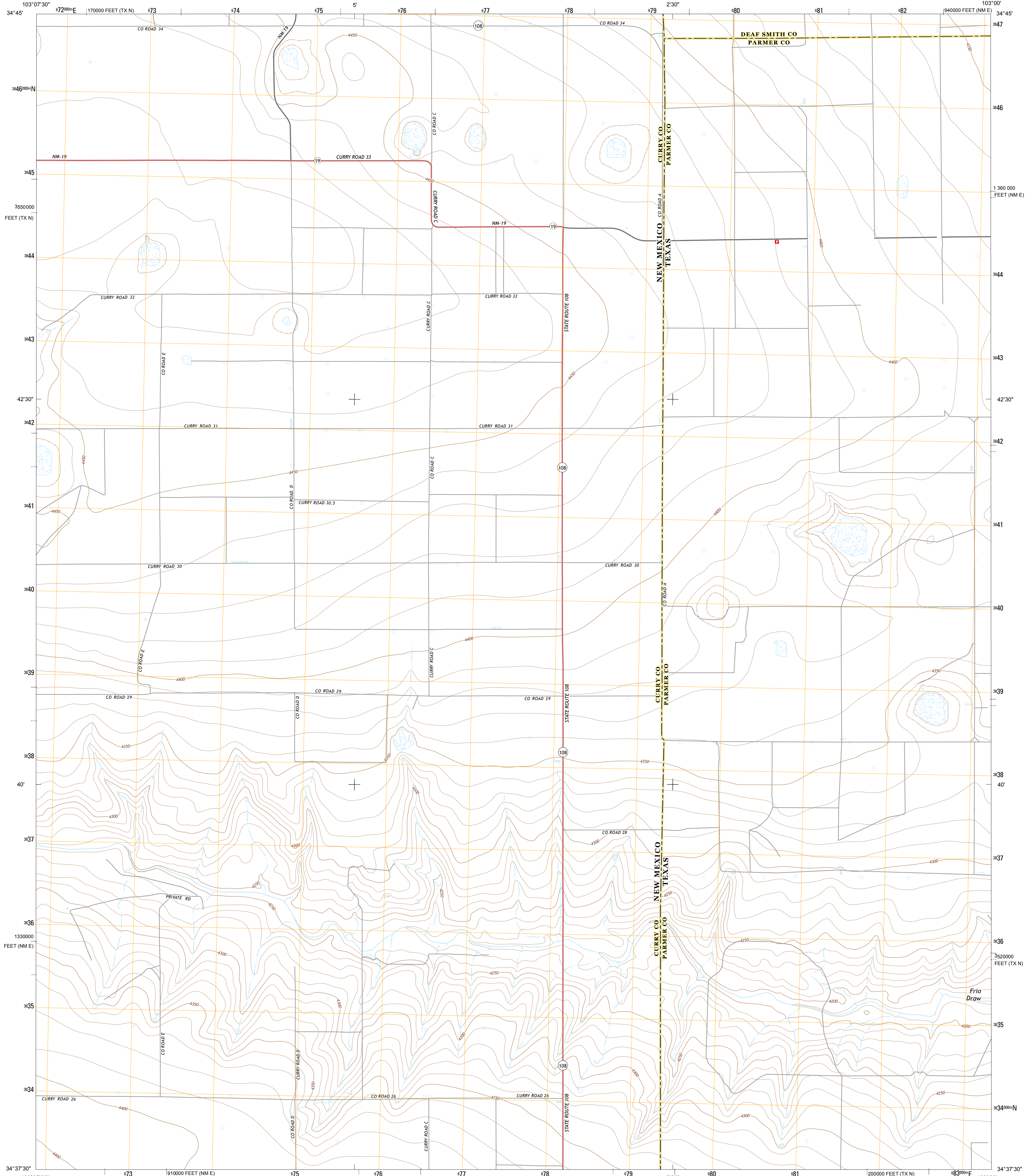

U.S. DEPARTMENT OF THE INTERIOR
U. S. GEOLOGICAL SURVEY



PLEASANT HILL NE QUADRANGLE
NEW MEXICO-Texas
7.5-MINUTE SERIES



Produced by the United States Geological Survey
 North American Datum of 1983 (NAD83)
 World Geodetic System of 1984 (WGS84). Projection and
 1 000-meter grid: Universal Transverse Mercator, Zone 13S
 10 000-foot ticks: New Mexico Coordinate System of 1983 (east
 zone), Texas Coordinate System of 1983 (north zone)
 Imagery.....N.A.P., May 2011
 Roads.....©2006-2013 TomTom
 Names.....GNIS, 2013
 Hydrography.....National Hydrography Dataset, 2011
 Contours.....National Elevation Dataset, 2006
 Boundaries.....Census, IBWC, IBC, USGS, 1972 - 2012
 Public Land Survey System.....BLM, 2011

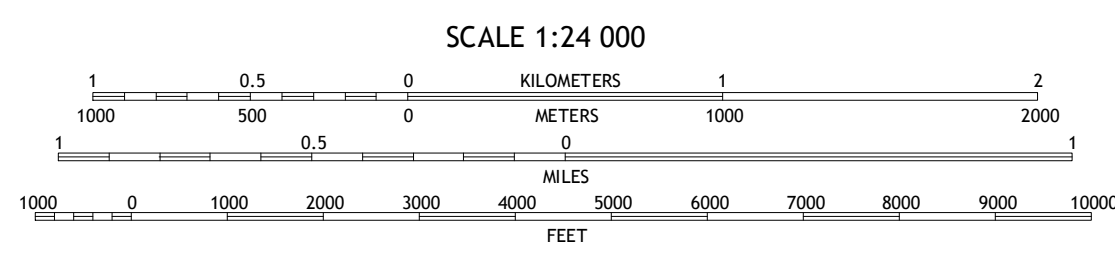
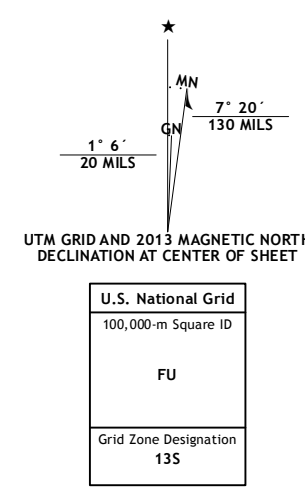

CONTOUR INTERVAL 10 FEET
 NORTH AMERICAN VERTICAL DATUM OF 1988
 This map was produced to conform with the
 National Geospatial Program US Topo Product Standard, 2011.
 A metadata file associated with this product is draft version 0.6.15

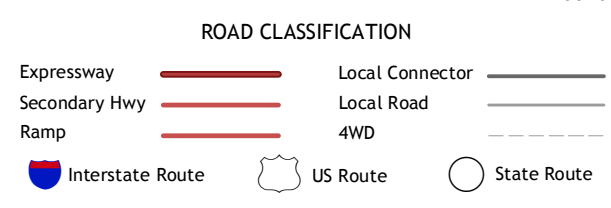
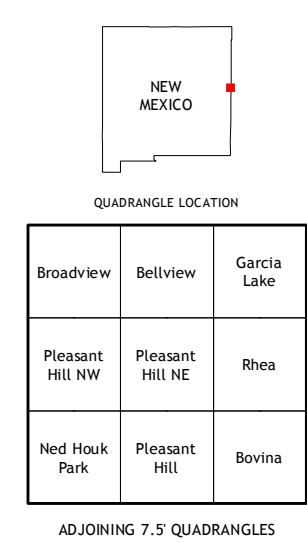

QUADRANGLE LOCATION		
Broadview	Bellview	Garcia Lake
Pleasant Hill NW	Pleasant Hill NE	Rhea
Hed Hook Park	Pleasant Hill	Bovina

PLEASANT HILL NE, NM-TX
2013

