

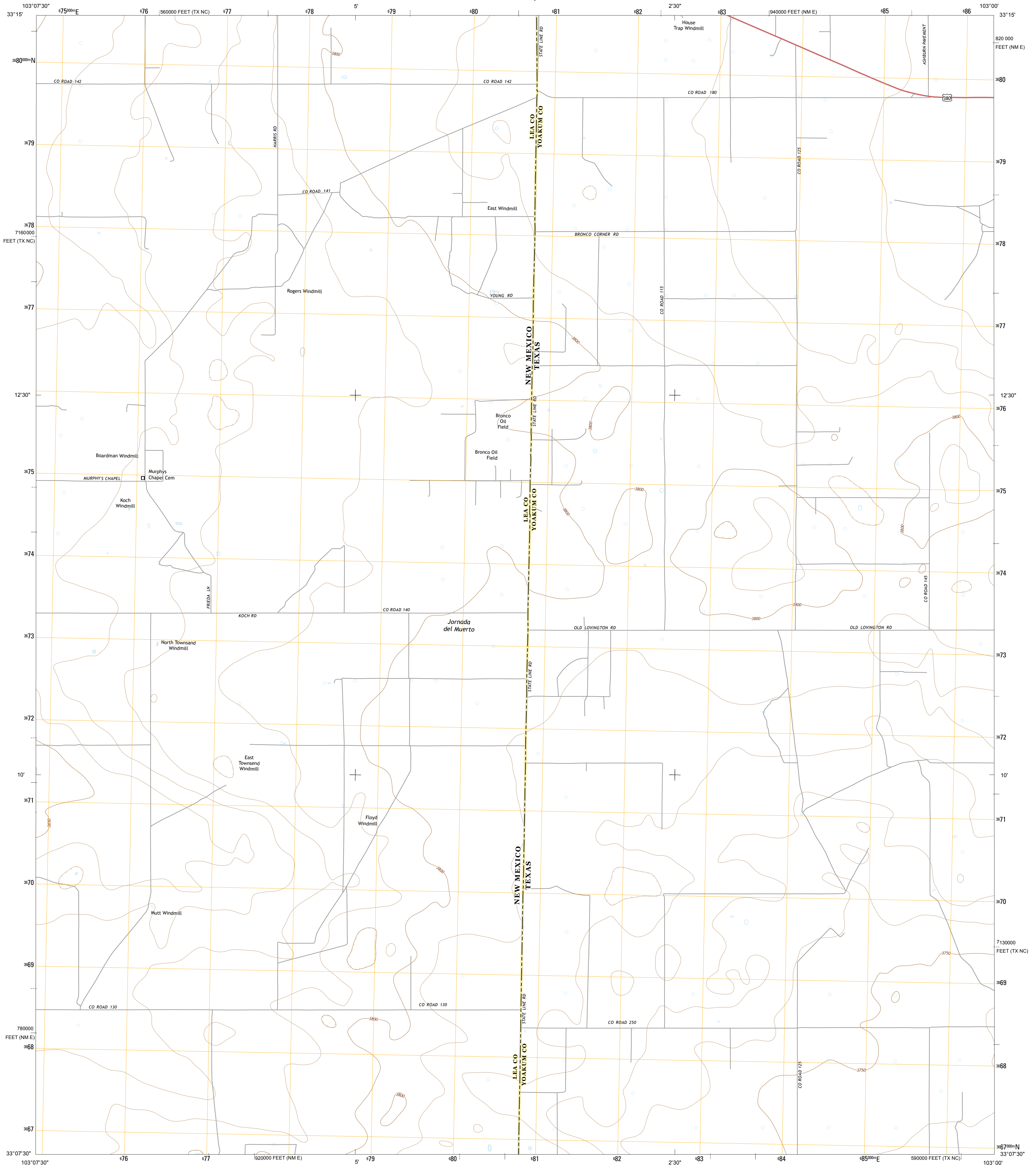

U.S. DEPARTMENT OF THE INTERIOR  
U. S. GEOLOGICAL SURVEY



PRAIRIEVIEW NE QUADRANGLE  
NEW MEXICO-TEXAS  
7.5-MINUTE SERIES



**Produced by the United States Geological Survey**  
 North American Datum of 1983 (NAD83)  
 World Geodetic System of 1984 (WGS84). Projection and 1 000-meter grid: Universal Transverse Mercator, Zone 13S  
 10 000-foot ticks: New Mexico Coordinate System of 1983 (east zone), Texas Coordinate System of 1983 (north central zone)  
 This map is not a legal document. Boundaries may be generalized for this map scale. Private lands within government reservations may not be shown. Obtain permission before entering private lands.  
 Imagery.....NAIP, May 2011  
 Roads.....©2006-2013 TomTom  
 Names.....GNIS, 2013  
 Hydrography.....National Hydrography Dataset, 2011  
 Contours.....National Elevation Dataset, 2002  
 Boundaries.....Census, IBWC, USGS, 1972 - 2012  
 Public Land Survey System.....BLM, 2011

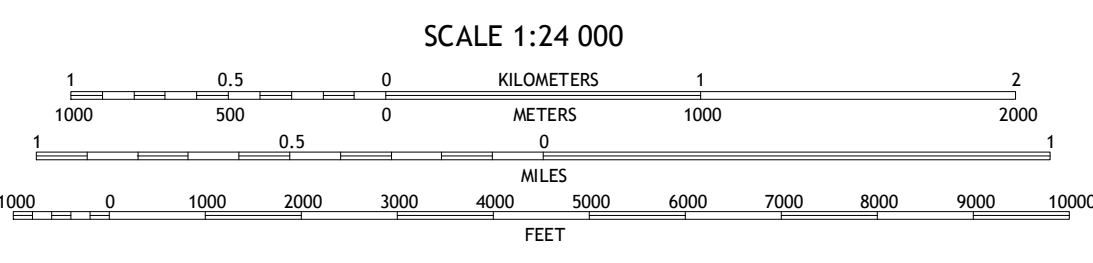
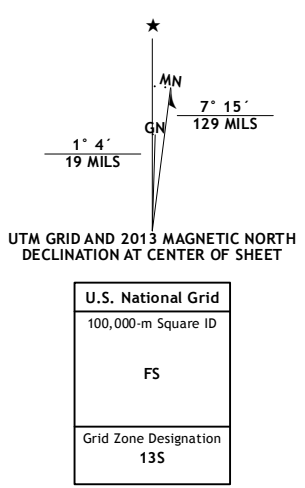

CONTOUR INTERVAL 10 FEET  
 NORTH AMERICAN VERTICAL DATUM OF 1988  
 This map was produced to conform with the National Geospatial Program US Topo Product Standard, 2011. A metadata file associated with this product is draft version 0.6.15

**ROAD CLASSIFICATION**

- Expressway
- Secondary Hwy
- Ramp
- Local Connector
- Local Road
- 4WD
- US Route
- State Route

**QUADRANGLE LOCATION**

Gladrola	Bronco	Two B Ranch SW
Prairieview NW	Prairieview NE	Plains HW
Prairieview SE	Prairieview SW	Ink Basin

**ADJOINING 7.5 QUADRANGLES**

PRAIRIEVIEW NE, NM-TX  
2013

