

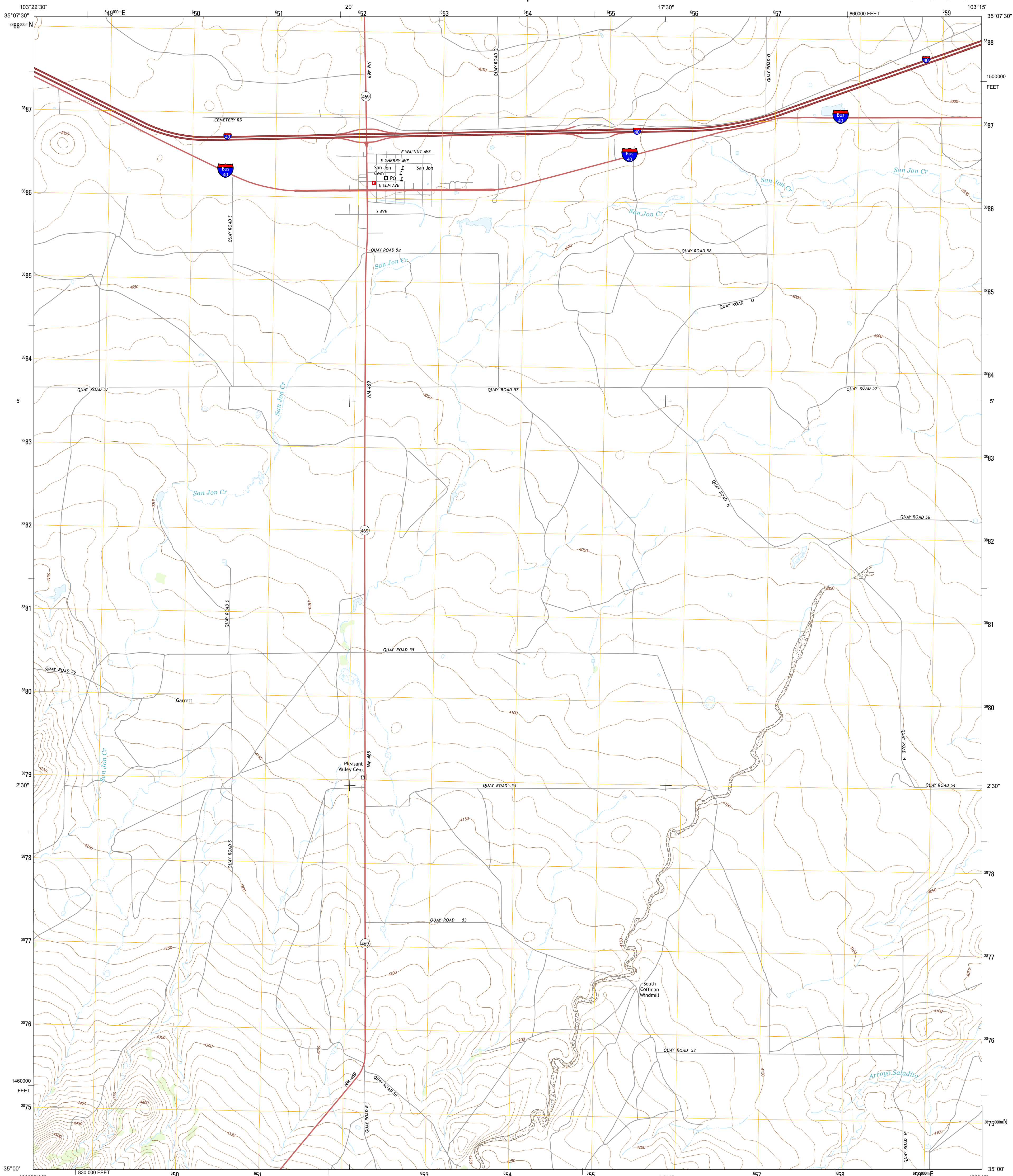

U.S. DEPARTMENT OF THE INTERIOR
U. S. GEOLOGICAL SURVEY



SAN JON QUADRANGLE
NEW MEXICO-QUAY CO.
7.5-MINUTE SERIES



Produced by the United States Geological Survey
 North American Datum of 1983 (NAD83)
 World Geodetic System of 1984 (WGS84), Projection and
 1 000-meter grid: Universal Transverse Mercator, Zone 13S
 10 000-foot ticks: New Mexico Coordinate System of 1983 (east zone)

This map is not a legal document. Boundaries may be generalized for this map scale. Private lands within government reservations may not be shown. Obtain permission before entering private lands.

Imagery.....NAIP, May 2011
 Roads.....©2006-2013 TomTom
 Names.....GNIS, 2013
 Hydrography.....National Hydrography Dataset, 2011
 Contours.....National Elevation Dataset, 1998
 Boundaries.....Census, IBC, USGS, 1972-2012
 Public Land Survey System.....BLM, 2011

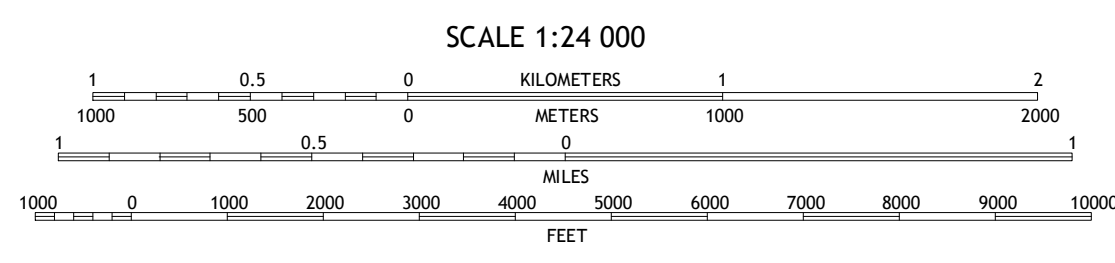
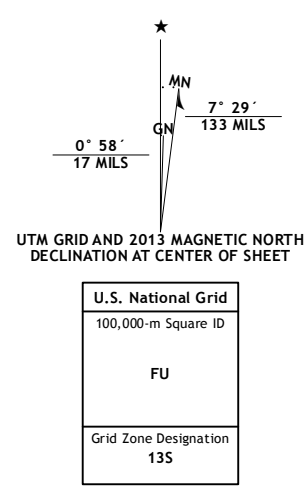

CONTOUR INTERVAL 10 FEET
 NORTH AMERICAN VERTICAL DATUM OF 1988

This map was produced to conform with the
 National Geospatial Program US Topo Product Standard, 2011.
 A metadata file associated with this product is draft version 0.6.15



QUADRANGLE LOCATION

San Jon NW	Porter	Bard
Bedford Hill	San Jon	Riley Camp
Apache Canyon	Wheatland	Day Canyon

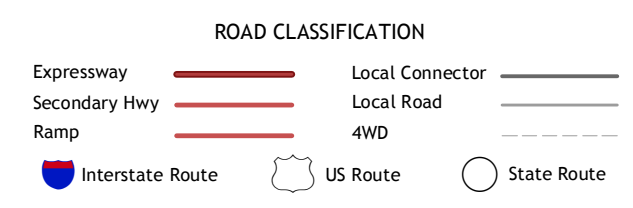

SAN JON, NM
2013

