

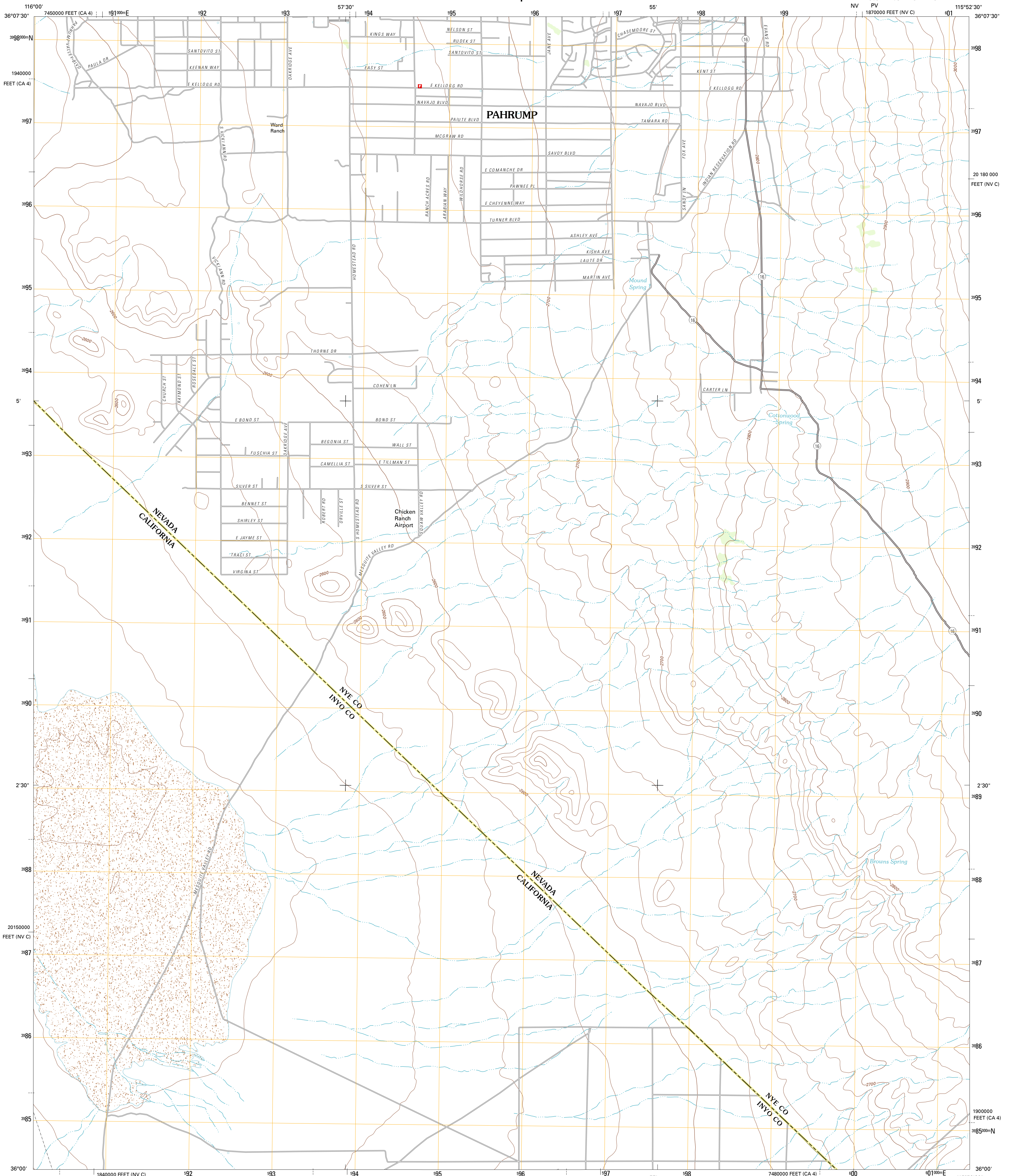

U.S. DEPARTMENT OF THE INTERIOR  
U. S. GEOLOGICAL SURVEY



MOUND SPRING QUADRANGLE  
NEVADA-CALIFORNIA  
7.5-MINUTE SERIES



Produced by the United States Geological Survey  
North American Datum of 1983 (NAD83)  
World Geodetic System of 1984 (WGS84). Projection and  
1 000-meter grid: Universal Transverse Mercator, Zone 11S  
10 000-foot ticks: Nevada Coordinate System of 1983  
(central zone), California Coordinate System of 1983 (zone 4)

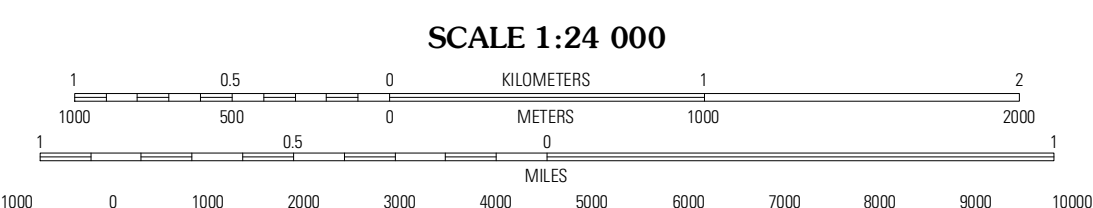
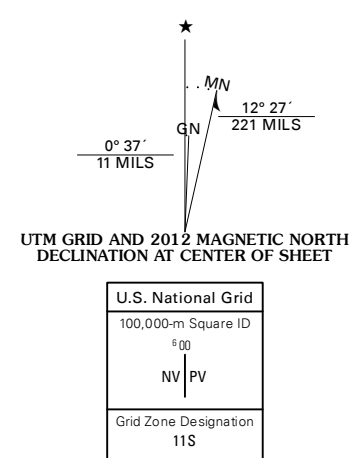

CONTOUR INTERVAL 20 FEET  
NORTH AMERICAN VERTICAL DATUM OF 1988

This map was produced to conform with the  
National Geospatial Program US Topo Product Standard, 2011.  
A metadata file associated with this product is draft version 0.6.1

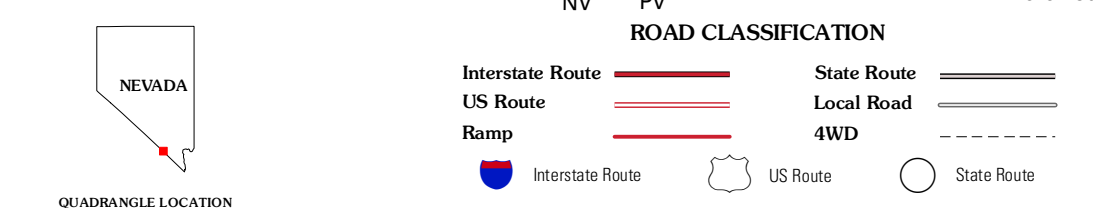

QUADRANGLE LOCATION

Stimile Spring	Pahrump	Pahrump NE
Nopah Peak	Mound Spring	Hidden Hills Ranch
North of Toiyabe Pass	Calvada Springs	Stump Spring

MOUND SPRING, NV-CA  
2012

ADJOINING 7.5' QUADRANGLES