

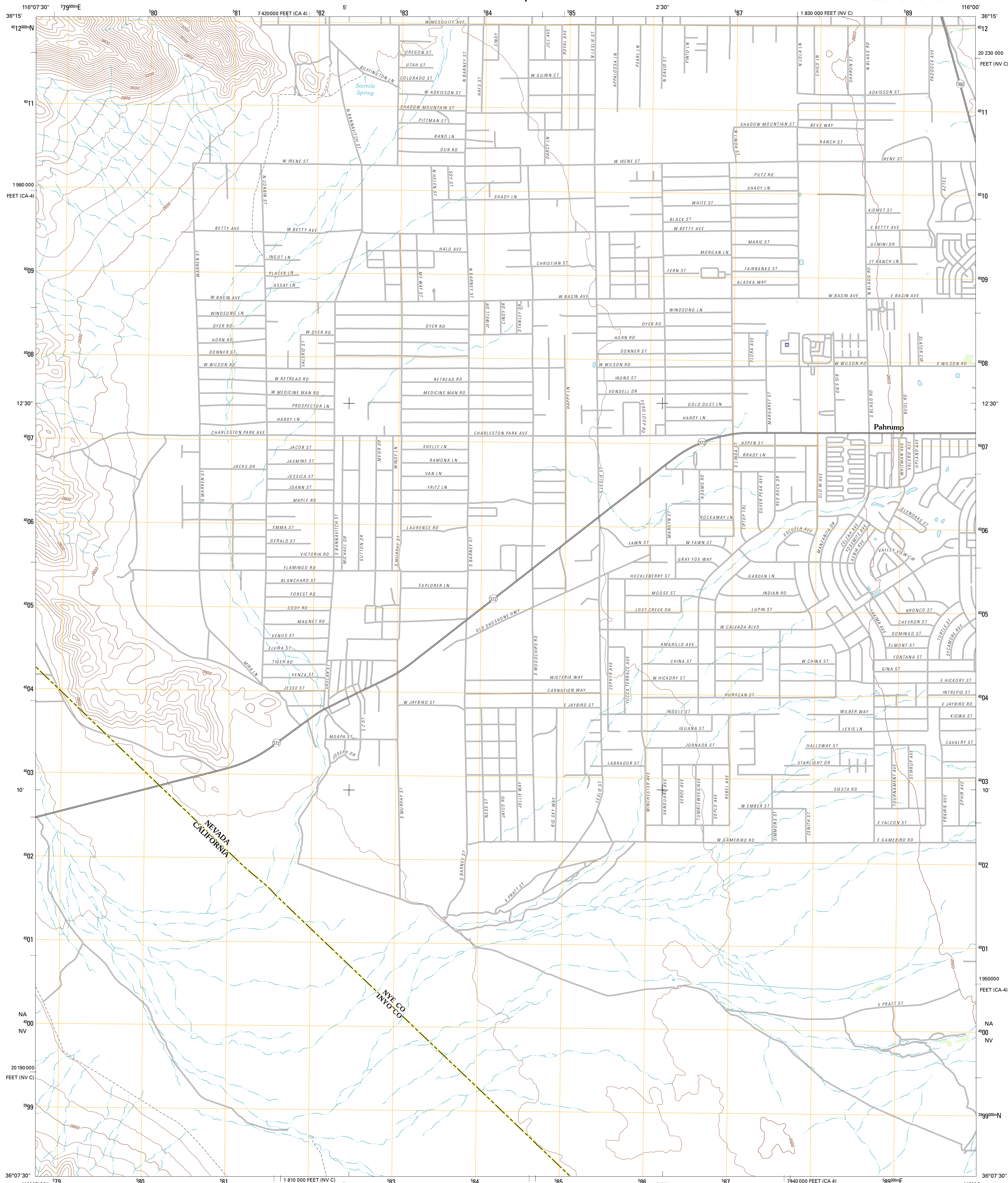

U.S. DEPARTMENT OF THE INTERIOR
U. S. GEOLOGICAL SURVEY



SIXMILE SPRING QUADRANGLE
NEVADA-CALIFORNIA
7.5-MINUTE SERIES



Produced by the United States Geological Survey
North American Datum of 1983 (NAD83)
World Geodetic System of 1984 (WGS84). Projection and
1 000-meter grid: Universal Transverse Mercator, Zone 11S
10 000-foot ticks: Nevada Coordinate System of 1983
(central zone), California Coordinate System of 1983 (zone 4)

Imagery: N.A.P. May 2010
Contour Interval: 2006-2011 TomTom
Names: GNS, 2011
Hydrography: National Hydrography Dataset, 2010
Contours: National Elevation Dataset, 2001
Boundaries: Census, IBWC, IBC, USGS, 1972-2010

UTM GRID AND 2012 MAGNETIC NORTH DECLINATION AT CENTER OF SHEET

U.S. National Grid
100,000-Square-Meter Grid
NA
NV
Grid Zone Designation
11S

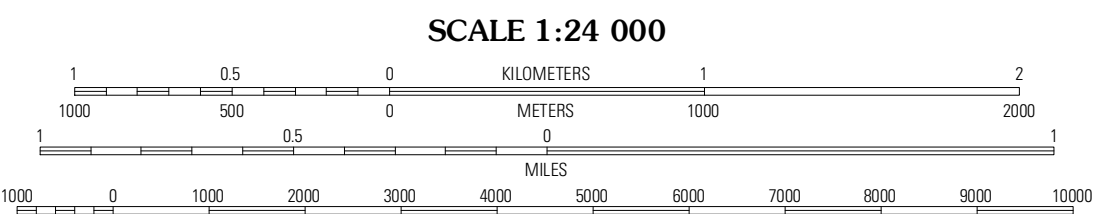

CONTOUR INTERVAL 40 FEET
NORTH AMERICAN VERTICAL DATUM OF 1988
This map was produced to conform with the
National Geospatial Program US Topo Product Standard, 2011.
A metadata file associated with this product is draft version 0.6.1

QUADRANGLE LOCATION

High Peak	Last Chance Range	Horse Springs
Stewart Valley	Sixmile Spring	Pahrump
Twelvemile Spring	Nopah Peak	Mound Spring

ROAD CLASSIFICATION

- Interstate Route (thick red line)
- US Route (red line)
- Ramp (red line with arrow)
- State Route (thin red line)
- Local Road (grey line)
- 4WD (dashed grey line)

SIXMILE SPRING, NV-CA
2012

ADJOINING 7.5' QUADRANGLES