

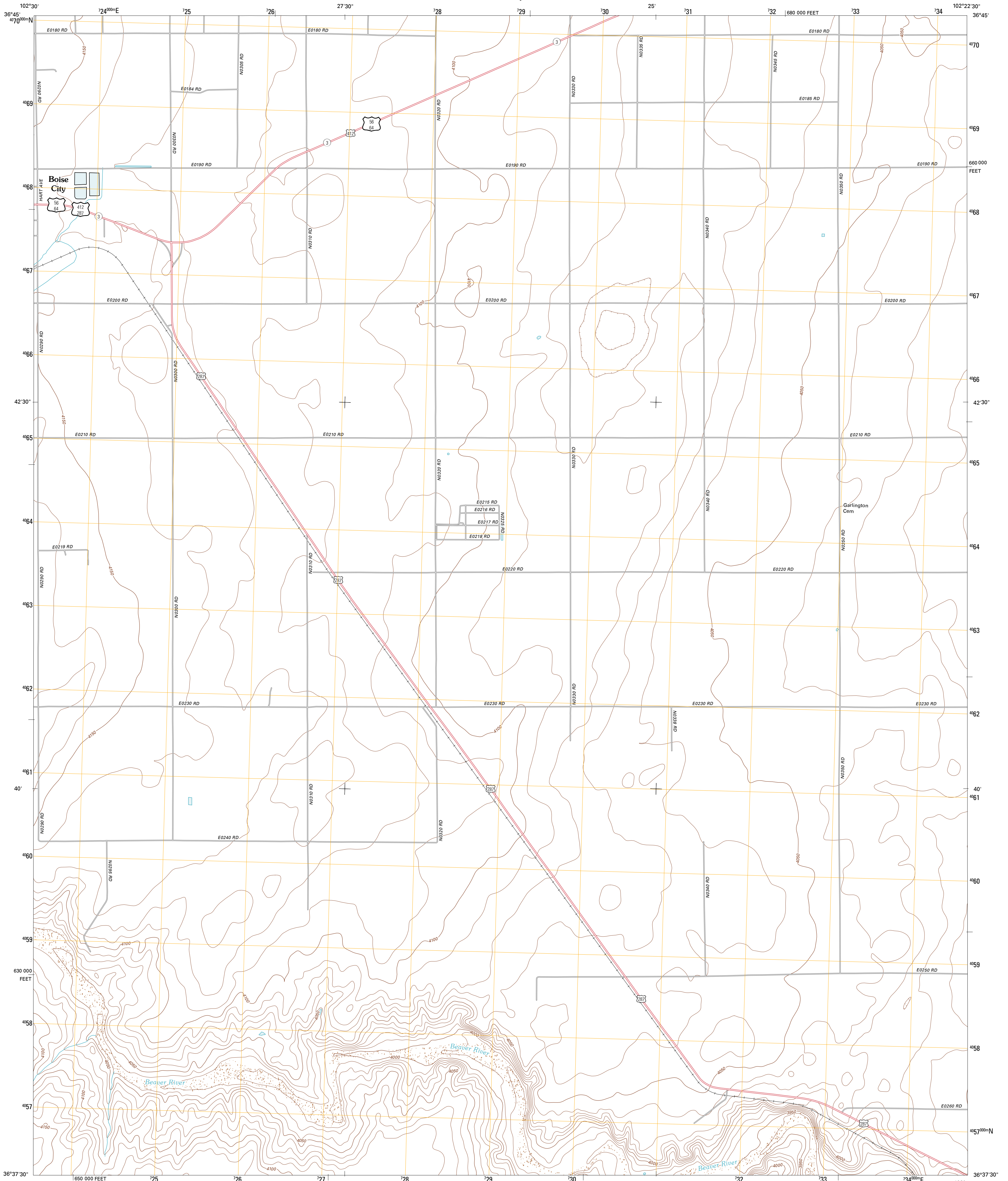

U.S. DEPARTMENT OF THE INTERIOR  
U. S. GEOLOGICAL SURVEY



CONRAD NW QUADRANGLE  
OKLAHOMA-CIMARRON CO.  
7.5-MINUTE SERIES



Produced by the United States Geological Survey  
North American Datum of 1983 (NAD83)  
World Geodetic System of 1984 (WGS84) Projection and  
1 000-meter grid; Universal Transverse Mercator, Zone 13S  
10 000-foot ticks; Oklahoma Coordinate System of 1983  
(north zone)

Imagery: NADIP, May 2010  
Roads: ©2006-2011 TomTom  
Names: ©2006-2011 TomTom  
Hydrography: National Hydrography Dataset, 2010  
Contours: National Elevation Dataset, 2007  
Boundaries: Census, IBWC, IBC, USGS, 1972 - 2012

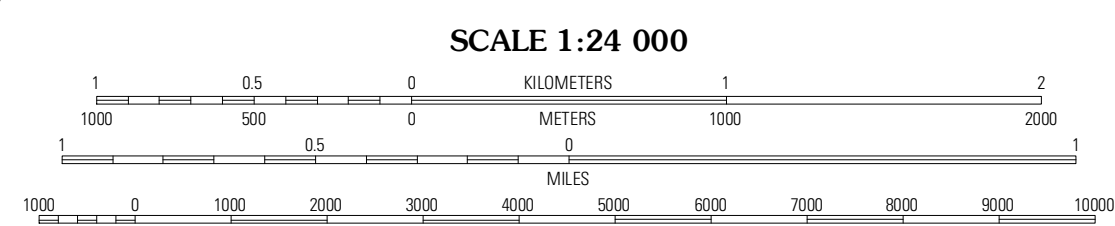
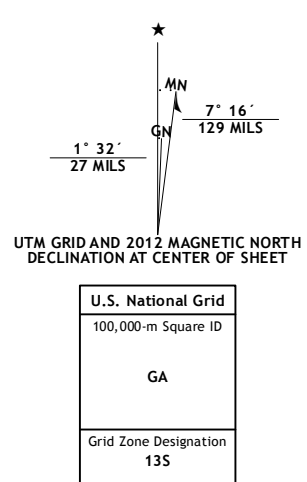

CONTOUR INTERVAL 10 FEET  
NORTH AMERICAN VERTICAL DATUM OF 1988

This map was produced to conform with the National Geospatial Program US Topo Product Standard, 2011. A metadata file associated with this product is draft version 0.6.6

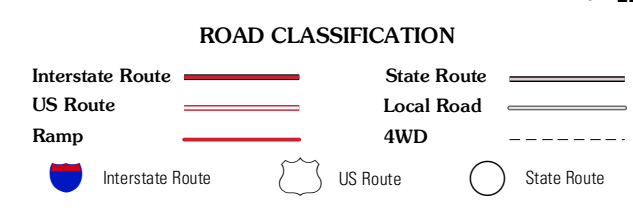
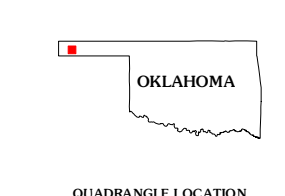

QUADRANGLE LOCATION

Flag Springs	Keys SW	Keys West
Boise City	Conrad NW	Sampsel Lake
Boise City SE	Conrad SW	Conrad

CONRAD NW, OK  
2012

ADJOINING 7.5' QUADRANGLES