

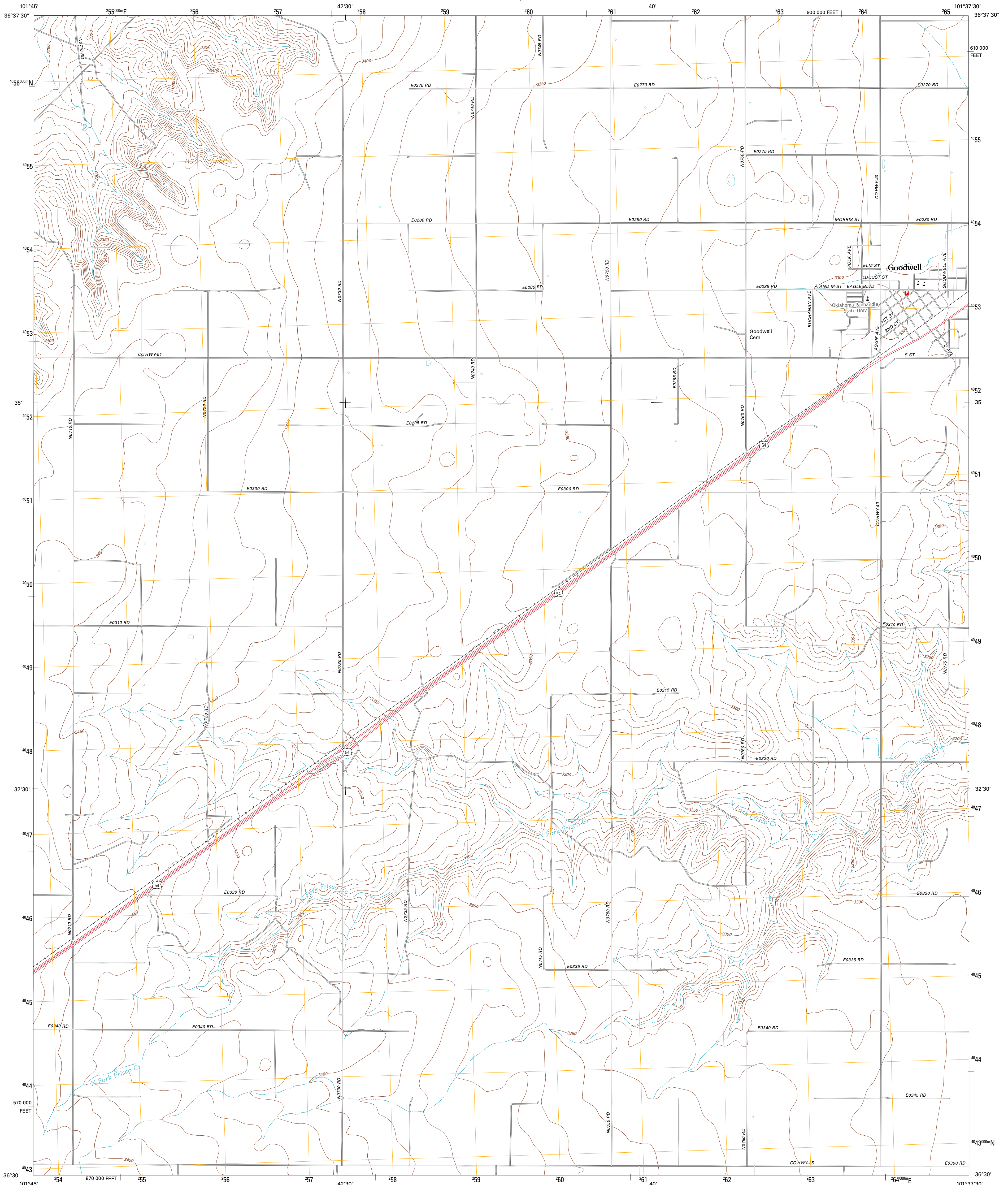

U.S. DEPARTMENT OF THE INTERIOR  
U. S. GEOLOGICAL SURVEY



GOODWELL QUADRANGLE  
OKLAHOMA-TEXAS CO.  
7.5-MINUTE SERIES



Produced by the United States Geological Survey  
North American Datum of 1983 (NAD83)  
World Geodetic System of 1984 (WGS84). Projection and  
1 000-meter grid: Universal Transverse Mercator, Zone 14S  
10 000-foot ticks: Oklahoma Coordinate System of 1983  
(north zone)

Imagery:.....NAIP, May 2010  
Roads:.....©2006-2011 TomTom  
Names:.....GNIS, 2012  
Hydrography:.....National Hydrography Dataset, 2010  
Contours:.....National Elevation Dataset, 2007  
Boundaries:.....Census, BWC, IBC, USGS, 1972 - 2012

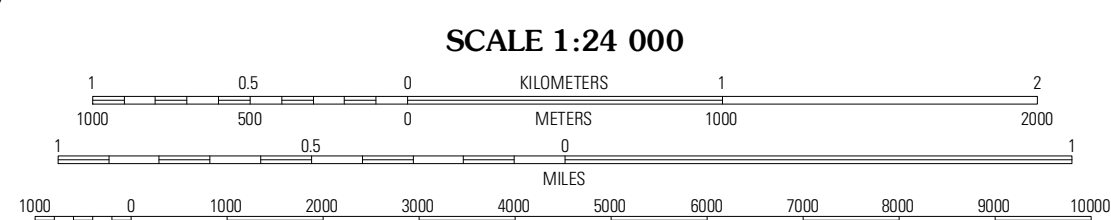
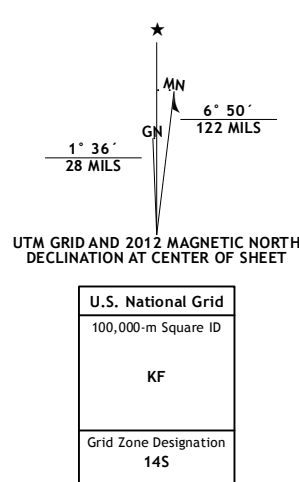

CONTOUR INTERVAL 10 FEET  
NORTH AMERICAN VERTICAL DATUM OF 1988  
This map was produced to conform with the  
National Geospatial Program US Topo Product Standard, 2011.  
A metadata file associated with this product is draft version 0.6.6



QUADRANGLE LOCATION

Texhoma NE	Goodwell NW	Goodwell NE
Texhoma North	Goodwell	Goodwell SE
Texhoma South	Frisco Creek West	Frisco Creek East

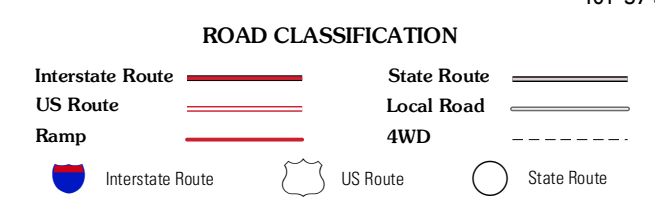

GOODWELL, OK  
2012

ADJOINING 7.5' QUADRANGLES