

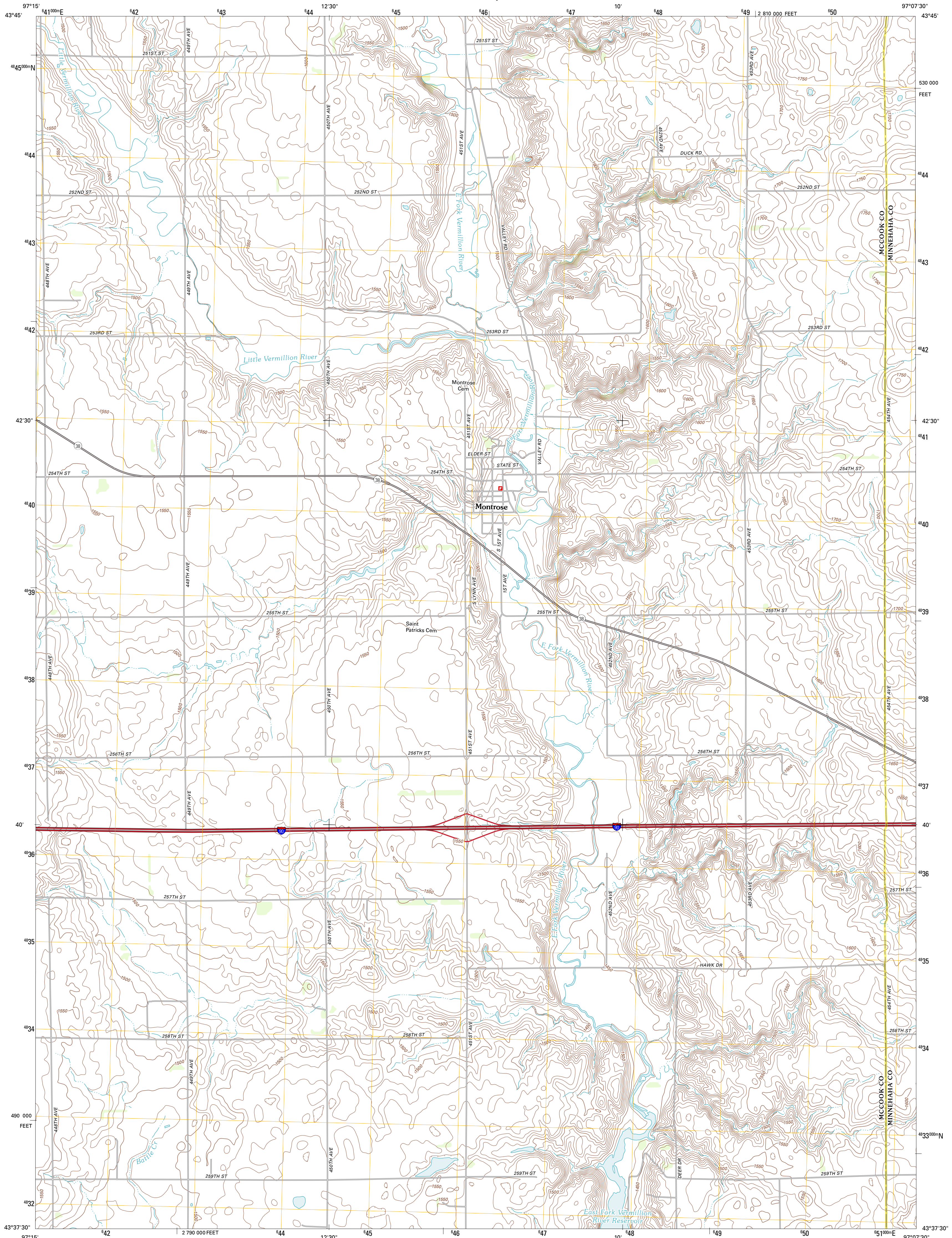

U.S. DEPARTMENT OF THE INTERIOR
U. S. GEOLOGICAL SURVEY



MONTROSE QUADRANGLE
SOUTH DAKOTA
7.5-MINUTE SERIES



Produced by the United States Geological Survey
North American Datum of 1983 (NAD83)
World Geodetic System of 1984 (WGS84). Projection and
1 000-meter grid: Universal Transverse Mercator, Zone 14T
10 000-foot ticks: South Dakota Coordinate System of 1983
(south zone)

Imagery.....N.A.I.P., August 2010
Roads.....©2006-2011 TomTom
Names.....GNS, 2011
Hydrography.....National Hydrography Dataset, 2010
Contours.....National Elevation Dataset, 1999
Boundaries.....Census, IBWC, IBC, USGS, 1972 - 2010

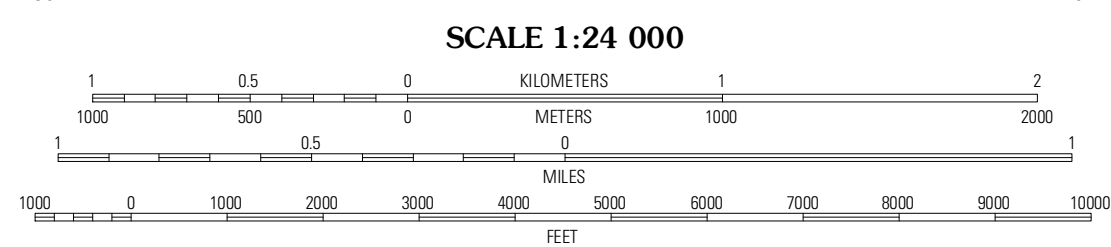
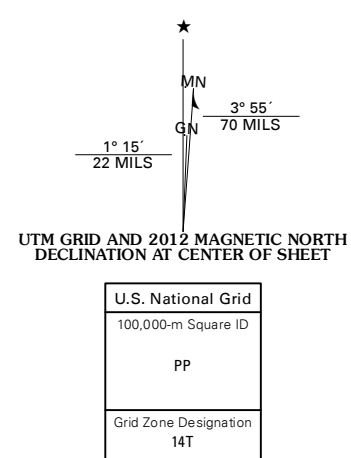

CONTOUR INTERVAL 10 FEET
NORTH AMERICAN VERTICAL DATUM OF 1988
This map was produced to conform with the
National Geospatial Program US Topo Product Standard, 2011.
A metadata file associated with this product is draft version 0.6.3

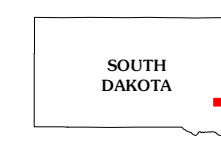

QUADRANGLE LOCATION

Wahpet	Lake	Buffalo
SE	Madison	Trading
		Post
Salem	Montrose	Humboldt
NE		
Canistota	East	Grass
	Vermillion	Lake
	Lake	

ADJOINING 7.5 QUADRANGLES

ROAD CLASSIFICATION
 Interstate Route (thick red line)
 US Route (red line)
 Ramp (red line with blue arrow)
 State Route (thin grey line)
 Local Road (dashed grey line)
 4WD (dashed grey line with cross-ticks)
 US Route (circle with number)
 State Route (circle with number)

MONTROSE, SD
2012