

Produced by the United States Geological Survey

North American Datum of 1983 (NAD83) World Geodetic System of 1984 (WGS84) Projection and 1 000-meter grid/Universal Transverse Mercator, Zone 16S. This map is not a legal document. Boundaries may be generalized for this map scale. Private lands within government reservations may not be shown. Obtain permission before entering private lands.

Imagery: N.A.I.P., June 2016 - October 2016 U.S. Census Bureau, 2016 Names: GNS, 1980 - 2022 Hydrography: National Hydrography Dataset, 2004 - 2022 Contours: National Elevation Dataset, 2022 Boundaries: Multiple sources; see metadata file 2019 - 2021 Wetlands: FWS National Wetlands Inventory 1980

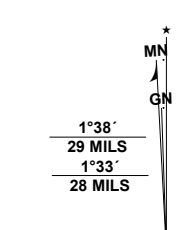

UTM GRID AND 2019 MAGNETIC NORTH DECLINATION AT CENTER OF SHEET

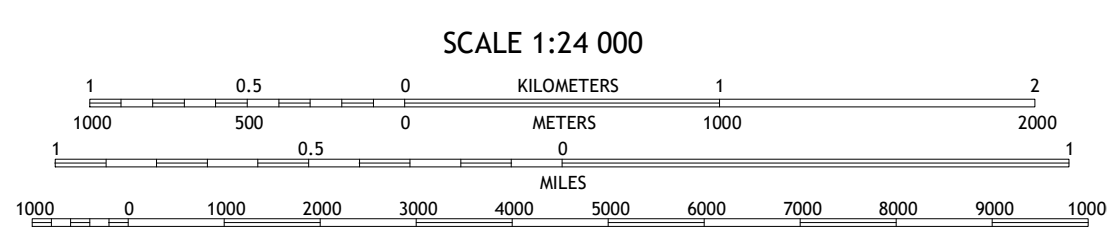

SCALE 1:24 000 CONTOUR INTERVAL 10 FEET NORTH AMERICAN VERTICAL DATUM OF 1988

This map was produced to conform with the National Geospatial Program US Topo Product Standard.



Table with 3 columns and 3 rows showing adjacent quadrangles: 1 Ellendale, 2 Eads, 3 Oakland, 4 Germantown, 5 Rossville, 6 Olive Branch, 7 Bynahia NW, 8 Mount Pleasant.

ROAD CLASSIFICATION table with columns for Expressway, Secondary Hwy, Ramp, Interstate Route, Local Connector, Local Road, 4WD, US Route, and State Route.

