

Produced by the United States Geological Survey

North American Datum of 1983 (NAD83), Projection and 1 000-meter grid; Universal Transverse Mercator, Zone 14R. This map is not a legal document. Boundaries may be generalized for this map scale. Private lands within government reservations may not be shown. Obtain permission before entering private lands.

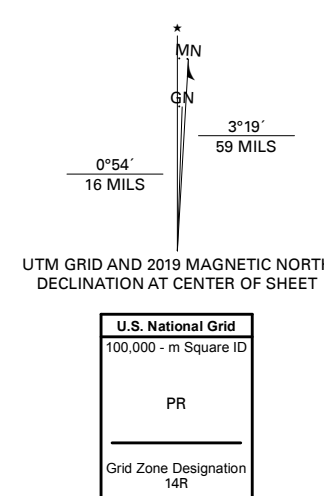

CONTOUR INTERVAL 5 FEET NORTH AMERICAN VERTICAL DATUM OF 1988. This map was produced to conform with the National Geospatial Program US Topo Product Standard, 2011. A metadata file associated with this product is draft version 0.6.18

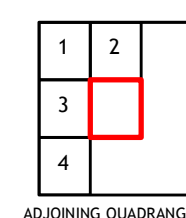

1 Port Ingleside 2 Port Aransas 3 Crane Islands NW 4 Crane Islands SW



CRANE ISLANDS NW OE E, TX

2019

