

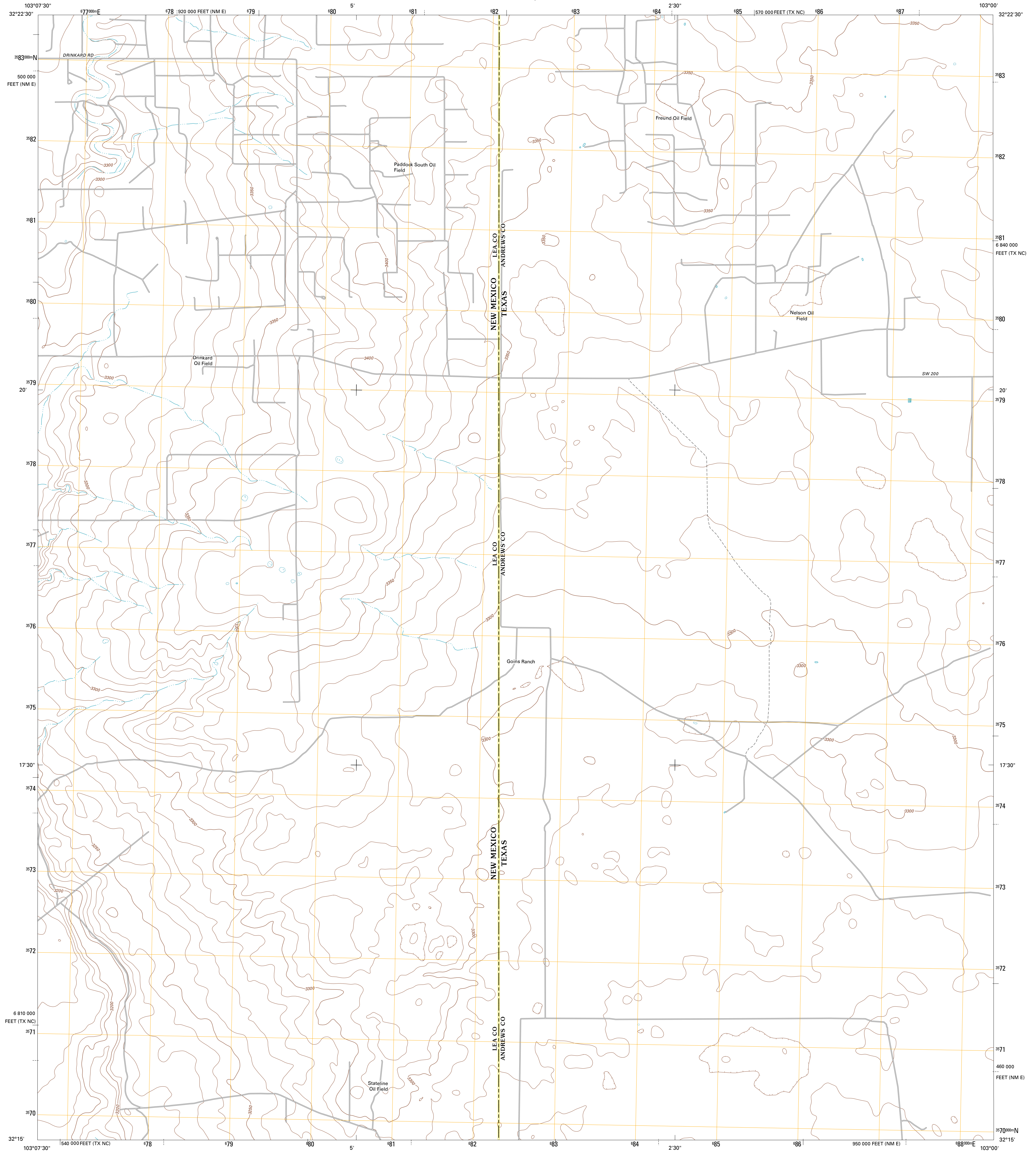

U.S. DEPARTMENT OF THE INTERIOR  
U. S. GEOLOGICAL SURVEY



EUNICE SE QUADRANGLE  
TEXAS-NEW MEXICO  
7.5-MINUTE SERIES



Produced by the United States Geological Survey  
North American Datum of 1983 (NAD83)  
World Geodetic System of 1984 (WGS84). Projection and  
1 000-meter grid: Universal Transverse Mercator, Zone 13S  
10 000-foot ticks: Texas Coordinate System of 1983 (north  
central zone), New Mexico Coordinate System of 1983 (east  
zone)

Imagery.....NAIP, August 2010 - May 2011  
Roads.....©2006-2012 TomTom  
Names.....GNIS, 2012  
Hydrography.....National Hydrography Dataset, 2010  
Contours.....National Elevation Dataset, 2002  
Boundaries.....IBWC, B.C. USGS, 1972 - 2012  
Public Land Survey System.....BLM, 2006 - 2008

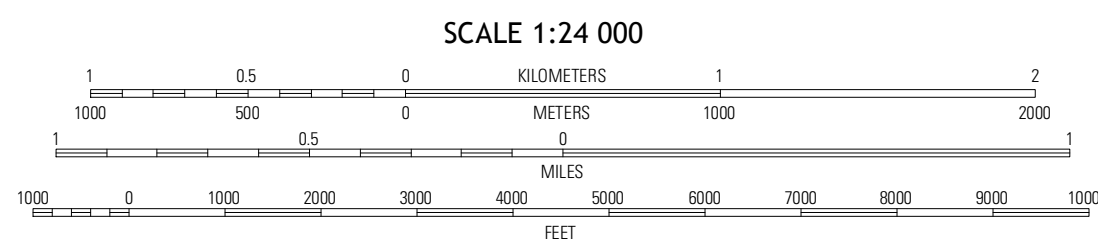
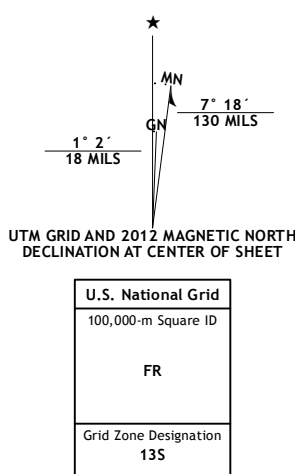

CONTOUR INTERVAL 10 FEET  
NORTH AMERICAN VERTICAL DATUM OF 1988  
This map was produced to conform with the  
National Geospatial Program US Topo Product Standard, 2011.  
A metadata file associated with this product is draft version 0.6.7



QUADRANGLE LOCATION

Eunice	Eunice NE	Jumbo Hill
Rattlesnake Canyon	Eunice SE	Frankel City SW
Jal NW	Jal NE	Figure Seven Ranch

ADJOINING 7.5' QUADRANGLES

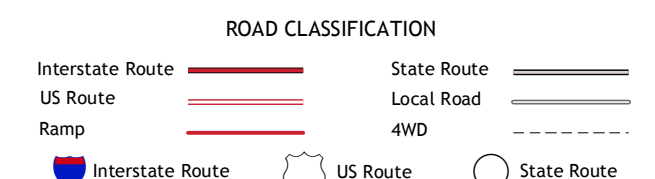

EUNICE SE, TX-NM  
2012