

Produced by the United States Geological Survey  
North American Datum of 1983 (NAD83)  
World Geodetic System of 1984 (WGS84) Projection and  
1 000-meter grid: Universal Transverse Mercator, Zone 14R  
10 000-foot ticks: Texas Coordinate System of 1983 (south zone)

Imagery .....NAIP, April 2010  
Roads .....©2006-2012 TomTom  
Names .....GNIS, 2012  
Hydrography .....National Hydrography Dataset, 2010  
Contours .....National Elevation Dataset, 2005  
Boundaries .....Census, IBWC, IBC, USGS, 1972 - 2012

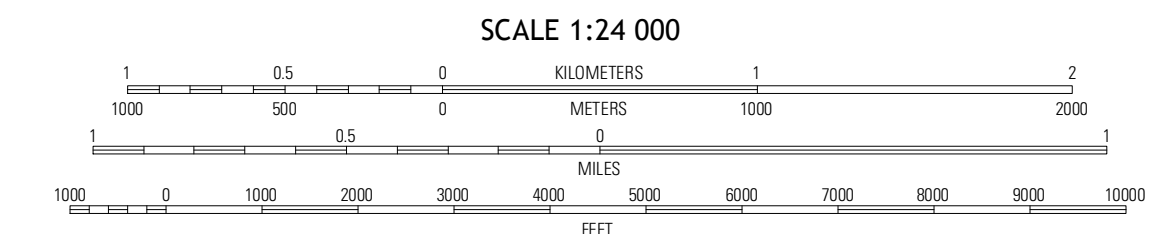

CONTOUR INTERVAL 10 FEET  
NORTH AMERICAN VERTICAL DATUM OF 1988  
This map was produced to conform with the  
National Geospatial Program US Topo Product Standard, 2011.  
A metadata file associated with this product is draft version 0.6.7

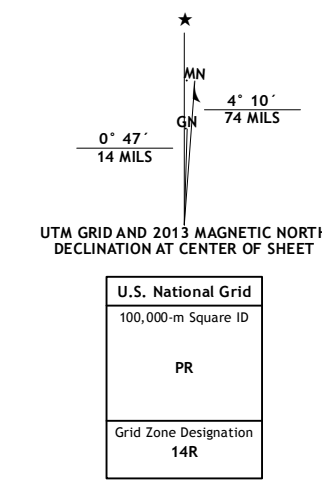
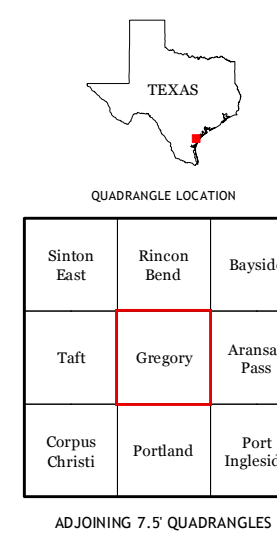

**ROAD CLASSIFICATION**

Interstate Route	State Route
US Route	Local Road
Ramp	4WD
Interstate Route	US Route
	State Route

**GREGORY, TX**  
2013

ADJOINING 7.5 QUADRANGLES

Sinhon East	Rincon Bend	Bayside
Taft	Gregory	Aransas Pass
Corpus Christi	Portland	Port Ingleside