

Produced by the United States Geological Survey North American Datum of 1983 (NAD83) World Geodetic System of 1984 (WGS84), Projection and 1 000-meter grid: Universal Transverse Mercator, Zone 14R 10 000-foot ticks: Texas Coordinate System of 1983 (south central zone)

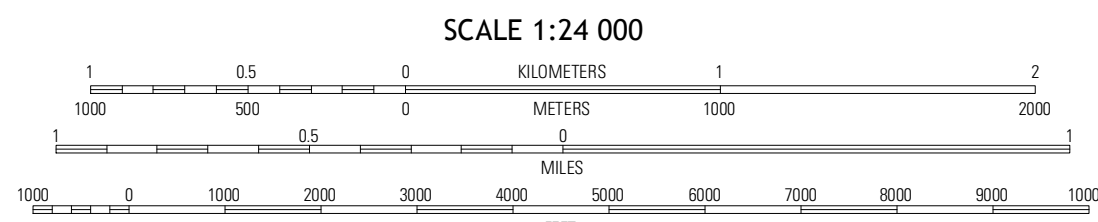

CONTOUR INTERVAL 10 FEET NORTH AMERICAN VERTICAL DATUM OF 1988 This map was produced to conform with the National Geospatial Program US Topo Product Standard, 2011. A metadata file associated with this product is draft version 0.6.7

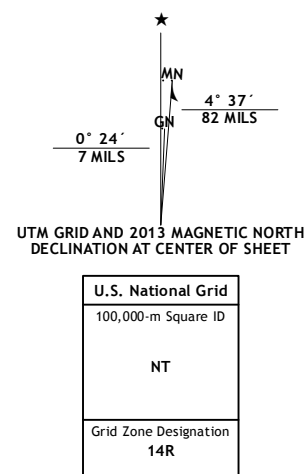

Table with 3 columns: Martine, Saint Hedwig, New Berlin, Elmendorf, La Vernia SW, La Vernia, Sasparico, Floresville, Marcellus Hills

ROAD CLASSIFICATION table with symbols for Interstate Route, US Route, Ramp, State Route, Local Road, and 4WD.