

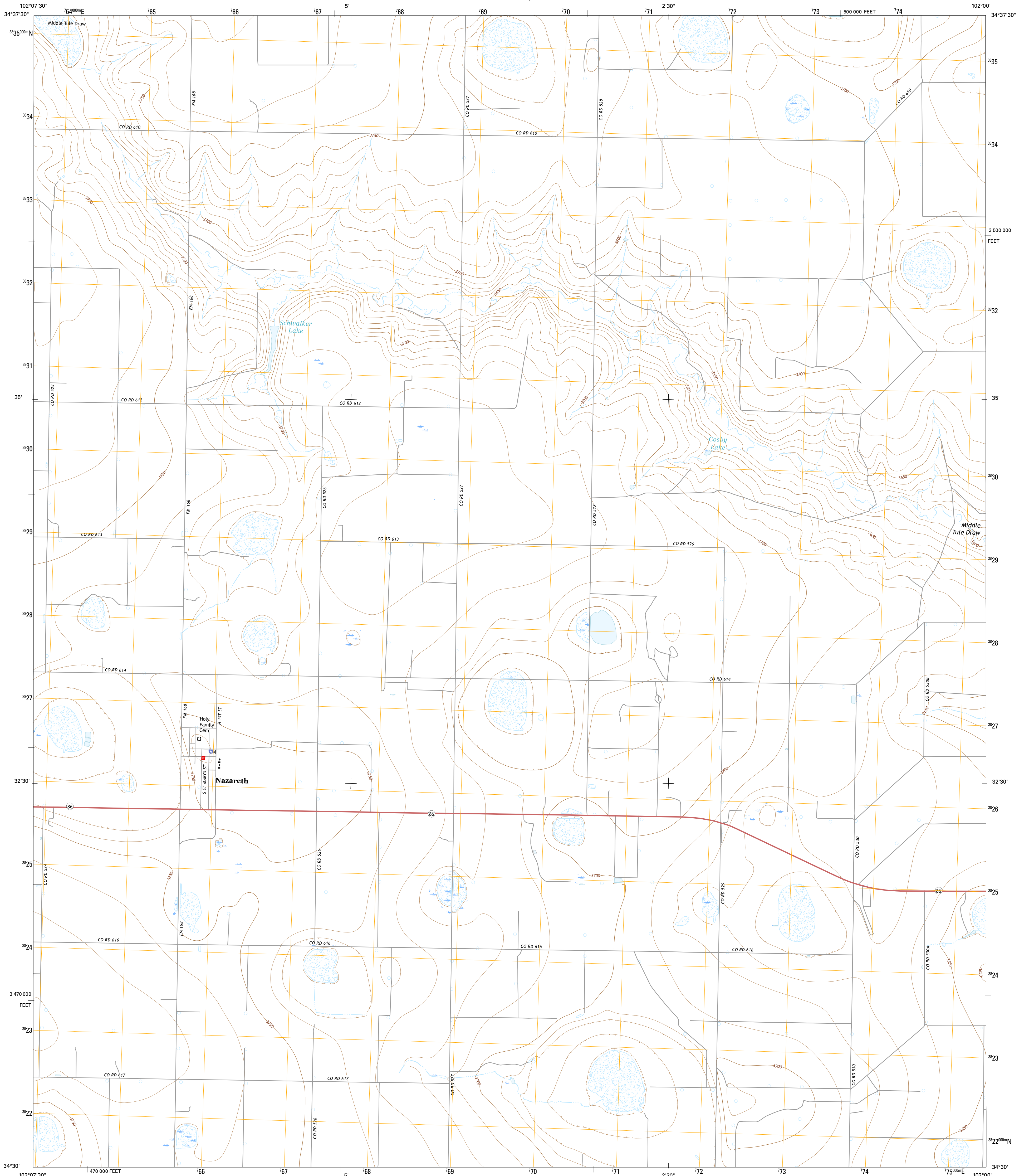

U.S. DEPARTMENT OF THE INTERIOR
U.S. GEOLOGICAL SURVEY



NAZARETH QUADRANGLE
TEXAS-CASTRO CO.
7.5-MINUTE SERIES



Produced by the United States Geological Survey
North American Datum of 1983 (NAD83)
World Geodetic System of 1984 (WGS84), Projection and
1 000-meter grid; Universal Transverse Mercator, Zone 13S
10 000-foot ticks; Texas Coordinate System of 1983 (north zone)
This map is not a legal document. Boundaries may be
generalized for this map scale. Private lands within government
reservations may not be shown. Obtain permission before
entering private lands.
Imagery.....NAIP, October 2014
Roads.....U.S. Census Bureau, 2014 - 2015
Names.....GNIS, 2015
Hydrography.....National Hydrography Dataset, 2014
Contours.....National Elevation Dataset, 2007
Boundaries.....Multiple sources; see metadata file 1972 - 2015
Wetlands.....FWS National Wetlands Inventory 1977 - 2014

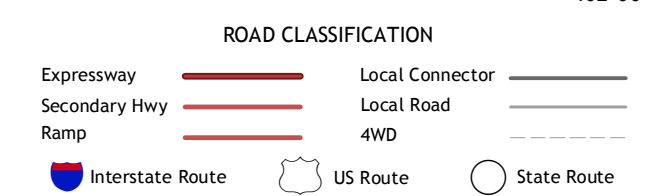
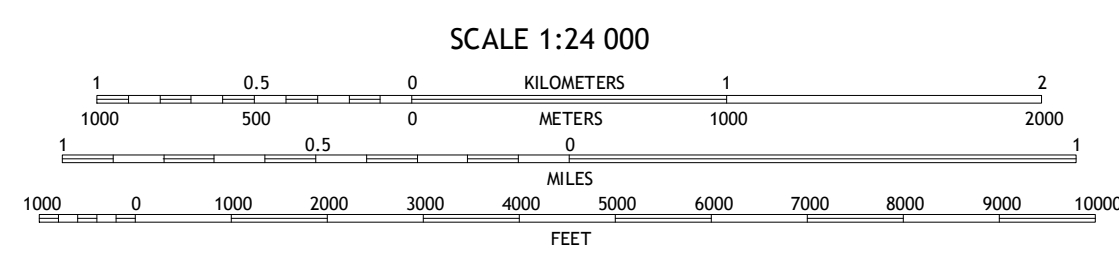
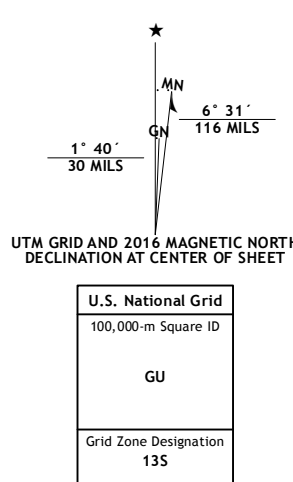

| | | | |
|----|----|----|------------------------|
| 1 | 2 | 3 | 1 Nazareth NW |
| 4 | 5 | 6 | 2 Arney |
| 7 | 8 | 9 | 3 Tutin NW |
| 10 | 11 | 12 | 4 Nazareth SW |
| 13 | 14 | 15 | 5 Lakeview |
| 16 | 17 | 18 | 6 Hart NW |
| 19 | 20 | 21 | 7 Hart |
| 22 | 23 | 24 | 8 Center Plains School |

NAZARETH, TX
2016

