

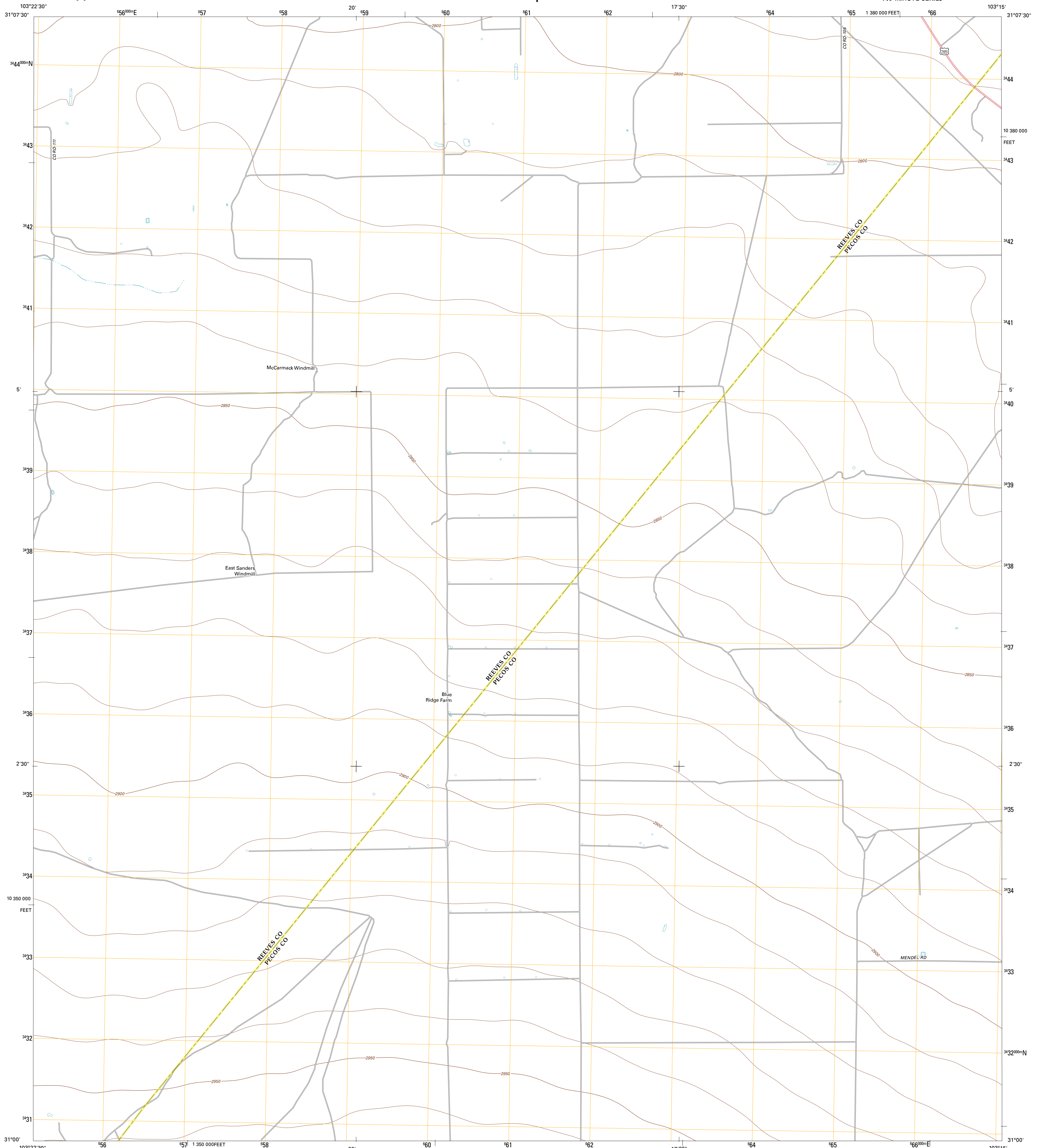

U.S. DEPARTMENT OF THE INTERIOR
U. S. GEOLOGICAL SURVEY



NORTH OF TUCKER HILL QUADRANGLE
TEXAS
7.5-MINUTE SERIES



Produced by the United States Geological Survey
North American Datum of 1983 (NAD83)
World Geodetic System of 1984 (WGS84). Projection and
1,000-meter grid: Universal Transverse Mercator, Zone 13R
10,000-foot ticks: Texas Coordinate System of 1983 (central
zone)

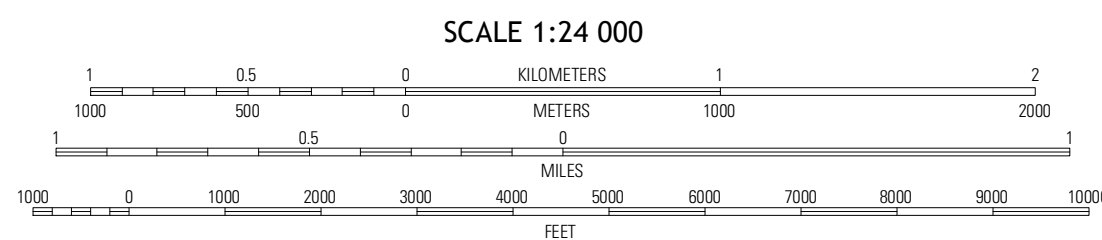
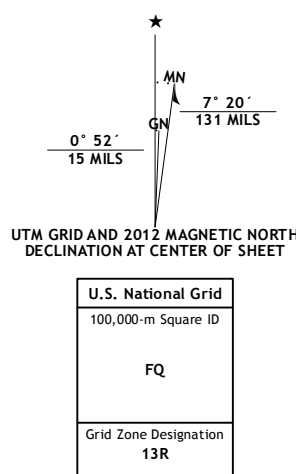

CONTOUR INTERVAL 10 FEET
NORTH AMERICAN VERTICAL DATUM OF 1988
This map was produced to conform with the
National Geospatial Program US Topo Product Standard, 2011.
A metadata file associated with this product is draft version 0.6.7



QUADRANGLE LOCATION

Barrilla Draw North	East of Barrilla Draw North	Coyanosa NW
Barrilla Draw South	North of Tucker Hill	Coyanosa SW
Deep Well Ranch NW	Tucker Hill	Belding NW

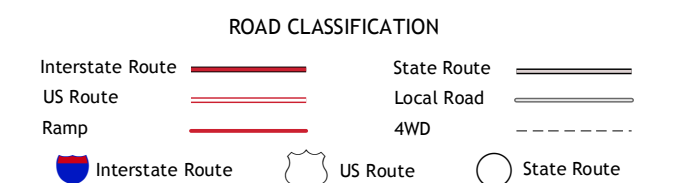

NORTH OF TUCKER HILL, TX
2012