

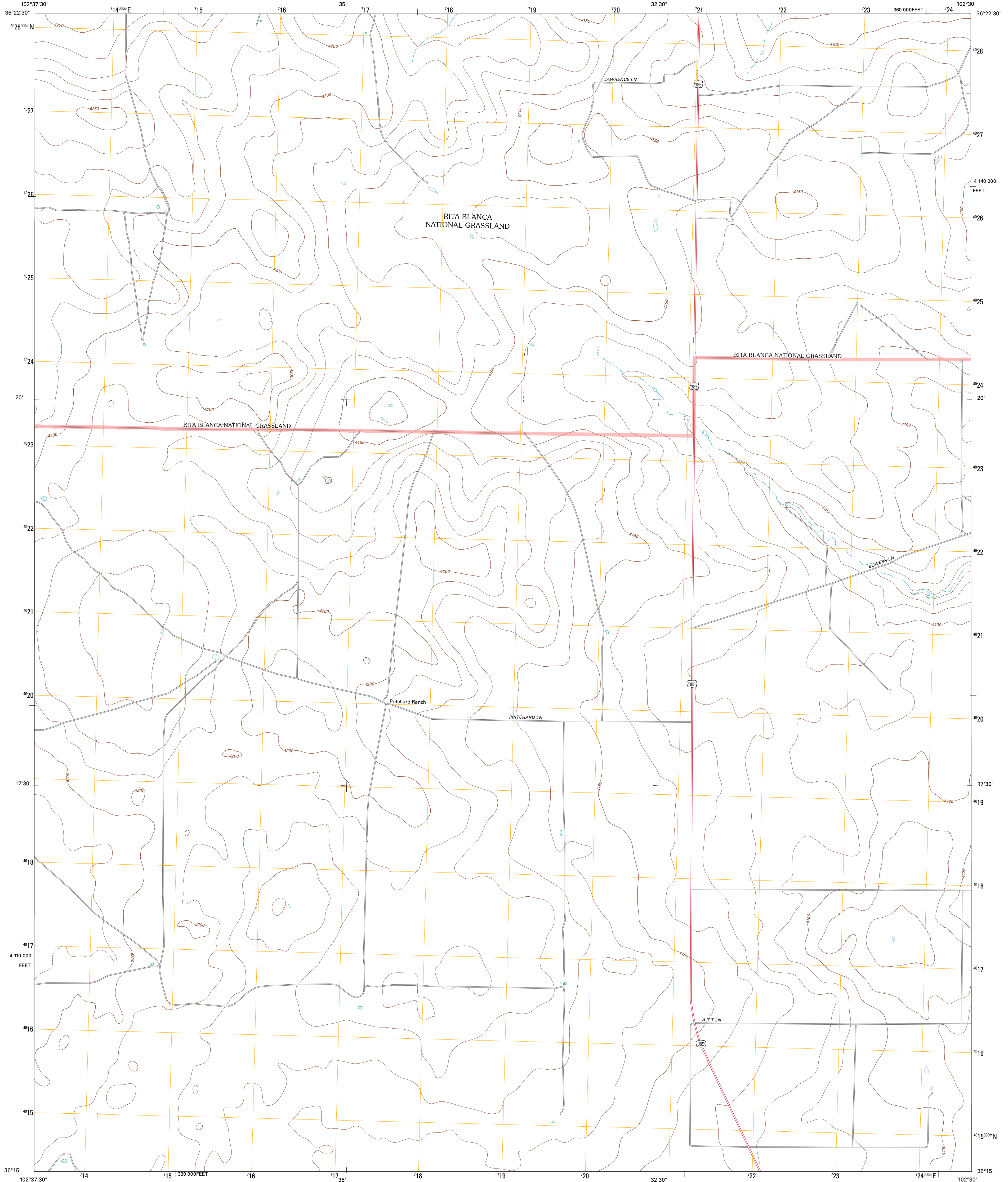

U.S. DEPARTMENT OF THE INTERIOR  
U. S. GEOLOGICAL SURVEY



PRITCHARD RANCH QUADRANGLE  
TEXAS-DALLAM CO.  
7.5-MINUTE SERIES



Produced by the United States Geological Survey  
North American Datum of 1983 (NAD83)  
World Geodetic System of 1984 (WGS84). Projection and  
1 000-meter grid: Universal Transverse Mercator, Zone 13S  
10 000-foot ticks: Texas Coordinate System of 1983 (north zone)

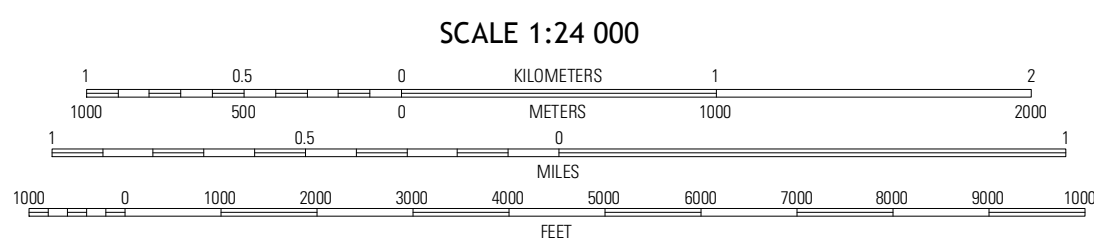
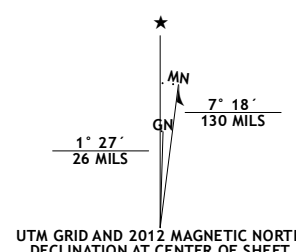

QUADRANGLE LOCATION

Collamer West	Collamer East	North of Red Cow Draw
Turrea Ranch	Pritchard Ranch	Red Cow Draw
Bolin	Bolin NE	Chamberlin

ROAD CLASSIFICATION

Interstate Route	State Route
US Route	Local Road
Ramp	4WD
Interstate Route	US Route
FS Primary Route	FS Passenger Route
	FS High Clearance Route

Check with local Forest Service unit for current travel conditions and restrictions.

PRITCHARD RANCH, TX  
2012

Imagery.....N.A.I.P., August 2010  
Roads.....2006-2012 TomTom  
Roads within US Forest Service Lands.....FS Topo Data with limited Forest Service updates, 2012  
Names.....GNIS, 2012  
Hydrography.....National Hydrography Dataset, 2010  
Contours.....National Elevation Dataset, 2002  
Boundaries.....Census, IBWC, IBC, USGS, 1972 - 2012

CONTOUR INTERVAL 10 FEET  
NORTH AMERICAN VERTICAL DATUM OF 1988

This map was produced to conform with the National Geospatial Program US Topo Product Standard, 2011. A metadata file associated with this product is draft version 0.6.7

ADJOINING 7.5' QUADRANGLES