

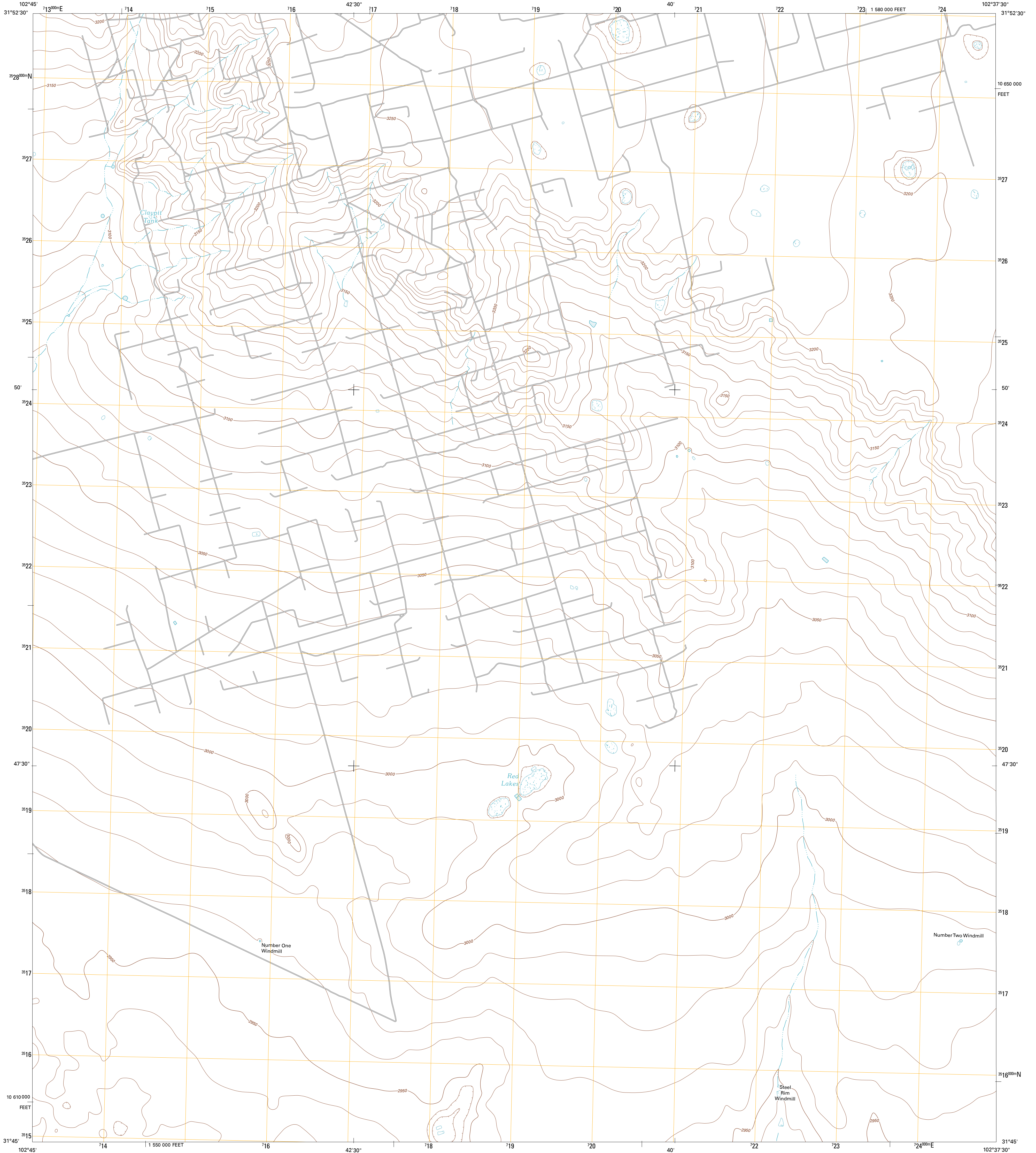

U.S. DEPARTMENT OF THE INTERIOR
U. S. GEOLOGICAL SURVEY



RED LAKES QUADRANGLE
TEXAS-ECTOR CO.
7.5-MINUTE SERIES



Produced by the United States Geological Survey
North American Datum of 1983 (NAD83)
World Geodetic System of 1984 (WGS84). Projection and
1,000-meter grid: Universal Transverse Mercator, Zone 13R.
10,000-foot ticks: Texas Coordinate System of 1983 (central
zone)

Imagery.....NAIP, August 2010
Roads.....©2006-2012 TomTom
Names.....GNIS, 2012
Hydrography.....National Hydrography Dataset, 2010
Contours.....National Elevation Dataset, 2008
Boundaries.....Census, IBWC, IBC, USGS, 1972 - 2012

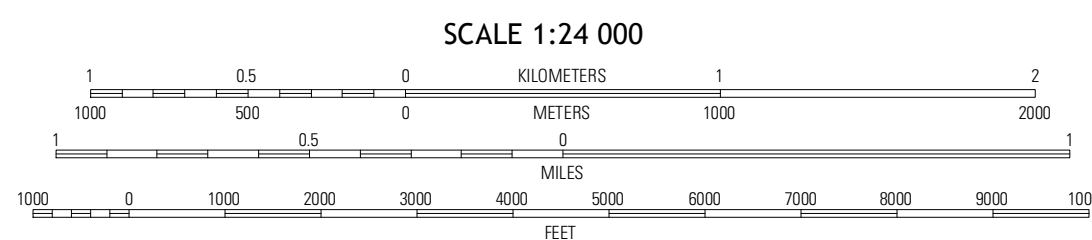
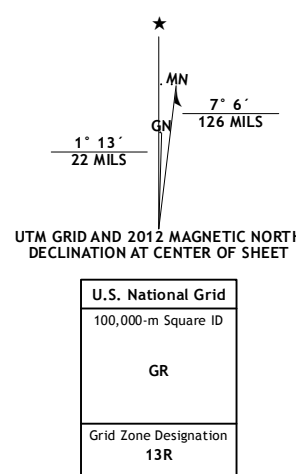

SCALE 1:24 000
CONTOUR INTERVAL 10 FEET
NORTH AMERICAN VERTICAL DATUM OF 1988
This map was produced to conform with the
National Geospatial Program US Topo Product Standard, 2011.
A metadata file associated with this product is draft version 0.6.7

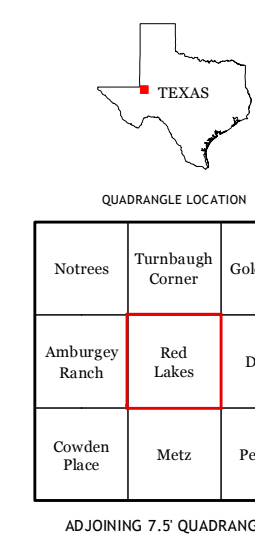

ROAD CLASSIFICATION
Interstate Route (thick red line)
US Route (red line)
Ramp (red line with blue triangle)
State Route (thin grey line)
Local Road (grey line)
4WD (dashed grey line)
Windmill (circle with cross)

QUADRANGLE LOCATION

Notrees	Turnbaugh Corner	Goldsmith
Amberg Ranch	Red Lakes	Doum
Cowden Place	Metz	Penwell

ADJOINING 7.5 QUADRANGLES

RED LAKES, TX
2012