

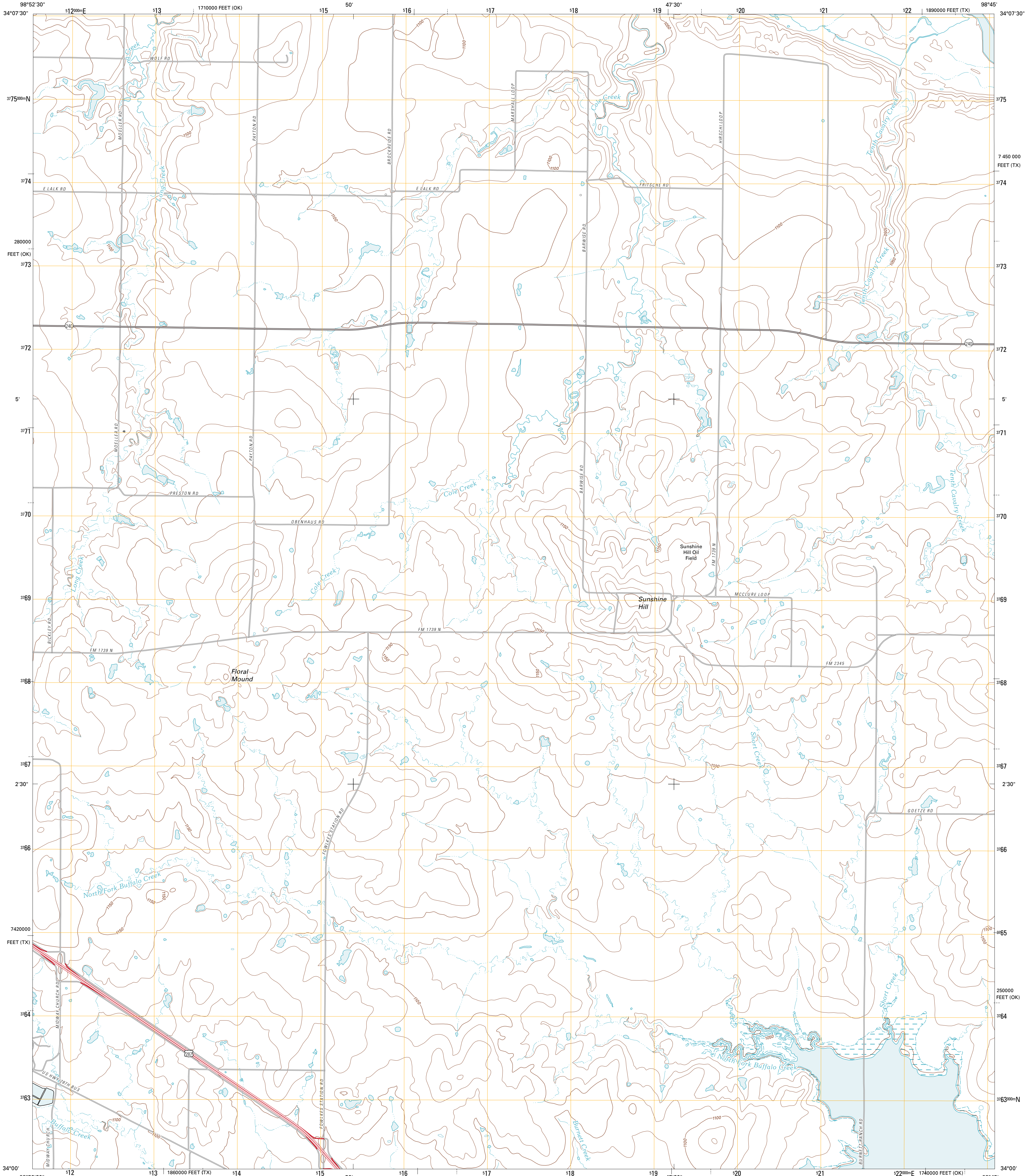

U.S. DEPARTMENT OF THE INTERIOR
U. S. GEOLOGICAL SURVEY



SUNSHINE HILL QUADRANGLE
TEXAS-OKLAHOMA
7.5-MINUTE SERIES



Produced by the United States Geological Survey
North American Datum of 1983 (NAD83)
World Geodetic System of 1984 (WGS84). Projection and
10 000-foot ticks: Texas Coordinate System of 1983 (north
central zone), Oklahoma Coordinate System of 1983 (south
zone)

Imagery: NADP, July 2008
Roads: ©2006-2010 Tele Atlas
Names: GNSI, 2010
Hydrography: National Hydrography Dataset, 2008
Contours: National Elevation Dataset, 2005

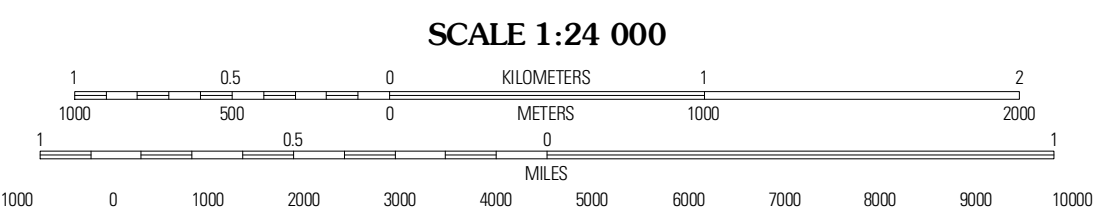
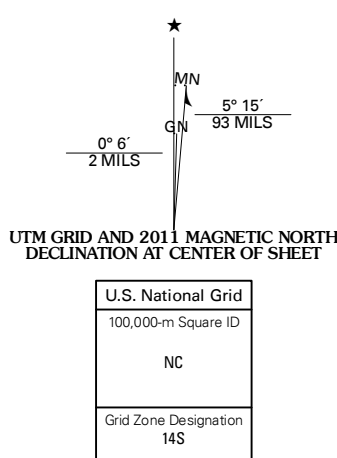

CONTOUR INTERVAL 10 FEET
NORTH AMERICAN VERTICAL DATUM OF 1988
This map was produced to conform with version 0.5.10 of the
draft USGS Standards for 7.5-Minute Quadrangle Maps.
A metadata file associated with this product is draft version 0.5.11



QUADRANGLE LOCATION

Cowboy Springs	Angar Creek	Grandfield
Electra	Sunshine Hill	Clann
Beaver Creek	FoxBee	Iowa Park

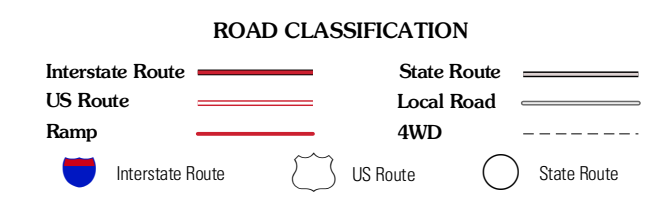

SUNSHINE HILL, TX-OK
2011