

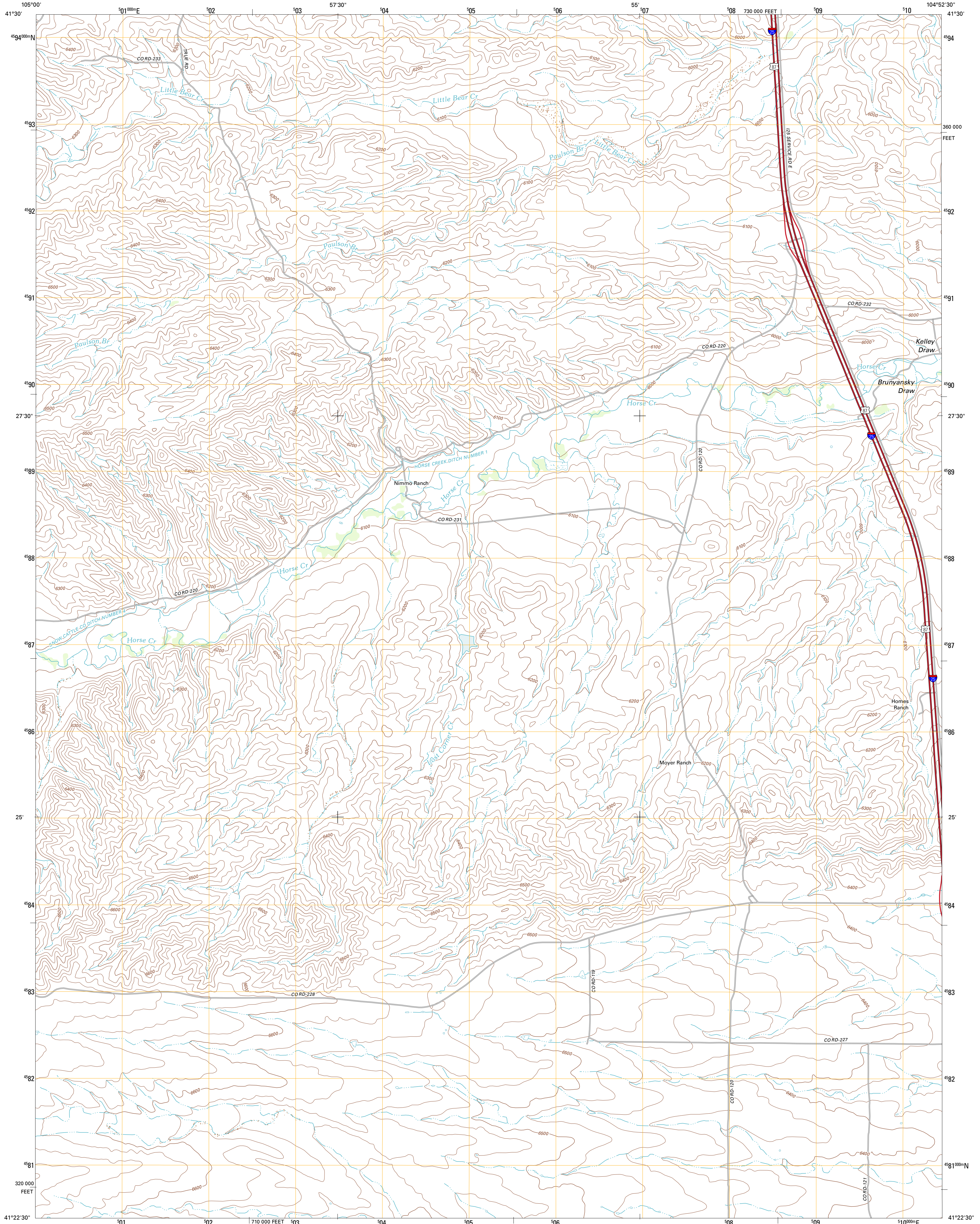

U.S. DEPARTMENT OF THE INTERIOR
U. S. GEOLOGICAL SURVEY



NIMMO RANCH QUADRANGLE
WYOMING-LARAMIE CO.
7.5-MINUTE SERIES



Produced by the United States Geological Survey
North American Datum of 1983 (NAD83)
World Geodetic System of 1984 (WGS84). Projection and
1 000-meter grid: Universal Transverse Mercator, Zone 13T
10 000-foot ticks: Wyoming Coordinate System of 1983 (east zone)

Imagery: NAIP, August 2009
Roads: 2006-2011 TomTom
Names: GNIS, 2011
Hydrography: National Hydrography Dataset, 2009
Contours: National Elevation Dataset, 2007
Boundaries: Census, BWC, IBC, USGS, 1972 - 2010
Public Land Survey System: BLM, 2006 - 2008

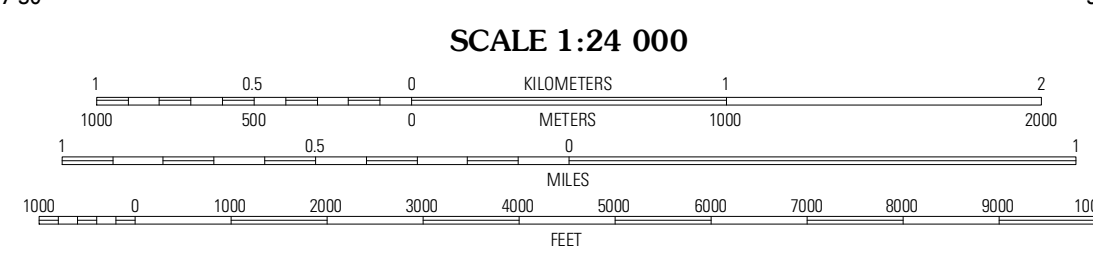
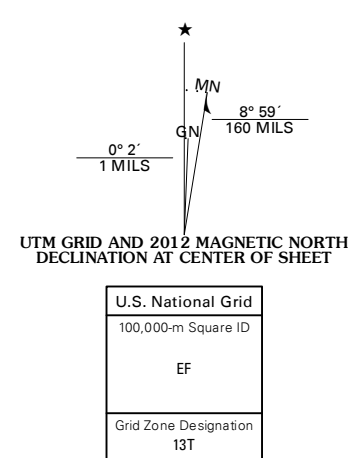

CONTOUR INTERVAL 20 FEET
NORTH AMERICAN VERTICAL DATUM OF 1988
This map was produced to conform with the
National Geospatial Program US Topo Product Standard, 2011.
A metadata file associated with this product is draft version 0.6.3

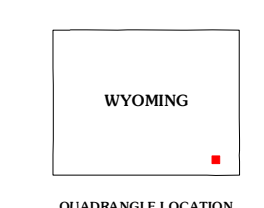

QUADRANGLE LOCATION

Hinck Ranch	Bristol Ridge	Moffett Ranch
Dreemer Ranch	Nimmo Ranch	Lewis Ranch
Federal	Farthing Ranch	P O Ranch

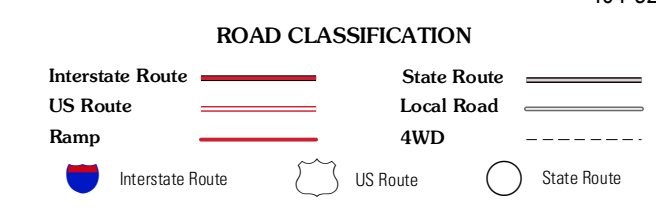

NIMMO RANCH, WY
2012

ADJOINING 7.5' QUADRANGLES